

# Cable fittings and accessories

## Metal fitting TOP-T

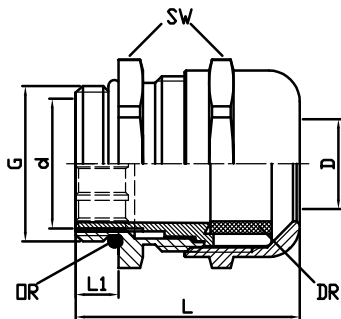

### Properties

- Cable fitting with hexagon base
- Strain relief
- Gasket and O-Ring

### Technical data

Protection class IP 68 to 5 bar

### Design

- Material Brass nickel-plated
- Sealing ring (DR) Neoprene
- O-Ring (OR) Perbunan®

Part-No.	Type	G	Clamping range D mm	SW = across flats mm	L 1 mm	weight approx. kg/100 piece	VE piece
<b>TOP-T metric</b>							
600701	TOP-T M 12 × 1.5	M 12	3.0 – 6.5	14	5.0	1.12	100
600760	TOP-T M 16 × 1.5	M 16	5.5 – 10.0	17	5.5	1.46	100
600761	TOP-T M 20 × 1.5	M 20	8.0 – 13.0	22	6.0	2.63	50
600762	TOP-T M 25 × 1.5	M 25	11.0 – 18.0	30	7.0	5.43	25
600763	TOP-T M 32 × 1.5	M 32	15.0 – 21.0	34	8.0	7.12	10
600702	TOP-T M 40 × 1.5	M 40	19.0 – 27.0	44	8.0	15.90	10
600703	TOP-T M 50 × 1.5	M 50	26.0 – 35.0	55	9.0	27.21	5
600704	TOP-T M 63 × 1.5	M 63	39.0 – 48.0	66	10.0	31.78	5
<b>TOP-T PG</b>							
600710	TOP-T PG 7	PG 7	3.0 – 6.5	14	5.0	1.13	100
600711	TOP-T PG 9	PG 9	5.5 – 10.0	17	6.0	1.51	100
600712	TOP-T PG 11	PG 11	5.5 – 10.0	20	6.0	3.12	50
600713	TOP-T PG 13.5	PG 13,5	8.0 – 13.0	22	6.5	2.86	50
600714	TOP-T PG 16	PG 16	8.0 – 14.0	24	6.5	3.34	50
600715	TOP-T PG 21	PG 21	11.0 – 18.0	30	7.0	6.40	25
600716	TOP-T PG 29	PG 29	19.0 – 27.0	40	8.0	11.20	25
600717	TOP-T PG 36	PG 36	26.0 – 35.0	50	9.0	18.82	10
600718	TOP-T PG 42	PG 42	26.0 – 35.0	57	10.0	31.58	5
600719	TOP-T PG 48	PG 48	39.0 – 48.0	66	10.0	37.00	5

# Cable fittings and accessories

## Metal fitting TOP-TR

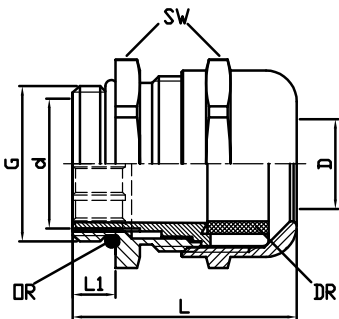

### Properties

- Cable fitting with hexagon base
- Strain relief
- Gasket and O-Ring
- With reduced sealing insert

### Technical data

Protection class IP 68 to 5 bar

### Design

- Material Brass nickel-plated
- Sealing ring (DR) Neoprene
- O-Ring (OR) Perbunan®

Part-No.	Type	G	Clamping range D mm	SW = across flats mm	L 1 mm	weight approx. kg/100 piece	VE piece
<b>TOP-TR metric</b>							
600705	TOP-TR M 12 × 1.5	M 12	2.0 – 5.0	14	5.0	1.07	100
600780	TOP-TR M 16 × 1.5	M 16	3.0 – 8.0	17	5.5	1.50	100
600781	TOP-TR M 20 × 1.5	M 20	6.0 – 12.0	22	6.0	2.73	50
600782	TOP-TR M 25 × 1.5	M 25	8.0 – 15.0	30	7.0	5.55	25
600783	TOP-TR M 32 × 1.5	M 32	13.0 – 19.0	34	8.0	7.40	10
600706	TOP-TR M 40 × 1.5	M 40	16.0 – 23.0	44	8.0	16.72	10
600707	TOP-TR M 50 × 1.5	M 50	21.0 – 29.0	55	9.0	27.95	5
600708	TOP-TR M 63 × 1.5	M 63	27.0 – 38.0	66	10.0	34.48	5
<b>TOP-TR PG</b>							
600730	TOP-TR PG 7	PG 7	2.0 – 5.0	14	5.0	1.15	100
600731	TOP-TR PG 9	PG 9	3.0 – 8.0	17	6.0	1.53	100
600732	TOP-TR PG 11	PG 11	3.0 – 8.0	20	6.0	3.20	50
600733	TOP-TR PG 13.5	PG 13,5	6.0 – 12.0	22	6.5	2.94	50
600734	TOP-TR PG 16	PG 16	6.0 – 12.0	24	6.5	3.42	50
600735	TOP-TR PG 21	PG 21	8.0 – 15.0	30	7.0	6.45	25
600736	TOP-TR PG 29	PG 29	12.0 – 18.0	40	8.0	11.50	25
600737	TOP-TR PG 36	PG 36	21.0 – 29.0	50	9.0	20.42	10
600738	TOP-TR PG 42	PG 42	21.0 – 29.0	57	10.0	32.38	5
600739	TOP-TR PG 48	PG 48	27.0 – 38.0	66	10.0	37.50	5

# Cable fittings and accessories

## Metal fittings TOP-M EExe

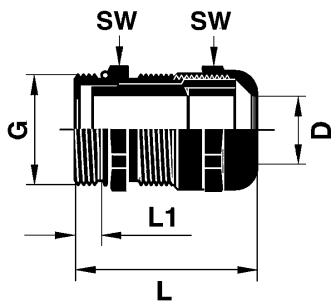

### Application

- For explosion risk areas

### Properties

- Ex cable fitting with hexagon base
- Strain relief and gasket

### Technical data

Protection class IP 68 to 5 bar

### Design

- Material Brass nickle-plated for explosion risk areas according to EN 50014
- Sealing ring (DR) Neoprene
- O-Ring (OR) Perbunan®

Part-No.	Type	G	Clamping range D mm	SW = across flats mm	L 1 mm	weight approx. kg/100 piece	VE piece
<b>TOP-M EExe metric</b>							
600920	TOP-M EExe M 12 × 1.5	M 12	3.0 – 6.5	14	5.0	1.20	100
600921	TOP-M EExe M 16 × 1.5	M 16	5.0 – 9.0	17	5.0	1.64	100
600922	TOP-M EExe M 20 × 1.5	M 20	6.0 – 12.0	22	6.0	3.14	100
600923	TOP-M EExe M 25 × 1.5	M 25	11.0 – 16.0	27	7.0	4.26	50
600924	TOP-M EExe M 32 × 1.5	M 32	14.0 – 21.0	34	8.0	7.16	25
600925	TOP-M EExe M 40 × 1.5	M 40	19.0 – 27.0	43	8.0	12.24	10
600926	TOP-M EExe M 50 × 1.5	M 50	24.0 – 35.0	55	9.0	22.70	5
600927	TOP-M EExe M 63 × 1.5	M 63	32.0 – 42.0	65	5.0	31.50	5
<b>TOP-M EExe PG</b>							
600910	TOP-M EExe PG 7	PG 7	3.0 – 6.5	14	5.0	1.17	100
600911	TOP-M EExe PG 9	PG 9	4.0 – 8.0	17	6.0	1.77	100
600912	TOP-M EExe PG 11	PG 11	5.0 – 10.0	20	6.0	2.45	50
600913	TOP-M EExe PG 13.5	PG 13,5	6.0 – 12.0	22	6.5	2.82	50
600914	TOP-M EExe PG 16	PG 16	10.0 – 14.0	24	6.5	3.14	50
600915	TOP-M EExe PG 21	PG 21	13.0 – 18.0	30	7.0	5.40	50
600916	TOP-M EExe PG 29	PG 29	18.0 – 25.0	40	8.0	9.85	25
600917	TOP-M EExe PG 36	PG 36	24.0 – 32.0	50	9.0	15.60	10
600918	TOP-M EExe PG 42	PG 42	30.0 – 38.0	57	10.0	20.70	5
600919	TOP-M EExe PG 48	PG 48	34.0 – 44.0	64	10.0	29.70	5

# Cable fittings and accessories

## Metal fittings WD

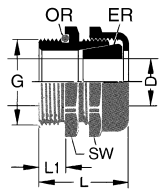

### Properties

- **Compact design**
- Compact fitting with hexagon base
- Strain relief
- Clamp ring and O-Ring

### Technical data

Protection class IP 68

### Design

- Material Brass nickel-plated
- Clamp ring (ER) Neoprene
- O-Ring (OR) Perbunan®

Part-No.	Type	G	Clamping range D mm	SW = across flats mm	L mm	L 1 mm	weight approx. kg/100 piece	VE piece
<b>WD metric</b>								
601050	WD M 12 × 1.5	M 12	3.5 – 6.0	17	20.0	6.0	1.50	100
601051	WD M 16 × 1.5	M 16	5.0 – 9.0	21	20.0	6.0	2.21	100
601052	WD M 20 × 1.5	M 20	9.0 – 13.0	24	26.0	6.5	3.40	100
601053	WD M 25 × 1.5	M 25	13.0 – 17.0	32	33.0	8.0	7.20	50
601054	WD M 32 × 1.5	M 32	16.0 – 23.0	40	38.0	8.0	12.80	25
601055	WD M 40 × 1.5	M 40	23.0 – 30.0	50	38.0	9.0	17.80	25
<b>WD PG</b>								
600100	WD PG 7	PG 7	4.0 – 6.0	17	20.0	6.0	1.48	100
600101	WD PG 9	PG 9	6.0 – 9.0	17	20.0	6.0	1.52	100
600102	WD PG 11	PG 11	7.0 – 12.0	21	23.0	6.5	2.32	100
600103	WD PG 13.5	PG 13,5	8.0 – 13.0	24	24.0	6.5	2.98	100
600104	WD PG 16	PG 16	10.0 – 15.0	24	26.0	6.5	3.36	100
600105	WD PG 21	PG 21	12.0 – 19.0	32	33.0	8.0	7.90	50
600106	WD PG 29	PG 29	16.0 – 27.0	40	38.0	8.0	12.28	25
600107	WD PG 36	PG 36	24.0 – 32.0	50	38.0	9.0	24.40	25

# Cable fittings and accessories

## Fittings for C-track cables RB

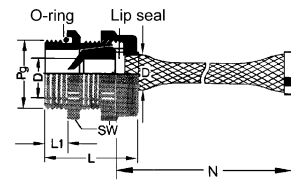

### Properties

- Cable fitting with hexagon base
- Strain relief through strain relief ferrule
- Seal and O-Ring
- With the Lütze-RB fittings and SUPERFLEX-cables the risk of a wire break on frequently moving machine parts is virtually eliminated
- **Application:** Slide the upper part of the RB fittings onto the control cable. Screw in the lower part of the RB fittings into the machine part or the enclosure and tighten. Subsequently remove the control cable jacket and strip the insulation and screw on the upper part of the RB fitting onto the lower part and tighten. Fix the outer end of the strain relief ferrule with a cable tie.

### Technical data

Protection class IP 65

### Design

- Material Brass nickel-plated
- Sealing ring (DR) Neoprene
- O-Ring (OR) Perbunan®
- Strain relief ferrule Stainless steel W No. 4301

Part-No.	Type	G	Clamping range D mm	SW = across flats mm	L mm	L 1 mm	N mm	weight approx. kg/100 piece	VE piece
<b>RB metric</b>									
600382	RB M 16	M 16	6.0 – 7.0	21	20.0	6.0	75.0	2.78	loose
600383	RB M 20	M 20	7.0 – 10.0	24	26.0	6.5	100.0	3.98	loose
600384	RB M 25	M 25	10.0 – 15.0	32	33.0	8.0	125.0	4.14	loose
600385	RB M 32	M 32	14.0 – 21.0	40	38.0	8.0	150.0	9.20	loose
600386	RB M 40	M 40	18.0 – 28.0	50	38.0	9.0	175.0	14.20	loose
<b>RB PG</b>									
600303	RB PG 13.5	PG 13,5	7.0 – 10.0	24	24.0	6.5	100.0	3.98	loose
600304	RB PG 16	PG 16	7.0 – 11.0	24	26.0	6.5	125.0	4.14	loose
600305	RB PG 21	PG 21	10.0 – 15.0	32	33.0	8.0	150.0	9.20	loose
600306	RB PG 29	PG 29	14.0 – 21.0	40	38.0	10.0	175.0	14.05	loose
600307	RB PG 36	PG 36	18.0 – 28.0	50	38.0	9.0	200.0	27.20	loose

# Cable fittings and accessories

## Metal fitting 6KM

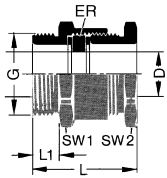

### Properties

- Fitting according to DIN 46320 with hexagon base and clamp ring.

### Technical data

Protection class IP 55

### Design

- Material Brass nickel-plated
- Clamp ring (ER) Neoprene

Part-No.	Type	G	Clamping range D mm	SW 1 = across flats mm	SW 2 = across flats mm	L mm	L 1 mm	weight approx. kg/100 piece	VE piece
<b>6KM metric</b>									
601080	6KM M 12 × 1.5	M 12	5.0 – 7.0	14	13	20.0	5.0	1.00	100
601081	6KM M 16 × 1.5	M 16	4.0 – 10.0	17	15	22.0	6.0	1.50	100
601082	6KM M 20 × 1.5	M 20	6.5 – 12.0	20	18	23.0	6.0	2.40	100
601083	6KM M 20 × 1.5	M 20	6.5 – 12.5	22	20	25.0	6.5	2.60	100
601084	6KM M 20 × 1.5	M 20	6.5 – 15.0	24	22	27.0	6.5	3.10	50
601085	6KM M 25 × 1.5	M 25	9.0 – 19.0	30	28	30.0	7.0	4.90	50
601086	6KM M 32 × 1.5	M 32	17.0 – 27.0	40	37	32.0	8.0	8.80	25
601087	6KM M 40 × 1.5	M 40	23.0 – 33.0	50	47	38.0	9.0	14.40	10
601088	6KM M 50 × 1.5	M 50	29.0 – 39.0	57	54	42.0	10.0	19.80	5
601089	6KM M 63 × 1.5	M 63	35.0 – 45.0	64	60	45.0	10.0	24.00	5
<b>6KM PG</b>									
600050	6KM PG 7	PG 7	4.0 – 6.0	14	13	20.0	5.0	0.82	100
600051	6KM PG 9	PG 9	8.0 – 10.0	17	15	22.0	6.0	1.30	100
600052	6KM PG 11	PG 11	8.0 – 10.0	20	18	23.0	6.0	1.91	100
600053	6KM PG 13.5	PG 13,5	10.0 – 12.0	22	20	25.0	6.5	2.60	100
600054	6KM PG 16	PG 16	8.0 – 14.0	24	22	27.0	6.5	2.96	50
600055	6KM PG 21	PG 21	17.0 – 19.0	30	28	30.0	7.0	4.64	50
600056	6KM PG 29	PG 29	26.0 – 28.0	40	37	32.0	8.0	8.80	25
600057	6KM PG 36	PG 36	33.0 – 35.0	50	47	38.0	9.0	13.40	10
600058	6KM PG 42	PG 42	39.0 – 41.0	57	54	42.0	10.0	18.90	5
600059	6KM PG 48	PG 48	43.0 – 45.0	64	60	45.0	10.0	23.48	5

# Cable fittings and accessories

## Metal fittings ZEV

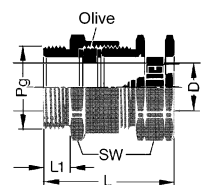

### Properties

- Fitting according to DIN 46320 with hexagon base and clamp ring
- Clamping buckle included as loose part

### Technical data

Protection class IP 55

### Design

- Material Brass nickel-plated
- Clamp ring (ER) Neoprene

Part-No.	Type	G	Clamping range D mm	SW = across flats mm	L mm	L 1 mm	weight approx. kg/100 piece	VE piece
<b>ZEV metric</b>								
600020	ZEV M 16	M 16	6.0 – 10.0	17	28.0	5.5	2.70	50
600021	ZEV M 20	M 20	10.0 – 15.0	24	32.0	6.5	5.00	50
600022	ZEV M 25	M 25	13.0 – 20.0	30	35.0	7.0	7.50	25
600023	ZEV M 32	M 32	18.0 – 27.0	40	38.0	8.5	14.96	25
<b>ZEV PG</b>								
600001	ZEV PG 9	PG 9	6.0 – 9.0	17	28.0	5.5	2.50	50
600002	ZEV PG 11	PG 11	8.0 – 12.0	20	30.0	6.0	3.64	50
600003	ZEV PG 13.5	PG 13,5	10.0 – 14.0	22	31.0	6.5	4.40	50
600004	ZEV PG 16	PG 16	10.0 – 16.0	24	32.0	6.5	5.13	50
600005	ZEV PG21	PG 21	14.0 – 21.0	30	35.0	7.0	7.70	25
600006	ZEV PG 29	PG 29	20.0 – 30.0	40	38.0	8.5	14.44	25

# Cable fittings and accessories

## Metal fittings ZED

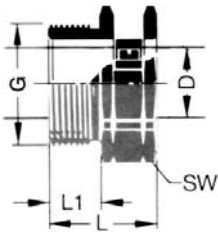

### Properties

- Pressure relief pressure screw
- Clamping buckle included as loose part

### Technical data

Protection class IP 55

### Design

- Material Brass nickel-plated

Part-No.	Type	G	Clamping range D mm	SW = across flats mm	L mm	L 1 mm	weight approx. kg/100 piece	VE piece
<b>ZED PG</b>								
600011	ZED PG 9	PG 9	6.0 – 9.0	17	18.0	5.5	1.32	50
600012	ZED PG 11	PG 11	8.0 – 12.0	20	20.0	6.5	2.37	50
600013	ZED PG 13.5	PG 13,5	10.0 – 16.0	22	21.0	6.5	2.75	50
600014	ZED PG 16	PG 16	10.0 – 16.0	24	21.0	6.5	3.12	50
600015	ZED PG 21	PG 21	14.0 – 21.0	30	21.0	7.5	4.65	25
600016	ZED PG 29	PG 29	20.0 – 30.0	40	22.0	8.0	8.38	25

# Cable fittings and accessories

## Metal fitting ZEV2

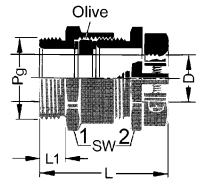

### Properties

- Centring strain relief fitting with hexagon base and clamp ring
- Clamping buckle included as loose part

### Technical data

Protection class IP 55

### Design

- Material Brass nickel-plated
- Clamp ring (ER) Neoprene

Part-No.	Type	G	Clamping range D mm	SW 1 = across flats mm	SW 2 = across flats mm	L mm	L 1 mm	weight approx. kg/100 piece	VE piece
<b>ZEV2 metric</b>									
600290	ZEV2 M 12	M 12	5.0 – 8.0	9	16	26.0	5.0	1.30	100
600291	ZEV2 M 16	M 16	7.0 – 10.0	17	19	26.0	6.0	2.80	50
600292	ZEV2 M 20	M 20	11.0 – 15.0	24	27	35.0	6.5	5.60	50
600293	ZEV2 M 25	M 25	12.0 – 20.0	30	34	37.0	7.0	13.10	25
600294	ZEV2 M 32	M 32	19.0 – 27.0	40	42	39.0	8.0	16.40	25
600295	ZEV2 M 40	M 40	25.5 – 34.0	55	55	50.0	9.0	22.00	10
600296	ZEV2 M 50	M 50	31.0 – 43.0	60	62	54.0	10.0	26.50	5
600297	ZEV2 M 63	M 63	35.0 – 48.0	64	64	54.0	10.0	35.50	5
<b>ZEV2 PG</b>									
600089	ZEV2 PG 7	PG 7	5.0 – 8.0	9	16	26.0	5.0	1.85	100
600080	ZEV2 PG 9	PG 9	7.0 – 10.0	17	19	26.0	6.0	2.28	50
600081	ZEV2 PG 11	PG 11	7.5 – 12.0	20	22	28.0	6.0	4.20	50
600082	ZEV2 PG 13.5	PG 13,5	7.5 – 12.0	22	24	32.0	6.5	4.90	50
600083	ZEV2 PG 16	PG 16	11.0 – 15.0	24	27	35.0	6.5	5.74	50
600084	ZEV2 PG 21	PG 21	12.0 – 20.0	30	34	37.0	7.0	9.30	25
600085	ZEV2 PG 29	PG 29	19.0 – 27.0	40	42	39.0	8.0	15.35	25
600086	ZEV2 PG 36	PG 36	26.5 – 34.0	55	55	50.0	9.0	26.60	10
600087	ZEV2 PG 42	PG 42	31.0 – 42.0	60	62	54.0	10.0	34.85	5
600088	ZEV2 PG 48	PG 48	35.0 – 48.0	64	64	54.0	10.0	42.40	5

# Cable fittings and accessories

## Metal fitting with shield termination ZEV2-S

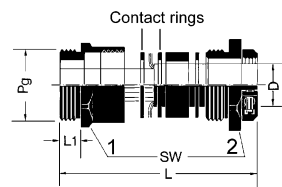

### Properties

- Centring strain relief fitting with hexagon base
- Gasket and shield termination
- Pressure screw with two clamping buckles

### Technical data

Protection class IP 55

### Design

- Material Brass nickel-plated
- Sealing ring (DR) Neoprene
- Contact ring (KR) copper

Part-No.	Type	G	Clamping range D mm	SW 1 = across flats mm	SW 2 = across flats mm	L mm	L 1 mm	K inner mm	weight approx. kg/100 piece	VE piece
<b>ZEV2-S metric</b>										
600611	ZEV2-S M 20	M 20	11.0 – 15.0	24	27	35.0	6.0	15	5.10	50
600612	ZEV2-S M 25	M 25	12.0 – 20.0	30	34	37.0	7.0	13	8.00	25
600613	ZEV2-S M 32	M 32	19.0 – 27.0	40	42	39.0	8.0	27	14.10	25
600614	ZEV2-S M 40	M 40	25.5 – 34.0	50	52	50.0	8.0	33	29.00	10
600615	ZEV2-S M 50	M 50	31.0 – 43.0	57	59	54.0	9.0	39	35.00	5
600616	ZEV2-S M 63	M 63	35.0 – 48.0	66	64	54.0	10.0	45	42.60	5
<b>ZEV2-S PG</b>										
600800	ZEV2-S PG 11	PG 11	7.0 – 12.0	20	22	28.0	6.0	10	4.12	50
600801	ZEV2-S PG 13.5	PG 13,5	7.0 – 12.0	22	24	32.0	6.5	10	5.13	50
600802	ZEV2-S PG 16	PG 16	7.0 – 15.0	24	27	35.0	6.5	10	5.80	50
600803	ZEV2-S PG 16	PG 16	7.0 – 15.0	24	27	35.0	6.5	15	5.60	50
600804	ZEV2-S PG 21	PG 21	10.0 – 19.0	30	34	37.0	7.0	13	9.60	25
600805	ZEV2-S PG 21	PG 21	10.0 – 19.0	30	34	37.0	7.0	19	9.40	25
600806	ZEV2-S PG 29	PG 29	18.0 – 27.0	40	42	39.0	8.0	21	15.70	25
600807	ZEV2-S PG 29	PG 29	18.0 – 27.0	40	42	39.0	8.0	27	15.40	25
600808	ZEV2-S PG 36	PG 36	24.0 – 33.0	55	55	50.0	9.0	33	27.50	10
600809	ZEV2-S PG 42	PG 42	30.0 – 39.0	60	62	54.0	10.0	39	37.50	5
600799	ZEV2-S PG 48	PG 48	36.0 – 45.0	65	68	54.0	10.0	45	46.60	5

Contact ring inner diameter in mm = K

# Cable fittings and accessories

## Metal fitting ZED2

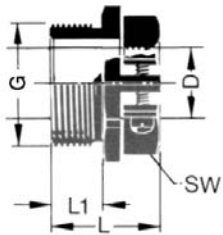

### Properties

- Centring pressure relief pressure screw
- Pressure screw with two clamping buckles

### Technical data

Protection class IP 55

### Design

- Material Brass nickel-plated

Part-No.	Type	G	Clamping range D mm	SW = across flats mm	L mm	L 1 mm	weight approx. kg/100 piece	VE piece
<b>ZED2 PG</b>								
600028	ZED2 PG 7	PG 7	5.0 – 8.0	16	15.0	5.0	1.31	100
600060	ZED2 PG 9	PG 9	7.0 – 10.0	19	16.0	6.0	1.84	50
600061	ZED2 PG 11	PG 11	7.0 – 12.0	22	17.5	6.0	2.75	50
600062	ZED2 PG 13.5	PG 13,5	7.0 – 12.0	24	17.8	6.5	3.45	50
600063	ZED2 PG 16	PG 16	11.0 – 15.0	27	18.3	6.5	3.67	50
600064	ZED2 PG 21	PG 21	12.0 – 20.0	34	20.8	7.0	6.24	25
600065	ZED2 PG 29	PG 29	19.0 – 27.0	42	21.8	8.0	9.20	25
600066	ZED2 PG 36	PG 36	25.5 – 34.0	55	25.3	9.0	29.00	10
600067	ZED2 PG 42	PG 42	31.0 – 43.0	62	26.3	10.0	22.00	5

# Cable fittings and accessories

## Metal fitting FKV

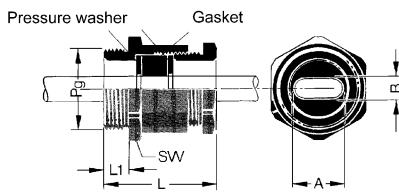

### Properties

- Flat cable fitting with special seal and two pressure disks.

### Technical data

Protection class IP 55

### Design

- Material Brass nickel-plated
- Sealing ring (DR) Neoprene

Part-No.	Type	G	A mm	B mm	SW = across flats mm	L mm	L 1 mm	Sealing ring (DR)	Pressure disk	weight approx. kg/100 piece	VE piece
<b>FKV PG</b>											
600741	FKV PG 16	PG 16	15.0	5.0	24	26.0	6.5	5.0 × 15	6.0 × 16	3.05	loose
600742	FKV PG 21	PG 21	18.0	6.0	30	29.0	6.5	6.0 × 18	8.5 × 20	4.80	loose
600748	FKV PG 21	PG 21	19.0	7.5	30	30.0	7.0	7.5 × 19	8.5 × 20	4.85	loose
600743	FKV PG 29	PG 29	28.0	6.0	40	33.0	8.0	6.0 × 28	8.0 × 30	9.65	loose
600749	FKV PG 29	PG 29	22.0	8.0	40	33.0	8.0	8.0 × 22	10.0 × 24	9.60	loose
600744	FKV PG 36	PG 36	35.0	6.0	50	33.0	8.0	6.0 × 35	8.0 × 38	16.75	loose
600751	FKV PG 36	PG 36	32.0	6.0	50	37.0	9.0	6.0 × 32	8.0 × 34	16.70	loose
600753	FKV PG 36	PG 36	37.0	12.5	50	39.0	9.0	12.5 × 37	14.5 × 38	15.15	loose
600752	FKV PG 36	PG 36	38.0	7.0	50	38.0	9.0	7.0 × 38	9.0 × 40	16.50	loose
600745	FKV PG 42	PG 42	41.0	13.5	58	38.0	9.0	13.5 × 41	14.5 × 41	24.00	loose
600746	FKV PG 48	PG 48	44.0	14.0	65	44.0	10.0	14.0 × 44	16.0 × 46	33.25	loose

# Cable fittings and accessories

## Metal accessory GMS

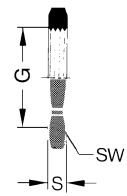

### Properties

- Counter nut according to DIN 46320, hexagonal

### Design

- Material Brass nickel-plated

Part-No.	Type	G	SW = across flats mm	S mm	weight approx. kg/100 piece	VE piece
<b>GMS metric</b>						
600368	GMS M 12 × 1.5	M 12	15	2.8	0.22	100
600361	GMS M 16 × 1.5	M 16	19	2.8	0.30	100
600362	GMS M 20 × 1.5	M 20	24	3.0	0.48	100
600363	GMS M 25 × 1.5	M 25	30	3.5	0.90	100
600364	GMS M 32 × 1.5	M 32	36	4.0	1.08	100
600365	GMS M 40 × 1.5	M 40	46	5.0	2.40	50
600366	GMS M 50 × 1.5	M 50	60	5.0	3.25	50
600367	GMS M 63 × 1.5	M 60	70	6.0	4.62	50
<b>GMS PG</b>						
600420	GMS PG 7	PG 7	15	2.8	0.18	100
600421	GMS PG 9	PG 9	18	2.8	0.23	100
600422	GMS PG 11	PG 11	21	3.0	0.30	100
600423	GMS PG 13.5	PG 13,5	23	3.0	0.36	100
600424	GMS PG 16	PG 16	26	3.0	0.50	100
600425	GMS PG 21	PG 21	32	3.5	0.79	100
600426	GMS PG 29	PG 29	41	4.0	1.30	50
600427	GMS PG 36	PG 36	51	5.0	2.10	50
600428	GMS PG 42	PG 42	60	5.0	3.45	50
600429	GMS PG 48	PG 48	64	5.5	3.50	25

# Cable fittings and accessories

## Metal accessory GMS EMV

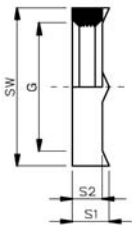

### Properties

- Hexagonal nut for potential equalisation
- With cutting edges for cutting through layers of paint or power coating for optimal contact

### Design

- Material Brass nickel-plated

Part-No.	Type	G	SW = across flats mm	S1 mm	S2 mm	weight approx. kg/100 piece	VE piece
<b>GMS EMV metric</b>							
600460	GMS EMV M 12 × 1.5	M 12	15	4.5	3.5	0.26	100
600461	GMS EMV M 16 × 1.5	M 16	19	4.5	3.5	0.37	100
600462	GMS EMV M 20 × 1.5	M 20	24	5.5	4.5	0.65	100
600463	GMS EMV M 25 × 1.5	M 25	30	5.5	4.5	1.06	100
600464	GMS EMV M 32 × 1.5	M 32	36	5.5	4.5	1.35	100
600465	GMS EMV M 40 × 1.5	M 40	46	6.0	5.0	2.85	50
600466	GMS EMV M 50 × 1.5	M 50	60	6.0	5.0	5.46	50
600467	GMS EMV M 63 × 1.5	M 63	70	7.0	6.0	5.92	50
<b>GMS EMV PG</b>							
600530	GMS EMV PG 7	PG 7	15	4.7	3.7	0.25	100
600531	GMS EMV PG 9	PG 9	18	4.7	3.7	0.33	100
600532	GMS EMV PG 11	PG 11	21	4.7	3.7	0.38	100
600533	GMS EMV PG 13.5	PG 13,5	23	4.7	3.7	0.45	100
600534	GMS EMV PG 16	PG 16	26	4.7	3.7	0.63	100
600535	GMS EMV PG 21	PG 21	32	5.2	4.2	0.98	100
600536	GMS EMV PG 29	PG 29	41	5.7	4.7	1.58	50
600537	GMS EMV PG 36	PG 36	51	6.5	5.5	2.58	50
600538	GMS EMV PG 42	PG 42	60	6.0	5.0	3.12	50
600539	GMS EMV PG 48	PG 48	64	6.5	5.5	3.74	50