

Cable conduits and conduit fittings

WELLFLEX CONDUIT WF



Application

- Suction line for gaseous media in the vacuum, ventilation, refrigeration industry.
- In swimming pool construction as well as in medical/chemical plant construction

Properties

- Circular, concentric and corrugated along the longitudinal axis
- High flexibility
- High restoring ability
- Resistant to: weak and organic acids, bases, inorganic salts, amines, alcohols and greases
- Conditionally resistant to: fuels and mineral oils
- Unstable against: strong acids, halogenated and oxidising connections, ketones, esters
- Smallest bending radius (neutral fibers) for a flattening of the outside $\varnothing \leq 5\%$

Technical data

Oil resistance	good
Melting point	+90 °C – 100 °C
Temperature range	-40 °C to +55 °C

Design

- Colour grey
- Material Ethylene-vinylacetate copolymer (EVA)

Part-No.	Type	suitable fitting Article number	suitable conduit holder Article number	Outer- \varnothing mm	Inner- \varnothing mm	Smallest bending radius	Weight kg/100 m	shipment VE
WF								
270115	WF 23	270125	270716	28.0	22.5	65	18.0	50 m
270116	WF 29	270126	270717	33.8	28.5	80	28.0	25 m
270117	WF 36	270127	270718	41.7	33.8	105	36.0	25 m
270118	WF 47	270128		53.1	45.0	140	50.0	25 m

Yield stress: DIN 53455; 10–20 N/mm²
 Elongation at break: DIN 53455; 700 – 800 %
 E-Module: DIN 53457; 75 –105 N/mm²
 Impact resistance: DIN 53453; o.Br. mJ/mm²
 Notch impact strength DIN 53453; o-Br. mJ/mm²

Cable conduits and conduit fittings

Plastic conduit holder WFH



halogenfree

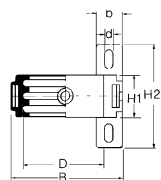

- Properties**
- – halogen-free –
 - Conduit holder
- Design**
- Material Polyamide PA 6
 - Colour grey

Part-No.	Type	Matching conduit Article number	Inner- \varnothing mm	D mm	B mm	B mm	H1 mm	H2 mm	weight approx. kg/100 piece	VE piece
WFH										
270125	WFH 23	270115	28.0	5.5	46.0	16.0	20.0	63.0	1.80	20
270126	WFH 29	270116	34.0	5.5	56.0	16.0	20.0	63.0	2.70	20
270127	WFH 36	270117	42.0	5.5	70.0	16.0	26.0	63.0	4.50	20
270128	WFH 47	270118	53.0	5.5	70.0	16.0	26.0	63.0	3.00	20