

Limit Switches

FT1 Series

IP65 □ thermoplastic type



TECHNO-CONTROL EQUIPMENT

1 cable entry
M16x1.5



FT1P32



FT133



FT1P33



FT138

TYPE OF OPERATOR	PA ROLLER LEVER PLUNGER WITH PROTECTIVE BOOT HORIZONTAL ACTUATION	PA ROLLER LEVER PLUNGER VERTICAL ACTUATION	PA ROLLER LEVER PLUNGER WITH PROTECTIVE BOOT VERTICAL ACTUATION	18 Ø PA ROLLER LEVER
Standard - Positive opening NC contacts	EN50047	EN50047	EN50047	EN50047
Minimum tripping force N	7	7	7	0.10
Minimum positive opening force N	24	24	24	0.32
Z11 Snap action 1NC-1NO Zb	FT1P32Z11 	FT133Z11 	FT1P33Z11 	FT138Z11
X11 Slow break 1NC-1NO Zb	FT1P32X11 	FT133X11 	FT1P33X11 	FT138X11
Y11 Slow break 1NC-1NO overlapping Zb	FT1P32Y11 	FT133Y11 	FT1P33Y11 	FT138Y11
Z02 Snap action 2NC Zb	FT1P32Z02 	FT133Z02 	FT1P33Z02 	FT138Z02
W02 Slow break 2NC Zb	FT1P32W02 	FT133W02 	FT1P33W02 	FT138W02
W20 Slow break 2NO Zb	FT1P32W20 	FT133W20 	FT1P33W20 	FT138W20
WEIGHT gr. - MIN. PACK QTY.	65 gr. 1 pcs.	65 gr. 1 pcs.	65 gr. 1 pcs.	80 gr. 1 pcs.

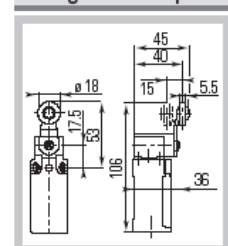
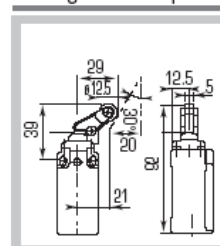
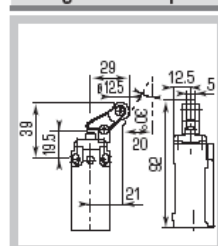
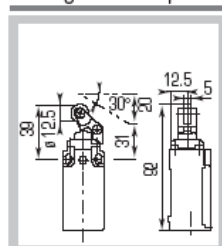
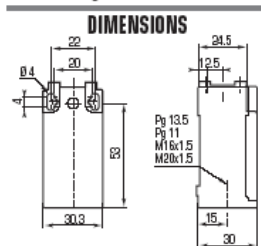

FT1 Series

IP65 □ thermoplastic type

1 cable entry
M16x1.5



FT141



FT139



FT140



FT135

TYPE OF OPERATOR	50 Ø RUBBER ROLLER LEVER	VARIABLE LENGTH 18 Ø PA ROLLER LEVER	VARIABLE LENGTH 50 Ø RUBBER ROLLER LEVER	SPRING LEVER WITH TIP IN PA
Standard - Positive opening NC contacts	-	-	-	EN50047
Minimum tripping force N	0.10	0.10	0.10	0.12
Minimum positive opening force N	-	-	-	-
Z11 Snap action 1NC-1NO 	FT141Z11 	FT139Z11 	FT140Z11 	FT135Z11
X11 Slow break 1NC-1NO 	FT141X11 	FT139X11 	FT140X11 	FT135X11
Y11 Slow break 1NC-1NO overlapping 	FT141Y11 	FT139Y11 	FT140Y11 	FT135Y11
Z02 Snap action 2NC 	FT141Z02 	FT139Z02 	FT140Z02 	FT135Z02
W02 Slow break 2NC 	FT141W02 	FT139W02 	FT140W02 	FT135W02
W20 Slow break 2NO 	FT141W20 	FT139W20 	FT140W20 	FT135W20
WEIGHT gr. - MIN. PACK QTY.	95 gr. 1 pcs.	105 gr. 1 pcs.	125 gr. 1 pcs.	70 gr. 1 pcs.

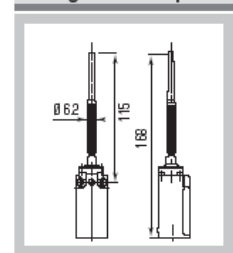
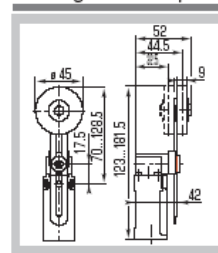
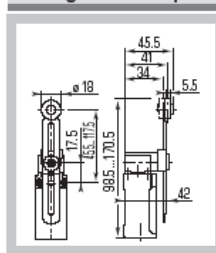
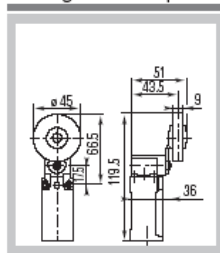
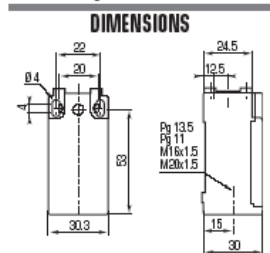

Limit Switches

FT1 Series

IP65 □ thermoplastic type



TECHNO-CONTROL EQUIPMENT

1 cable entry
M16x1.5



FT136



FT137

TYPE OF OPERATOR		"CAT'S WHISKER"	VARIABLE LENGTH 3 Ø STEEL ROD LEVER
Standard - Positive opening NC contacts		-	-
Minimum tripping force	N	0.12	0.12
Minimum positive opening force	N	-	-
Z11 1NC-1NO	Snap action Zb	FT136Z11 	FT137Z11
X11 1NC-1NO	Slow break Zb	FT136X11 	FT137X11
Y11 1NC-1NO overlapping	Slow break Zb	FT136Y11 	FT137Y11
Z02 2NC	Snap action Zb	FT136Z02 	FT137Z02
W02 2NC	Slow break Zb	FT136W02 	FT137W02
W20 2NO	Slow break Zb	FT136W20 	FT137W20

WEIGHT gr. - MIN. PACK QTY.

80 gr.

1 pcs.

105 gr.

1 pcs.

DIMENSIONS

