

FT2 Series

IP65 □ thermoplastic type

2 cable entries
M16x1.5



FT231



FT2P31



FT234



FT232

TYPE OF OPERATOR	SHORT STEEL END PLUNGE	SHORT STEEL END PLUNGER WITH PROTECTIVE BOOT	PA ROLLER LEVER PLUNGER	PA ROLLER LEVER PLUNGER HORIZONTAL ACTUATION
Standard – Positive opening NC contacts (→)	- (→)	- (→)	- (→)	- (→)
Minimum tripping force N	15	15	12	7
Minimum positive opening force N	30	30	30	24
Z11 Snap action 1NC-1NO Zb	FT231Z11 	FT2P31Z11 	FT234Z11 	FT232Z11
X11 Slow break 1NC-1NO Zb	FT231X11 	FT2P31X11 	FT234X11 	FT232X11
Y11 Slow break 1NC-1NO overlapping Zb	FT231Y11 	FT2P31Y11 	FT234Y11 	FT232Y11
Z02 Snap action 2NC Zb	FT231Z02 	FT2P31Z02 	FT234Z02 	FT232Z02
W02 Slow break 2NC Zb	FT231W02 	FT2P31W02 	FT234W02 	FT232W02
W20 Slow break 2NO Zb	FT231W20 	FT2P31W20 	FT234W20 	FT232W20
WEIGHT gr. – MIN. PACK QTY.	100 gr. 1 pcs.	100 gr. 1 pcs.	105 gr. 1 pcs.	105 gr. 1 pcs.

DIMENSIONS	FT231	FT2P31	FT234	FT232

Limit Switches

FT2 Series

IP65 □ thermoplastic type



TECHNO-CONTROL EQUIPMENT

2 cable entries
M16x1.5



FT2P32



FT238



FT239



FT240

TYPE OF OPERATOR	PA ROLLER LEVER PLUNGER WITH PROTECTIVE BOOT HORIZONTAL ACTUATION	18 Ø PA ROLLER LEVER	VARIABLE LENGTH 18 Ø PA ROLLER LEVER	VARIABLE LENGTH 50 Ø RUBBER ROLLER LEVER
Standard - Positive opening NC contacts →	- →	- →	-	-
Minimum tripping force	N	0.10	0.10	0.10
Minimum positive opening force	N	0.32	-	-
Z11 Snap action 1NC-1NO	FT2P32Z11 	FT238Z11 	FT239Z11 	FT240Z11
X11 Slow break 1NC-1NO	FT2P32X11 	FT238X11 	FT239X11 	FT240X11
Y11 Slow break 1NC-1NO overlapping	FT2P32Y11 	FT238Y11 	FT239Y11 	FT240Y11
Z02 Snap action 2NC	FT2P32Z02 	FT238Z02 	FT239Z02 	FT240Z02
W02 Slow break 2NC	FT2P32W02 	FT238W02 	FT239W02 	FT240W02
W20 Slow break 2NO	FT2P32W20 	FT238W20 	FT239W20 	FT240W20

WEIGHT gr. - MIN. PACK QTY.

105 gr. 1 pcs.

125 gr. 1 pcs.

125 gr. 1 pcs.

155 gr. 1 pcs.

DIMENSIONS

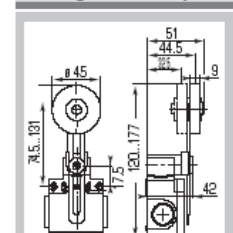
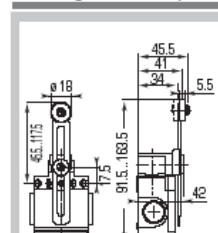
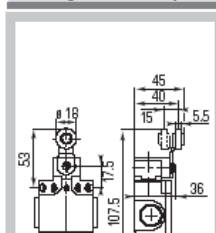
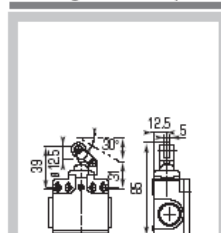
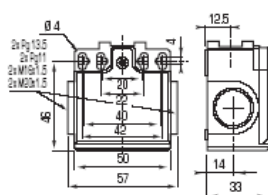

FT2 Series

IP65 □ thermoplastic type

2 cable entries
M16x1.5



FT241



FT235



FT236



FT237

TYPE OF OPERATOR	50 Ø RUBBER ROLLER LEVER	SPRING LEVER WITH TIP IN PA	"CAT'S WHISKER"	VARIABLE LENGTH 3 Ø STEEL ROD LEVER
Standard - Positive opening NC contacts	-	-	-	-
Minimum tripping force N	0.10	0.10	0.10	0.10
Minimum positive opening force N	-	0.32	-	-
Z11 Snap action 1NC-1NO	FT241Z11 	FT235Z11 	FT236Z11 	FT237Z11
X11 Slow break 1NC-1NO	FT241X11 	FT235X11 	FT236X11 	FT237X11
Y11 Slow break 1NC-1NO overlapping	FT241ZY11 	FT235Y11 	FT236Y11 	FT237Y11
Z02 Snap action 2NC	FT241Z02 	FT235Z02 	FT236Z02 	FT237Z02
W02 Slow break 2NC	FT241W02 	FT235W02 	FT236W02 	FT237W02
W20 Slow break 2NO	FT241W20 	FT235W20 	FT236W20 	FT237W20
WEIGHT gr. - MIN. PACK QTY.	145 gr. 1 pcs.	135 gr. 1 pcs.	110 gr. 1 pcs.	130 gr. 1 pcs.

