

CENTRAL LEVER ENCLOSURES



Description

Series specifically designed for industrial applications with limited installation space. These enclosures can be installed, placed side-by-side and handled in a single operation. Furthermore, the lever's shape reduces the effort required to uncouple the inner fittings.

Characteristics of materials used:

CH..YC, CA..YC and MA..YC, CA..YX and MF..YX series

- made of die cast aluminium alloy
- with epoxy-polyester powder coating
- gaskets in anti-aging, oil-resistant, grease-resistant and fuel-resistant vinyl nitrile elastomer
- locking device with single stainless steel lever



inserts:		page
CDD	24 poles + ⊕	59
CQE	10 poles + ⊕	80
CSH	6 poles + ⊕	88
CCE	6 poles + ⊕	94
CNE, CSE, JCNE, JCSE	6 poles + ⊕	95 and 106
CSS	6 poles + ⊕	118
CTE, CTSE *)	6 poles + ⊕	126
MIXO	2 modules	156÷195

*) can be used only in bulkhead mounting housings

insert centre distance:
44 x 27 mm

bulkhead mounting housings for central lever



surface mounting housings, high construction with two entries for central lever



description	part No.	part No.	entry Pg	part No.	entry M
bulkhead mounting with pegs for central lever size "44.27"	CHI 06 YC				
surface mounting, high construction, with pegs, for central lever size "44.27"		CAP 06 YC229	29x2	MAP 06 YC232	32x2

panel cut-out for bulkhead mounting housings in mm

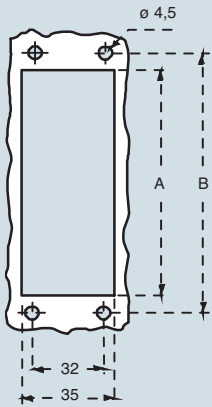

part	A	B
CHI 06 YC	52	70

dimensions in mm

CHI YC



part	A	B
CHI 06 YC	82,5	58

dimensions in mm

CAP YC and MAP YC

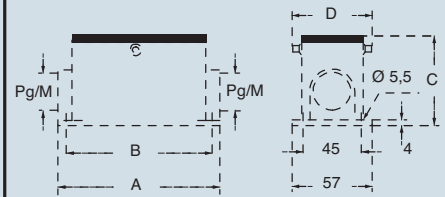

part	A	B	C	D
CAP 06 YC / MAP 06 YC	82	70	74	58

CAVUS® Type 4/4X/12



dimensions shown are not binding and may be changed without notice

CENTRAL LEVER - size 44.27

inserts:	page
CDD 24 poles + ⊕	59
CQE 10 poles + ⊕	80
CSH 6 poles + ⊕	88
CCE 6 poles + ⊕	94
CNE, CSE, JCNE, JCSE 6 poles + ⊕ 95 and 106	
CSS 6 poles + ⊕	118
MIXO 2 modules	156÷195

insert centre distance:
44 x 27 mm

hoods with central lever



hoods with central lever



description	part No.		entry Pg		part No.		entry M	
side entry, high construction size "44.27"	CAO 06 YX21	21	MAO 06 YX25	25				
	CAO 06 YX29	29	MAO 06 YX32	32				
top entry, high construction size "44.27"					CAV 06 YX21	21	MAV 06 YX25	25
					CAV 06 YX29	29	MAV 06 YX32	32

dimensions in mm

CAO..YX and MAO..YX

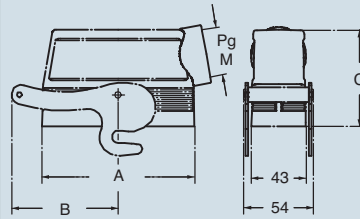

part	A	B	C
CAO 06 YX/MAO 06 YX	60	66	72

dimensions in mm

CAV..YX and MAV..YX

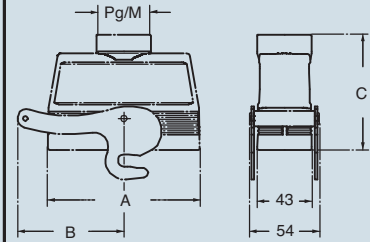

part	A	B	C
CAV 06 YX/MAV 06 YX	60	66	87 max

CENTRAL LEVER - size 44.27

CAVUS® Type 4/4X/12



dimensions shown are not binding
and may be changed without notice

inserts:		page
CDD	42 poles + ⊕	61
CQE	18 poles + ⊕	81
CSH	10 poles + ⊕	89
CCE	10 poles + ⊕	96
CNE, CSE, JCNE, JCSE	10 poles + ⊕	97 and 107
CSS	10 poles + ⊕	119
CTE, CTSE *)	10 poles + ⊕	127
CMSE	3+2 (aux) poles + ⊕	135
CMCE	3+2 (aux) poles + ⊕	134
CX	8/24 poles + ⊕	151
MIXO	3 modules	156÷195

insert centre distance:
57 x 27 mm

bulkhead mounting housings for central lever



surface mounting housings, high construction with two entries for central lever



description

part no.

part no.	entry Pg	part no.	entry M
----------	----------	----------	---------

bulkhead mounting with pegs for central lever size "57.27"

CHI 10 YC

--	--	--	--

surface mounting, high construction, with pegs, for central lever size "57.27"

CAP 10 YC229	29x2	MAP 10 YC232	32x2
---------------------	------	---------------------	------

*) can be used only in bulkhead mounting housings panel cut-out for bulkhead mounting housings in mm

dimensions in mm

dimensions in mm

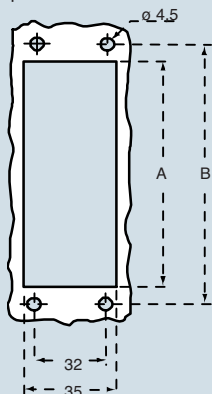

CHI YC



part	A
CHI 10 YC	95.5

CAP YC and MAP YC

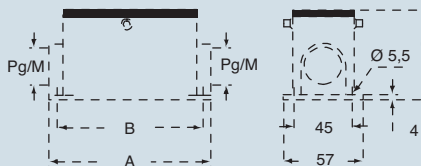

part	A	B	C
CAP 10 YC / MAP 10 YC	93.5	82	74

part	A	B
CHI 10 YC	65	83

CALUS® Type 4/4X/12



dimensions shown are not binding and may be changed without notice

CENTRAL LEVER - size 57.27



inserts:		page
CDD	42 poles + ⊕	61
CQE	18 poles + ⊕	81
CSH	10 poles + ⊕	89
CCE	10 poles + ⊕	96
CNE, CSE, JCNE, JCSE	10 poles + ⊕ 97 and 107	
CSS	10 poles + ⊕	119
CMSE	3+2 (aux) poles + ⊕	135
CMCE	3+2 (aux) poles + ⊕	134
CX	8/24 poles + ⊕	151
MIXO	3 modules	156÷195

insert centre distance:
57 x 27 mm

hoods with central lever



hoods with central lever



description	part no.		entry Pg		part no.		entry M	
side entry, high construction size "57.27"	CAO 10 YX21	21	MAO 10 YX32	32				
size "57.27"	CAO 10 YX29	29	MAO 10 YX40	40				
top entry, high construction size "57.27"					CAV 10 YX21	21	MAV 10 YX32	32
size "57.27"					CAV 10 YX29	29	MAV 10 YX40	40

dimensions in mm
CAO..YX and MAO..YX

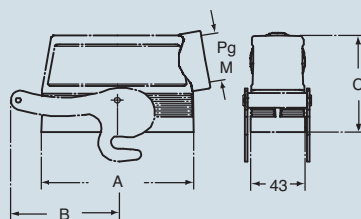

part	A	B	C
CAO 10 YX/MAO 10 YX	73	66	70

dimensions in mm
CAV..YX and MAV..YX

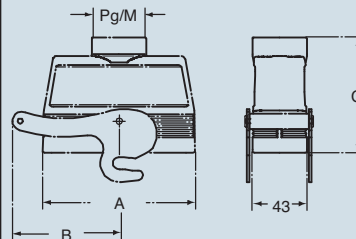

part	A	B	C
CAV 10 YX/MAV 10 YX	73	66	85

CALUS® Type 4/4X/12



dimensions shown are not binding
and may be changed without notice

CENTRAL LEVER - size 57.27



inserts:		page
CD	40 poles + ⊕	49
CT, CTS (10A)	40 poles + ⊕	56
CDD	72 poles + ⊕	62
CQE	32 poles + ⊕	82
CSH	16 poles + ⊕	90
CCE	16 poles + ⊕	98
CNE, CSE, JCNE, JCSE	16 poles + ⊕ 99 and 108	
CSS	16 poles + ⊕	120
CTE, CTSE (16A) *)	16 poles + ⊕	128
CMSE	6+2 (aux) poles + ⊕	137
CMCE	6+2 (aux) poles + ⊕	136
CP	6 poles + ⊕	149
CX	6/36 and 12/2 poles + ⊕	152÷153
CX	4/0 and 4/2 poles + ⊕	154
MIXO	4 modules	156÷195

insert centre distance: 77.5 x 27 mm

bulkhead mounting housings for central lever



surface mounting housings, high construction with two entries for central lever



description	part no.	part no.	entry Pg	part no.	entry M
bulkhead mounting with pegs for central lever size "77.27"	CHI 16 YC				
surface mounting, high construction, with pegs, for central lever size "77.27"		CAP 16 YC229	29x2	MAP 16 YC232	32x2

*) can be used only in bulkhead mounting housings
panel cut-out for bulkhead mounting housings in mm

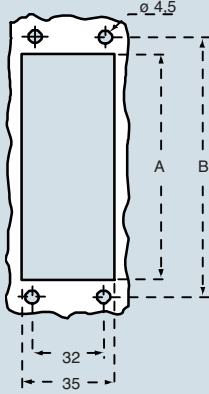

part	A	B
CHI 16 YC	86	103

dimensions in mm

CHI YC



part	A
CHI 16 YC	115.5

dimensions in mm

CAP YC and MAP YC

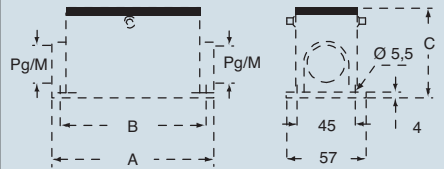

part	A	B	C
CAP 16 YC / MAP 16 YC	117	105	81

CALUS Type 4/4X/12



dimensions shown are not binding and may be changed without notice

CENTRAL LEVER - size 77.27

inserts:		page
CD	40 poles + ⊕	49
CDD	72 poles + ⊕	62
CQE	32 poles + ⊕	82
CSH	16 poles + ⊕	90
CCE	16 poles + ⊕	98
CNE, CSE, JCNE, JCSE	16 poles + ⊕	99 and 108
CSS	16 poles + ⊕	120
CMSE	6+2 (aux) poles + ⊕	137
CMCE	6+2 (aux) poles + ⊕	136
CP	6 poles + ⊕	149
CX	6/36 and 12/2 poles + ⊕	152÷153
CX	4/0 and 4/2 poles + ⊕	154
MIXO	4 modules	156÷195

insert centre distance: 77.5 x 27 mm

hoods with central lever



hoods with central lever



description	part no.	entry Pg	part no.	entry M	part no.	entry Pg	part no.	entry M
	side entry, high construction size "77.27"	CAO 16 YX21	21	MAO 16 YX32	32			
size "77.27"	CAO 16 YX29	29	MAO 16 YX40	40				
top entry, high construction size "77.27"					CAV 16 YX21	21	MAV 16 YX32	32
size "77.27"					CAV 16 YX29	29	MAV 16 YX40	40

dimensions in mm
CAO..YX and MAO..YX

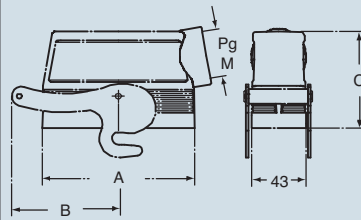

part	A	B	C
CAO 16 YX/MAO 16 YX	93.5	76	76

dimensions in mm
CAV..YX and MAV..YX

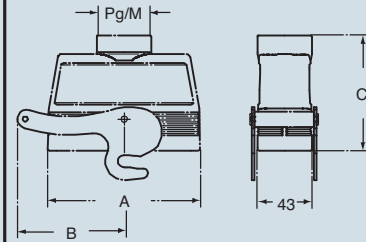

part	A	B	C
CAV 16 YX/MAV 16 YX	93.5	76	91

CALUS® Type 4/4X/12



dimensions shown are not binding and may be changed without notice

CENTRAL LEVER - size 77.27

inserts:		page
CD	64 poles + ⊕	51
CT, CTS (10A)	64 poles + ⊕	57
CDD	108 poles + ⊕	64
CQE	46 poles + ⊕	83
CSH	24 poles + ⊕	91
CCE	24 poles + ⊕	100
CNE, CSE, JCNE, JCSE	24 poles + ⊕ 101 and 109	
CSS	24 poles + ⊕	121
CTE, CTSE (16A) *)	24 poles + ⊕	129
CMSE	10+2 (aux) poles + ⊕	139
CMCE	10+2 (aux) poles + ⊕	138
CX	4/8 poles + ⊕	155
MIXO	6 modules	156÷195

insert centre distance:
104 x 27 mm

bulkhead mounting housings for central lever



surface mounting housings, high construction with two entries for central lever



description	part no.
bulkhead mounting with pegs for central lever size "104.27"	CHI 24 YC
surface mounting, high construction, with pegs, for central lever size "104.27"	CAP 24 YC229 29x2 MAP 24 YC232 32x2

part no.	entry Pg	part no.	entry M

part no.	entry Pg	part no.	entry M

*) can be used only in bulkhead mounting housings
panel cut-out for bulkhead mounting housings in mm

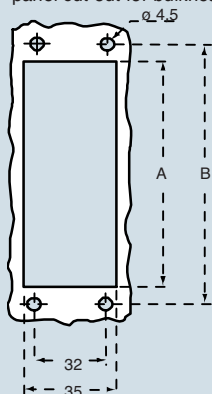

part	A	B
CHI 24 YC	112	130

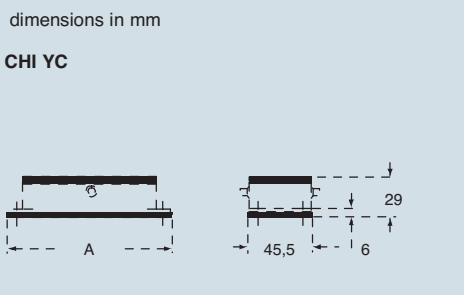

part	A
CHI 24 YC	142.5

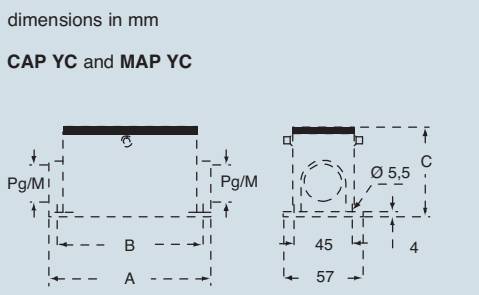

part	A	B	C
CAP 24 YC / MAP 24 YC	144	132	81

CENTRAL LEVER - size 104.27

CALUS® Type 4/4X/12



dimensions shown are not binding
and may be changed without notice

inserts:		page
CD	64 poles + ⊕	51
CDD	108 poles + ⊕	64
CQE	46 poles + ⊕	83
CSH	24 poles + ⊕	91
CCE	24 poles + ⊕	100
CNE, CSE, JCNE, JCSE	24 poles + ⊕	101 and 109
CSS	24 poles + ⊕	121
CMSE	10+2 (aux) poles + ⊕	139
CMCE	10+2 (aux) poles + ⊕	138
CX	4/8 poles + ⊕	155
MIXO	6 modules	156+195

insert centre distance:
104 x 27 mm

hoods with central lever



hoods with central lever



description	part no.		entry Pg		part no.		entry M	
side entry, high construction								
size "104.27"	CAO 24 YX21	21	MAO 24 YX32	32				
size "104.27"	CAO 24 YX29	29	MAO 24 YX40	40				
top entry, high construction								
size "104.27"					CAV 24 YX21	21	MAV 24 YX32	32
size "104.27"					CAV 24 YX29	29	MAV 24 YX40	40

dimensions in mm
CAO..YX and MAO..YX

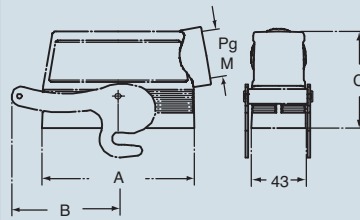

part	A	B	C
CAO 24 YX/MAO 24 YX	120	84	76

dimensions in mm
CAV..YX and MAV..YX

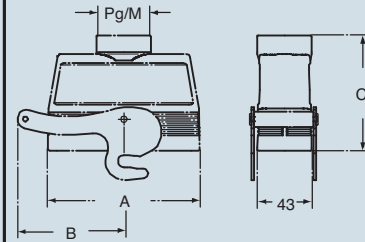

part	A	B	C
CAV 24 YX/MAV 24 YX	120	84	91

CALUS® Type 4/4X/12



dimensions shown are not binding
and may be changed without notice

CENTRAL LEVER - size 104.27

inserts:		page
CD	64 poles + ⊕	51
CDD	108 poles + ⊕	64
CQE	46 poles + ⊕	83
CSH	24 poles + ⊕	91
CCE	24 poles + ⊕	100
CNE, CSE, JCNE, JCSE	24 poles + ⊕	101 and 109
CSS	24 poles + ⊕	121
CMSE	10+2 (aux) poles + ⊕	139
CMCE	10+2 (aux) poles + ⊕	138
CX	4/8 poles + ⊕	155
MIXO	6 modules	156÷195

insert centre distance:
104 x 27 mm

inclined hoods with central lever with side entry



NEW

inclined hoods with central lever with top entry



NEW

description	part no.	entry Pg	part	entry M	part no.	entry Pg	part no.	entry M
	side entry, high construction size "104.27" size "104.27"	CIO 24 YX36	36	MIO 24 YX40	40			
	MIO 24 YX50			50				
top entry, high construction size "104.27" size "104.27"					CIV 24 YX36	36	MIV 24 YX40	40
							MIV 24 YX50	50

dimensions in mm
CIO..YX and MIO..YX

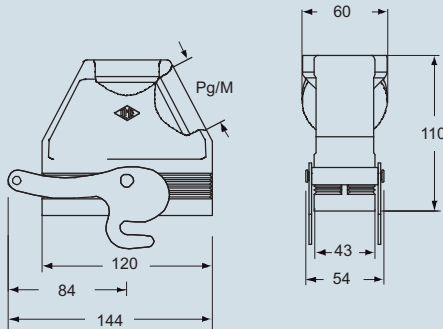

dimensions in mm
CIV..YX and MIV..YX

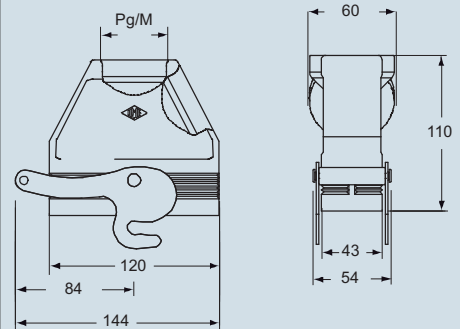

Even when coding is not required, it is recommended to use CRM and CRF pins with CD and CDD inserts and CRM CX and CRF CX pins with MIXO inserts to reduce movements when fitting and removing the connectors and to avoid contact damages. Within this scope, the DIN 43 652 standard requires a maximum angular longitudinal fluctuation of ±5°.

dimensions shown are not binding and may be changed without notice

CENTRAL LEVER - size 104.27