

- PN...SV types 16A (IP44), entry with cable gland colour RAL 9005 black, enclosure colour RAL 9005 black
- PN...PV types 16A (IP44), enclosure and spring lid colour RAL 9005 black, entry with cable gland
- Compliant with EN 60309-1 and -2
- PN...SV types, enclosure and insert in insulating, thermoplastic, self-extinguishing material
- PN...PV types, enclosure, insert and spring lid in insulating, thermoplastic, self-extinguishing material
- Terminals with retained screws
- IP44 degree of protection (EN 60529)

16A coupler plugs
IP44 degree of protection
low voltage:
from over 50V up to 690V



NEW

16A coupler socket-outlets
IP44 degree of protection
low voltage:
from over 50V up to 690V



NEW

Number of poles	Frequency Hz	Voltage V	Earthing contact position h	Part No.	Part No.
2P+⊕	50 and 60	200 - 250	6	PN 1663 SV	PN 1663 PV
3P+⊕	50 and 60	380 - 415	6	PN 1664 SV	PN 1664 PV
3P+N+⊕	50 and 60	200/346 - 240/415	6	PN 1665 SV	PN 1665 PV

dimensions in mm

(16A) PN ... SV

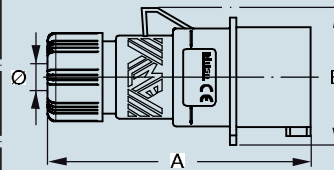

PN...SV	A	B	ø min	ø max
16A 2P+⊕	129	59.5	7	16
3P+⊕	129	67	7	16
3P+N+⊕	129	75	8	24

dimensions in mm

(16A) PN ... PV

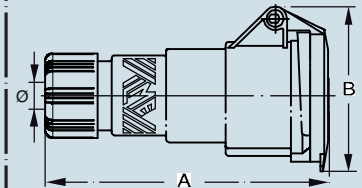

PN...PV	A	B	ø min	ø max
16A 2P+⊕	146	74.5	7	16
3P+⊕	146	84.5	7	16
3P+N+⊕	146	92.5	8	24

dimensions shown are not binding
 and may be changed without notice



- Enclosure and spring lid colour RAL 9005 black
- Compliant with EN 60309-1 and -2
- Enclosure, insert and spring lid in insulating, thermoplastic, self-extinguishing material
- Flange with anti-ageing gasket
- PN...PI - PN...PQ types (IP44), spring lid
- Terminals with retained screws
- IP44 degree of protection (EN 60529)

16A flush-mounting inclined socket-outlets
IP44 degree of protection
low voltage:
from over 50V up to 690V



NEW

16A flush-mounting straight socket-outlets
IP44 degree of protection
low voltage:
from over 50V up to 690V



NEW

Number of poles	Frequency Hz	Voltage V	Earthing contact position h	Part No.	Part No.
2P+⊕	50 and 60	200 - 250	6	PN 1663 PI	PN 1663 PQ
3P+⊕	50 and 60	380 - 415	6	PN 1664 PI	PN 1664 PQ
3P+N+⊕	50 and 60	200/346 - 240/415	6	PN 1665 PI	PN 1665 PQ

dimensions in mm

(16A) PN ... PI

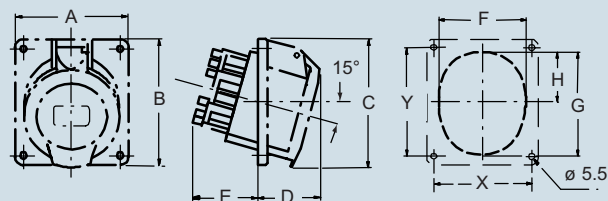

PN ... PI	A	B	C	D	E	F	G	H	X	Y
16A 2P+⊕	64	82	82	38	46	52	62	30	52	60
3P+⊕	64	82	82	42	47	57	65	28	52	60
3P+N+⊕	92	100	100	43	47	66	78	37.5	77	85

(16A) PN ... PQ

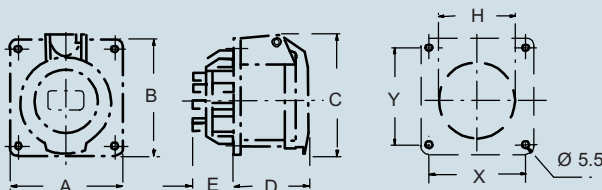

PN...PQ	A	B	C	D	E	H	X	Y
16A 2P+⊕	65	65	71	52	27	60	52	52
3P+⊕	65	65	75	53	27	61.5	52	52
3P+N+⊕	80	80	86	53	27	70	60	60

dimensions shown are not binding
 and may be changed without notice