

JME CE  
IP 68

**CG/MG series (“44.27”, “57.27”, “77.27”, “104.27”)**

The new CG/MG series of fixed and portable enclosures for connectors combines water tightness to IP68 rating and high mechanical sturdiness compliant with EMC standards.

The enclosures ensure the highest degree of protection from external interferences; more specifically, they protect people from accessing the dangerous components housed inside the enclosures (direct contact) and they protect the internal connector inserts from the ingress of foreign matters (dust) and from the harmful effects of fluid ingress.

The water tightness between the bulkhead mounting housings and the panel is ensured by an O-ring seal held in position in a slot within the bulkhead mounting housing base. A second O-ring seal fitted around the edges of the enclosure ensures the water tightness between the portable and the fixed enclosure when the connector is mated.

To ensure the water tightness when the enclosure is fitted onto a cabinet panel, the optional mounting frame with four M6 threaded blind holes may need to be installed inside the panel. The fastening screws must be fitted inside the enclosure and, through the fastening holes to be drilled on the panel, must be tightened onto the M6 mounting frame internal thread instead of the usual fastening nuts.

The flush mounted fixed enclosure fastening holes have been drilled inside the O-ring seal in order to avoid having to use other seals. Although these enclosures are larger than the standard enclosures to leave more space for the cables, and the walls are thicker to achieve more mechanical sturdiness, the fixing points have remained the same as those of the standard enclosures.

The series is offered with two types of locking systems: bayonet and screw. The two closing points are located in asymmetrical positions to ensure an optimal water tightness and the lowest footprint in case of multiple enclosures placed alongside at the front. The locking parts of both versions are made of high quality stainless steel and are firmly fastened inside the portable enclosure. These locking parts can be fitted and removed by using either a 1.5 mm flat blade screwdriver or a 10 mm hexagonal key.

The fixed and portable enclosures are made of foundry grade aluminium alloy, particularly resistant to sea water corrosion. The finish is made from epoxy polyester powder, which gives the enclosures high scratch and shock resistant properties.

The metal cover is made with the same quality materials as the enclosures, and is fitted with a short cord to make it always retrievable.

**Scope of application:**

External interconnections in vehicles, in harsh environments and in humid areas and with sensitive interconnections requiring screening. They are particularly suitable for the applications in the railway industry and any application requiring high resistance to pressure, impact and corrosion, with IP68 protection rating. They also ensure a good screening for electromagnetic compatibility.

The IP68 protection rating printed on the enclosure is ensured if the enclosures are correctly installed and the cable entry devices have equal or higher rating.

**Protection rating compliant with EN 60529 standard**

When closed, the CG/MG enclosures protect the connector inserts fitted inside from outside interference, such as mechanical knocks, foreign bodies, humidity, dust, water or other fluids such as cleaning or cooling agents, oils etc.

The IP68 protection rating ensured by the enclosure is fully described in the EN 60529 standard, which classifies the enclosures according to their protection against the entry of foreign bodies and water.

IP68 = total protection against dust, and from access to harmful parts with accessibility of Ø 1mm (First digit), and protection against the effects of prolonged submersion (>30') in water at the maximum depth of > 1 m (Second digit).

These enclosure have also successfully passed the tests required for the IPX6 protection rating compliant with EN 60529 standard and for the IPX9K protection rating compliant with DIN 40050-9 standard

The following table shows the different levels of protection required by the IP standard

First <sup>Digit</sup> Protection of people against contact with harmful parts			Second <sup>Digit</sup> Protection of materials against harmful penetration of water		
IP	External solid objects	Protection	IP	Tests	Protection
0		none	0		none
1		against solid objects with Ø over 50 mm (e.g. contact with hand)	1		against vertical drops of water
2		against solid objects with Ø over 12 mm (e.g. contact with finger)	2		against drops of water with an inclination of 15° from the vertical
3		against solid objects with Ø over 2.5 mm (e.g. tools and wires)	3		against drops of water with an inclination of 60° from the vertical
4		against solid objects with Ø over 1 mm (e.g. fine tools and wires)	4		against splashing water from all directions
5		against dust (no harmful deposit)	5		against water jets from all directions
6		total against dust	6		against water jets similar to sea waves
			7		against the effects of temporary immersion to a maximum depth of 1 meter
			8		against the effects of submersion in water

**SCREW CLOSURE**



**BAYONET CLOSURE**



IP68 - overview

**CG/MG series (“44.27”, “57.27”, “77.27”, “104.27”)**

- ❶ Threaded cable entry hole, available in different Pg diameters (types with prefix starting with “C”) or metric pitch (types with prefix starting with “M”) compliant with EN 60423 standard, for cable entry devices compliant with EN 50262 standard, for vertical or horizontal layout.
- ❷ Sturdy, corrosion proof foundry grade aluminium alloy enclosures, with chromate treated die cast.  
The following types are available: wall mounted, flush mounted fixed and portable enclosures with portable protective cover.
- ❸ Oven painted with epoxy polyester powder in black RAL 9005, which gives the enclosures a high mechanical strength and makes them resistant to external agents.
- ❹ The inserts are made of UL certified self-extinguishing fibreglass reinforced thermoplastics, and feature an operating temperature range between -40 °C and +125 °C.
- ❺ Insert profile polarised with asymmetrical guides to avoid incorrect matings.  
The inserts have a mechanical life equal to or higher than 500 mating cycles.
- ❻ Inserts are manufactured in compliance with European standard EN 61984 (DIN VDE 0627), certified and identified with UL and CSA markings.
- ❼ Special NBR elastomere, anti-ageing, oil and fuel resistant seals which, together with the cable entry devices (not supplied) ensure mated connectors IP68 protection rating. The seals are internally positioned to give a better protection from sunlight and outside elements.

- ❽ Fixings are available in two solutions: with hexagonal head stainless steel screws or bayonet type. The slotted hexagonal head screws can be fitted and removed by using either a 1.5mm thick blade screwdriver or a 10mm hexagonal key, and can be easily accessed even when fitted on enclosures with horizontally exited cables. Tightening torque 2.5 Nm.
- ❾ Captive insert fastening screws, with anti-slackening spring washer.
- ❿ Contact position identified with numbers or codes on both sides of each insert and printed with a laser system or from a die.
- ⓫ Silver or gold plated brass contacts connected to the wires by means of captive screws supplied already slackened, with spring terminal, by means of crimping (contacts available separately), or with a built-in 45° terminal block (still with screw or spring terminal).

- ⓬ Protective earth terminal with a wide contact surface.
- ⓭ Fixed, flush mounted enclosure with fastening screws inside the gasket.
- ⓮ Wider enclosures to give more space for the cabling.
- ⓯ They ensure a good screening for electromagnetic compatibility, resistance to vibrations in compliance with EN 61373 standard and to pressurised water.

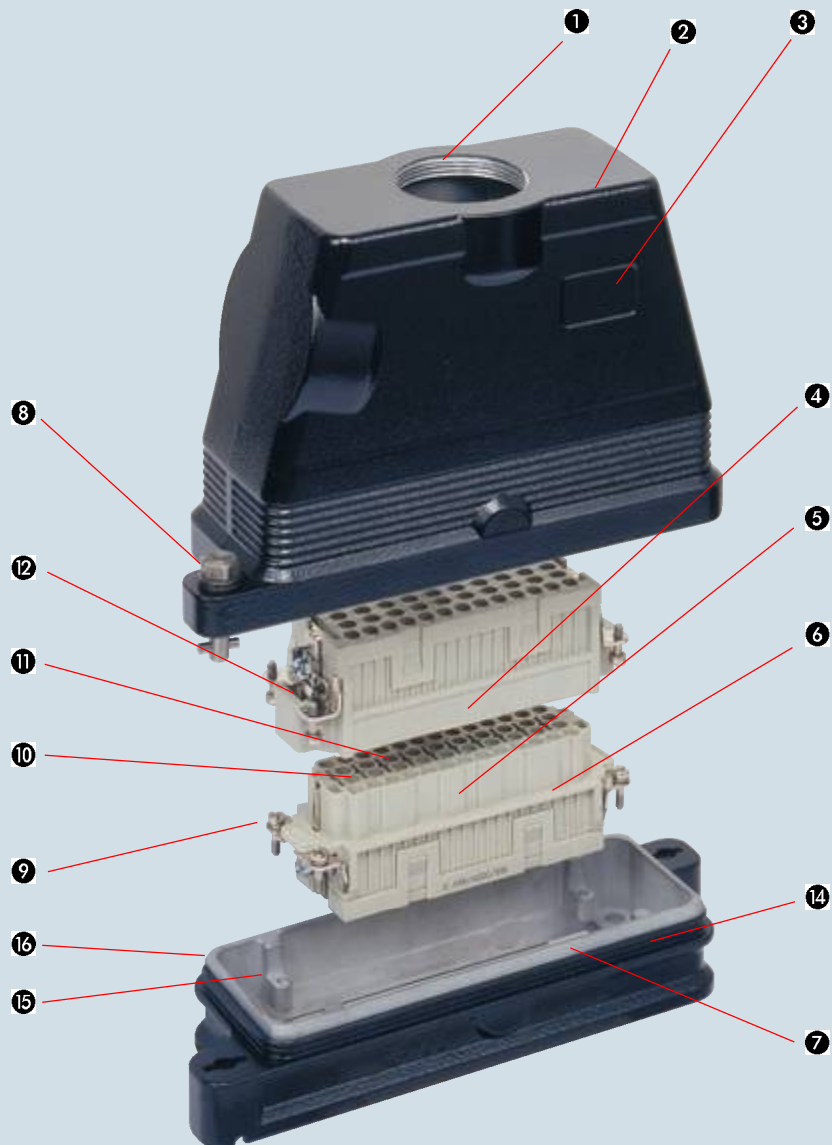



inserts:		page
CK .....	3 poles + ⊕	40
CK .....	4 poles + ⊕	40
CKS .....	3 poles + ⊕	41
CKS .....	4 poles + ⊕	41
CD ** .....	8 poles	46
CQ .....	5 poles + ⊕	69
CQ .....	12 poles + ⊕	68
<b>CJ KF</b> .....		441
<b>(can be used only in I/IAP enclosures)</b>		
<b>CX 1/2 BD</b> .....		444

\*\* to ensure IP68 protection rating with CD 08 insert, purchase the kit CKR 65 D. In this case do not use the screw supplied with the enclosure

insert dimensions: **21 x 21 mm**

**bulkhead mounting housing**



IP69K (compliant with DIN 40050-9)

description	part No.
bulkhead mounting housing	<b>CGK I</b>

dimensions in mm

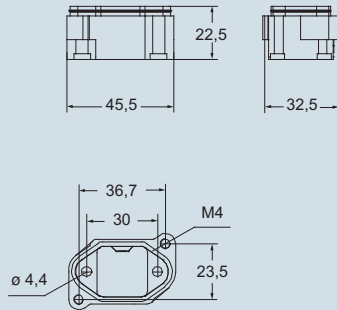

dimensions shown are not binding and may be changed without notice

special enclosures



inserts:	page
CK ..... 3 poles + ⊕	40
CK ..... 4 poles + ⊕	40
CKS ..... 3 poles + ⊕	41
CKS ..... 4 poles + ⊕	41
CD ** ..... 8 poles	46
CQ ..... 5 poles + ⊕	69
CQ ..... 12 poles + ⊕	68
<b>CJ KM</b> .....	441
<b>(can be used only in hoods)</b>	
<b>CX 1/2 BD</b> .....	444

\*\* to ensure IP68 protection rating with CD 08 insert, purchase the kit CKR 65 D. In this case do not use the screw supplied with the enclosure

insert dimensions: 21 x 21 mm

angled bulkhead mounting housings



**NEW**



IP69K (compliant with DIN 40050-9)

hoods



**NEW**



IP69K (compliant with DIN 40050-9)

description	part No.		entry		part No.		entry	
			Pg	M			Pg	M
without cable entry (on request)	<b>CGK IA</b>							
with cable entry	<b>CGK IAP13</b>		13.5		<b>MGK IAP20</b>		20	
top entry					<b>CGK V13</b>		13.5	
					<b>MGK V20</b>		20	

panel cut-out for CGK IA enclosures, in mm

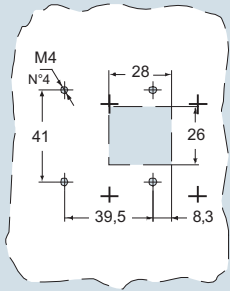

dimensions in mm

**CGK IA**

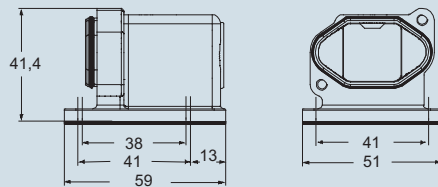

dimensions in mm

**CGK V and MGK V**

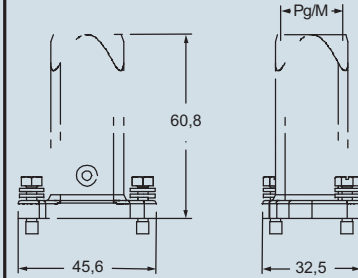

panel cut-out for CGK/MGK IAP enclosures, in mm

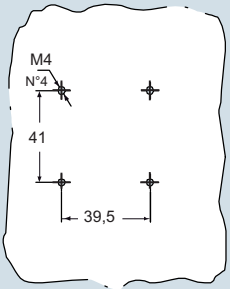

**CGK IAP and MGK IAP**

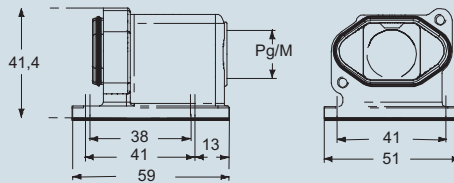

- Eliminate the gasket and the insert fixing screw
- Use screw with gasket provided with the enclosure

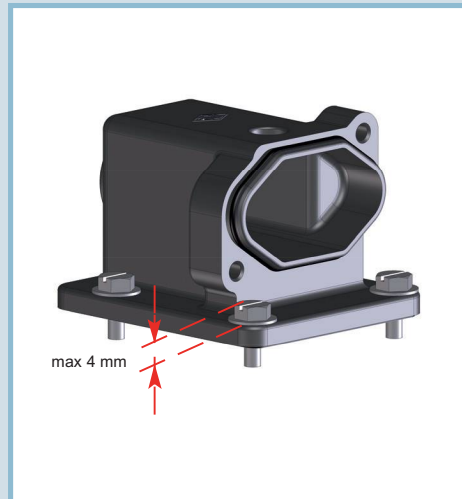
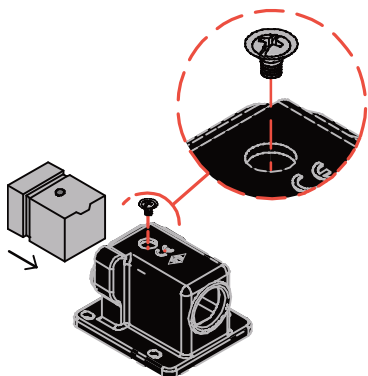

dimensions shown are not binding and may be changed without notice

Special enclosures

inserts:		page
CDD .....	24 poles + ⊕	59
CQE .....	10 poles + ⊕	80
CSH .....	6 poles + ⊕	88
CCE .....	6 poles + ⊕	94
CNE, CSE, JCNE, JCSE ..	6 poles + ⊕	95 and 106
CSS .....	6 poles + ⊕	118
MIXO .....	2 modules	156÷195

insert centre distance:  
44 x 27 mm

**bulkhead mounting housings**

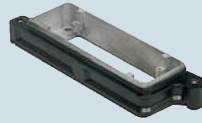

IP69K (compliant with DIN 40050-9)

**surface mounting housings**



IP69K (compliant with DIN 40050-9)

description	part no.		part no.		part no.	
			entry Pg		entry M	
size "44.27"	<b>CGI 06</b>					
size "44.27"			<b>CGP 06.29</b>	29	<b>MGP 06.32</b>	32

panel cut-out for bulkhead mounting housings in mm

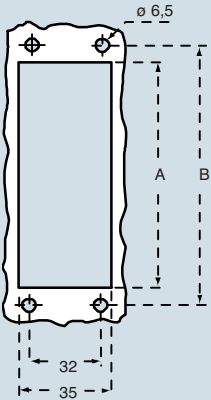

part	A	B
CGI 06	52	70

dimensions in mm

**CGI**



part	A
CGI 06	133

dimensions in mm

**CGP and MGP**

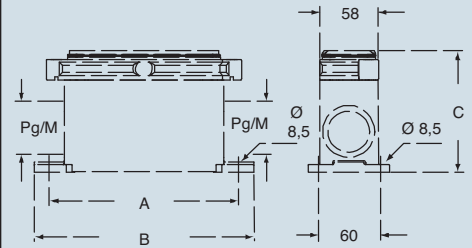

part	A	B	C
CGP 06 - MGP 06	127	156	110

special enclosures

inserts:		page
<b>CDD</b> .....	24 poles + ⊕	59
<b>CQE</b> .....	10 poles + ⊕	80
<b>CSH</b> .....	6 poles + ⊕	88
<b>CCE</b> .....	6 poles + ⊕	94
<b>CNE, CSE, JCNE, JCSE</b> ..	6 poles + ⊕	95 and 106
<b>CSS</b> .....	6 poles + ⊕	118
<b>MIXO</b> .....	2 modules	156÷195

insert centre distance:  
44 x 27 mm

hoods



IP69K (compliant with DIN 40050-9)

covers



IP69K (compliant with DIN 40050-9)

description	hoods		covers	
	part no.	entry Pg	part no.	entry M
with side entry				
size "44.27"	<b>CGO 06.16</b>	16	<b>MGO 06.25</b>	25
size "44.27"	<b>CGO 06.21</b>	21	<b>MGO 06.32</b>	32
size "44.27"	<b>CGO 06.29</b>	29		
with top entry				
size "44.27"	<b>CGV 06.16</b>	16	<b>MGV 06.25</b>	25
size "44.27"	<b>CGV 06.21</b>	21	<b>MGV 06.32</b>	32
size "44.27"	<b>CGV 06.29</b>	29	<b>MGV 06.40</b>	40
size "44.27"				<b>CGC 06</b>

dimensions in mm

CGO/MGO and CGV/MGV

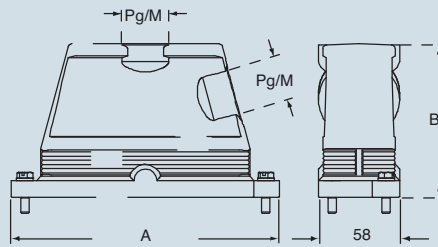

part	A	B
<b>CGO/MGO and CGV/MGV 06</b>	133	101

dimensions in mm

CGC

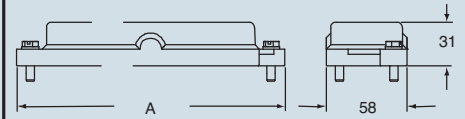

part	A
<b>CGC 06</b>	133

**CAUS**® Type 4/4X/12

dimensions shown are not binding and may be changed without notice

Special enclosures

inserts:		page
CDD .....	24 poles + ⊕	59
CQE .....	10 poles + ⊕	80
CSH .....	6 poles + ⊕	88
CCE .....	6 poles + ⊕	94
CNE, CSE, JCNE, JCSE ..	6 poles + ⊕	95 and 106
CSS .....	6 poles + ⊕	118
MIXO .....	2 modules	156÷195

insert centre distance:  
44 x 27 mm

**bulkhead mounting housings**



IP69K (compliant with DIN 40050-9)

description

part no.

size "44.27"

**CGI 06 B**

panel cut-out for bulkhead mounting housings in mm

dimensions in mm

**CGI..B**

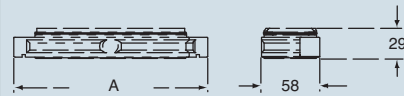
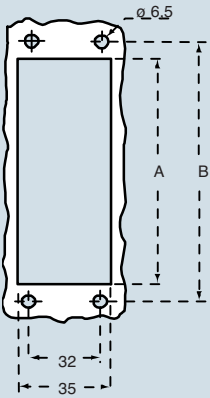

part	A	B
<b>CGI 06 B</b>	52	70

part	A
<b>CGI 06 B</b>	133

**CAVUS**® Type 4/4X/12

dimensions shown are not binding  
and may be changed without notice

special enclosures



inserts:		page
<b>CDD</b> .....	24 poles + ⊕	59
<b>CQE</b> .....	10 poles + ⊕	80
<b>CSH</b> .....	6 poles + ⊕	88
<b>CCE</b> .....	6 poles + ⊕	94
<b>CNE, CSE, JCNE, JCSE</b> ..	6 poles + ⊕	95 and 106
<b>CSS</b> .....	6 poles + ⊕	118
<b>MIXO</b> .....	2 modules	156÷195

insert centre distance:  
44 x 27 mm

hoods



IP69K (compliant with DIN 40050-9)

covers



IP69K (compliant with DIN 40050-9)

description	hoods		covers	
	part no.	entry Pg	part no.	entry M
with side entry				
size "44.27"	<b>CGO 06.16 B</b>	16	<b>MGO 06.25 B</b>	25
size "44.27"	<b>CGO 06.21 B</b>	21	<b>MGO 06.32 B</b>	32
size "44.27"	<b>CGO 06.29 B</b>	29		
with top entry				
size "44.27"	<b>CGV 06.16 B</b>	16	<b>MGV 06.25 B</b>	25
size "44.27"	<b>CGV 06.21 B</b>	21	<b>MGV 06.32 B</b>	32
size "44.27"	<b>CGV 06.29 B</b>	29	<b>MGV 06.40 B</b>	40
size "44.27"				<b>CGC 06 B</b>

dimensions in mm

**CGO/MGO..B and CGV/MGV..B**

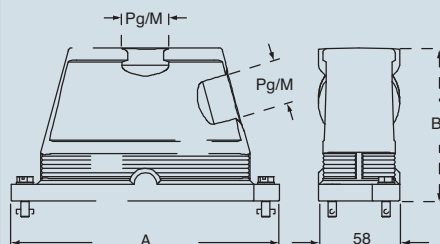

part	A	B
<b>CGO/MGO and CGV/MGV 06 B</b>	133	101

dimensions in mm

**CGC..B**

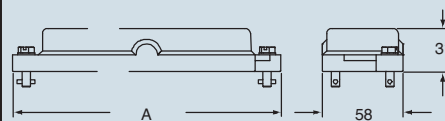

part	A
<b>CGC 06 B</b>	133

**CAUS**® Type 4/4X/12

dimensions shown are not binding and may be changed without notice

Special enclosures

inserts:		page
CDD	42 poles + ⊕	61
CQE	18 poles + ⊕	81
CSH	10 poles + ⊕	89
CCE	10 poles + ⊕	96
CNE, CSE, JCNE, JCSE	10 poles + ⊕	97 and 107
CSS	10 poles + ⊕	119
CMSE	3+2 (aux) poles + ⊕	135
CMCE	3+2 (aux) poles + ⊕	134
CX	8/24 poles + ⊕	151
MIXO	3 modules	156÷195

insert centre distance:  
57 x 27 mm

**bulkhead mounting housings**

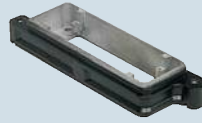

IP69K (compliant with DIN 40050-9)

**surface mounting housings**



IP69K (compliant with DIN 40050-9)

description	part no.	part no.		part no.	
		entry Pg	entry M	entry Pg	entry M
size "57.27"	<b>CGI 10</b>				
size "57.27"		<b>CGP 10.29</b>	29	<b>MGP 10.32</b>	32

panel cut-out for bulkhead mounting housings in mm

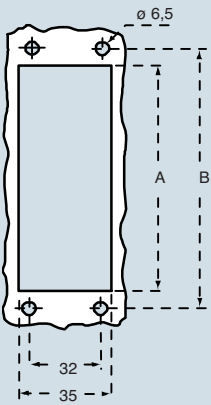

part	A	B
CGI 10	65	83

dimensions in mm

**CGI**

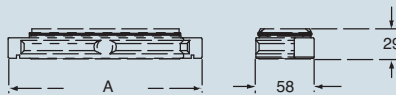

part	A
CGI 10	146

dimensions in mm

**CGP and MGP**

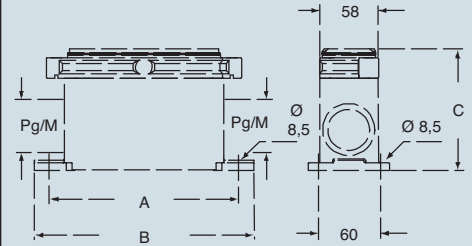

part	A	B	C
CGP 10 - MGP 10	140	169	110

special enclosures

**CAUS**® Type 4/4X/12

dimensions shown are not binding and may be changed without notice

inserts:		page
<b>CDD</b> .....	42 poles + ⊕	61
<b>CQE</b> .....	18 poles + ⊕	81
<b>CSH</b> .....	10 poles + ⊕	89
<b>CCE</b> .....	10 poles + ⊕	96
<b>CNE, CSE, JCNE, JCSE</b>	10 poles + ⊕	97 and 107
<b>CSS</b> .....	10 poles + ⊕	119
<b>CMSE</b> .....	3+2 (aux) poles + ⊕	135
<b>CMCE</b> .....	3+2 (aux) poles + ⊕	134
<b>CX</b> .....	8/24 poles + ⊕	151
<b>MIXO</b> .....	3 modules	156÷195

insert centre distance:  
57 x 27 mm

hoods



IP69K (compliant with DIN 40050-9)

covers



IP69K (compliant with DIN 40050-9)

description	hoods		covers	
	part no.	entry Pg	part no.	entry M
with side entry				
size "57.27"	<b>CGO 10.16</b>	16	<b>MGO 10.25</b>	25
size "57.27"	<b>CGO 10.21</b>	21	<b>MGO 10.32</b>	32
size "57.27"	<b>CGO 10.29</b>	29		
with top entry				
size "57.27"	<b>CGV 10.16</b>	16	<b>MGV 10.25</b>	25
size "57.27"	<b>CGV 10.21</b>	21	<b>MGV 10.32</b>	32
size "57.27"	<b>CGV 10.29</b>	29	<b>MGV 10.40</b>	40
size "57.27"				<b>CGC 10</b>

dimensions in mm

CGO/MGO and CGV/MGV

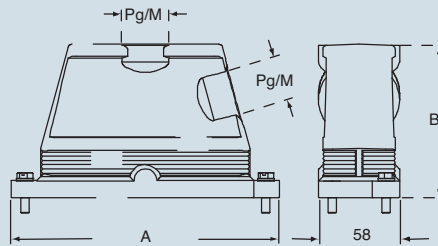

part	A	B
<b>CGO/MGO and CGV/MGV 10</b>	146	101

dimensions in mm

CGC

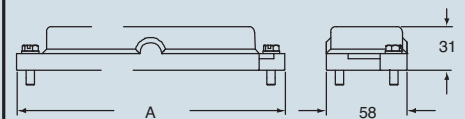

part	A
<b>CGC 10</b>	146

**CALUS**® Type 4/4X/12

dimensions shown are not binding and may be changed without notice

inserts:		page
CDD .....	42 poles + ⊕	61
CQE .....	18 poles + ⊕	81
CSH .....	10 poles + ⊕	89
CCE .....	10 poles + ⊕	96
CNE, CSE, JCNE, JCSE	10 poles + ⊕	97 and 107
CSS .....	10 poles + ⊕	119
CMSE .....	3+2 (aux) poles + ⊕	135
CMCE .....	3+2 (aux) poles + ⊕	134
CX .....	8/24 poles + ⊕	151
MIXO .....	3 modules	156÷195

insert centre distance:  
57 x 27 mm

**bulkhead mounting housings**



IP69K (compliant with DIN 40050-9)

description

part no.

size "57.27"

**CGI 10 B**

panel cut-out for bulkhead mounting housings in mm

dimensions in mm

**CGI..B**

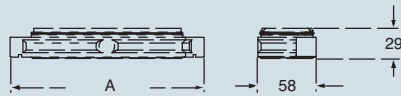
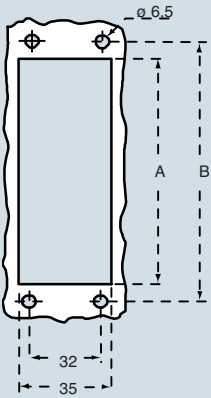

part	A	B
<b>CGI 10 B</b>	65	83

part	A
<b>CGI 10 B</b>	146

special enclosures

**CALUS**® Type 4/4X/12

dimensions shown are not binding  
and may be changed without notice

inserts:		page
<b>CDD</b> .....	42 poles + ⊕	61
<b>CQE</b> .....	18 poles + ⊕	81
<b>CSH</b> .....	10 poles + ⊕	89
<b>CCE</b> .....	10 poles + ⊕	96
<b>CNE, CSE, JCNE, JCSE</b>	10 poles + ⊕	97 and 107
<b>CSS</b> .....	10 poles + ⊕	119
<b>CMSE</b> .....	3+2 (aux) poles + ⊕	135
<b>CMCE</b> .....	3+2 (aux) poles + ⊕	134
<b>CX</b> .....	8/24 poles + ⊕	151
<b>MIXO</b> .....	3 modules	156÷195

insert centre distance:  
**57 x 27 mm**

**hoods**



IP69K (compliant with DIN 40050-9)

**covers**



description	part no.		part no.		part no.
		entry Pg		entry M	
with side entry					
size "57.27"	<b>CGO 10.16 B</b>	16	<b>MGO 10.25 B</b>	25	
size "57.27"	<b>CGO 10.21 B</b>	21	<b>MGO 10.32 B</b>	32	
size "57.27"	<b>CGO 10.29 B</b>	29			
with top entry					
size "57.27"	<b>CGV 10.16 B</b>	16	<b>MGV 10.25 B</b>	25	
size "57.27"	<b>CGV 10.21 B</b>	21	<b>MGV 10.32 B</b>	32	
size "57.27"	<b>CGV 10.29 B</b>	29	<b>MGV 10.40 B</b>	40	
size "57.27"					<b>CGC 10 B</b>

dimensions in mm

**CGO/MGO..B and CGV/MGV..B**

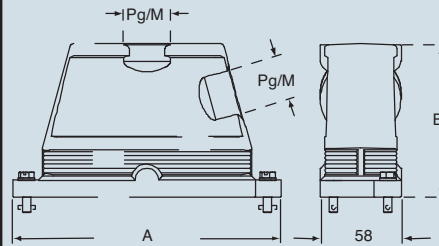

part	A	B
<b>CGO/MGO and CGV/MGV 10 B</b>	146	101

dimensions in mm

**CGC..B**

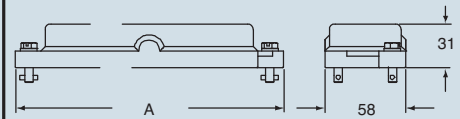

part	A
<b>CGC 10 B</b>	146

Special enclosures

**CAUS**® Type 4/4X/12

dimensions shown are not binding and may be changed without notice

inserts:		page
CD	40 poles + ⊕	49
CDD	72 poles + ⊕	62
CQE	32 poles + ⊕	82
CSH	16 poles + ⊕	90
CCE	16 poles + ⊕	98
CNE, CSE, JCNE, JCSE	16 poles + ⊕	99 and 108
CSS	16 poles + ⊕	120
CMSE	6+2 (aux) poles + ⊕	137
CMCE	6+2 (aux) poles + ⊕	136
CP	6 poles + ⊕	149
CX	6/36 and 12/2 poles + ⊕	152÷153
CX	4/0 and 4/2 poles + ⊕	154
MIXO	4 modules	156÷195

insert centre distance:  
77.5 x 27 mm

**bulkhead mounting housings**



IP69K (compliant with DIN 40050-9)

**surface mounting housings**



IP69K (compliant with DIN 40050-9)

description	part no.
size "77.27"	<b>CGI 16</b>
size "77.27"	

part no.	entry Pg	part no.	entry M
<b>CGP 16.36</b>	36	<b>MGP 16.40</b>	40

part no.	entry Pg	part no.	entry M
<b>CGP 16.36</b>	36	<b>MGP 16.40</b>	40

panel cut-out for bulkhead mounting housings in mm

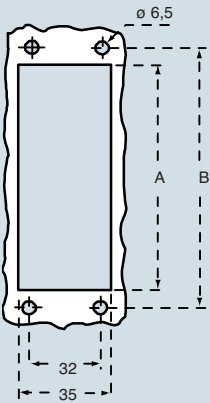

part	A	B
<b>CGI 16</b>	86	103

dimensions in mm

**CGI**



part	A
<b>CGI 16</b>	166

dimensions in mm

**CGP and MGP**

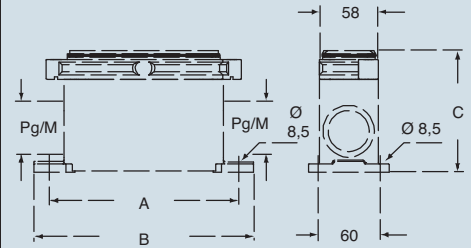

part	A	B	C
<b>CGP 16 - MGP 16</b>	160	189	121

special enclosures

**CAUS**® Type 4/4X/12

dimensions shown are not binding and may be changed without notice

inserts:		page
CD	40 poles + ⊕	49
CDD	72 poles + ⊕	62
CQE	32 poles + ⊕	82
CSH	16 poles + ⊕	90
CCE	16 poles + ⊕	98
CNE, CSE, JCNE, JCSE	16 poles + ⊕	99 and 108
CSS	16 poles + ⊕	120
CMSE	6+2 (aux) poles + ⊕	137
CMCE	6+2 (aux) poles + ⊕	136
CP	6 poles + ⊕	149
CX	6/36 and 12/2 poles + ⊕	152÷153
CX	4/0 and 4/2 poles + ⊕	154
MIXO	4 modules	156÷195

insert centre distance:  
77.5 x 27 mm

hoods



IP69K (compliant with DIN 40050-9)

covers



IP69K (compliant with DIN 40050-9)

description	part no.		part no.		part no.
	entry Pg	entry M	entry Pg	entry M	
with side entry					
size "77.27"	CGO 16.21	21	MGO 16.32	32	
size "77.27"	CGO 16.29	29	MGO 16.40	40	
size "77.27"	CGO 16.36	36	MGO 16.50	50	
with top entry					
size "77.27"			MGV 16.25	25	
size "77.27"			MGV 16.225	25x2	
size "77.27"	CGV 16.21	21	MGV 16.32	32	
size "77.27"	CGV 16.221	21x2			
size "77.27"	CGV 16.29	29	MGV 16.40	40	
size "77.27"	CGV 16.36	36	MGV 16.50	50	

size "77.27"

CGC 16

dimensions in mm

CGO/MGO and CGV/MGV

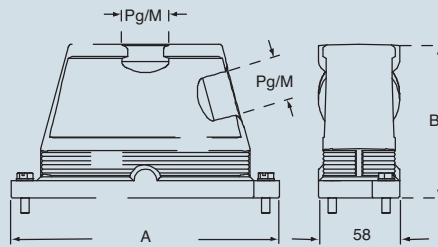

part	A	B
CGO/MGO and CGV/MGV 16	166	111

dimensions in mm

CGC

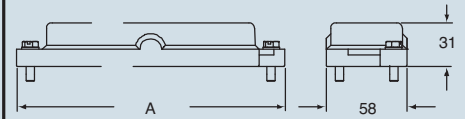

part	A
CGC 16	166

**ILME**® Type  
4/4X/12

dimensions shown are not binding  
and may be changed without notice

Special enclosures

inserts:		page
CD .....	40 poles + ⊕	49
CDD .....	72 poles + ⊕	62
CQE .....	32 poles + ⊕	82
CSH .....	16 poles + ⊕	90
CCE .....	16 poles + ⊕	98
CNE, CSE, JCNE, JCSE.	16 poles + ⊕	99 and 108
CSS .....	16 poles + ⊕	120
CMSE .....	6+2 (aux) poles + ⊕	137
CMCE .....	6+2 (aux) poles + ⊕	137
CP .....	6 poles + ⊕	149
CX .....	6/36 and 12/2 poles + ⊕	152÷153
CX .....	4/0 and 4/2 poles + ⊕	154
MIXO .....	4 modules	156÷195

insert centre distance:  
77.5 x 27 mm

**bulkhead mounting housings**



IP69K (compliant with DIN 40050-9)

description	part no.
-------------	----------

size "77.27"	<b>CGI 16 B</b>
--------------	-----------------

panel cut-out for bulkhead mounting housings in mm	dimensions in mm
--	------------------

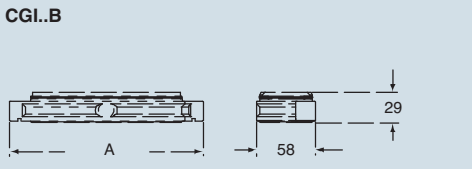
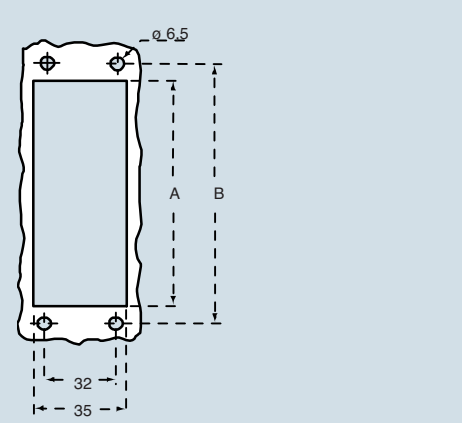

part	A
<b>CGI 16 B</b>	166

part	A	B
<b>CGI 16 B</b>	86	103

special enclosures

**CAUS**® Type 4/4X/12

dimensions shown are not binding and may be changed without notice



inserts:		page
CD	40 poles + ⊕	49
CDD	72 poles + ⊕	62
CQE	32 poles + ⊕	82
CSH	16 poles + ⊕	90
CCE	16 poles + ⊕	98
CNE, CSE, JCNE, JCSE	16 poles + ⊕	99 and 108
CSS	16 poles + ⊕	120
CMSE	6+2 (aux) poles + ⊕	137
CMCE	6+2 (aux) poles + ⊕	136
CP	6 poles + ⊕	149
CX	6/36 and 12/2 poles + ⊕	152÷153
CX	4/0 and 4/2 poles + ⊕	154
MIXO	4 modules	156÷195

insert centre distance:  
77.5 x 27 mm

hoods



IP69K (compliant with DIN 40050-9)

covers



IP69K (compliant with DIN 40050-9)

description	part no.		part no.		part no.
	entry Pg		entry M		
with side entry					
size "77.27"		<b>CGO 16.21 B</b>	21	<b>MGO 16.32 B</b>	32
size "77.27"		<b>CGO 16.29 B</b>	29	<b>MGO 16.40 B</b>	40
size "77.27"		<b>CGO 16.36 B</b>	36	<b>MGO 16.50 B</b>	50
with top entry					
size "77.27"				<b>MGV 16.25 B</b>	25
size "77.27"				<b>MGV 16,225 B</b>	25x2
size "77.27"		<b>CGV 16.21 B</b>	21	<b>MGV 16.32 B</b>	32
size "77.27"		<b>CGV 16,221 B</b>	21x2		
size "77.27"		<b>CGV 16.29 B</b>	29	<b>MGV 16.40 B</b>	40
size "77.27"		<b>CGV 16.36 B</b>	36	<b>MGV 16.50 B</b>	50
size "77.27"					<b>CGC 16 B</b>

dimensions in mm

**CGO/MGO..B and CGV/MGV..B**

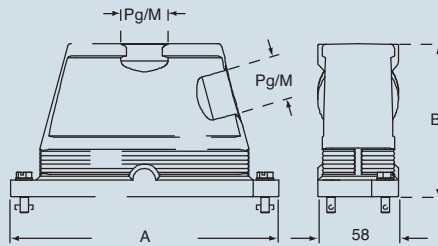

part	A	B
<b>CGO/MGO and CGV/MGV 16 B</b>	166	111

dimensions in mm

**CGC..B**

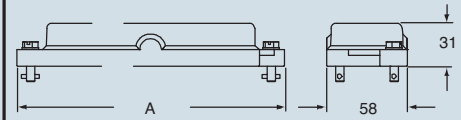

part	A
<b>CGC 16 B</b>	166

**CAUS**® Type 4/4X/12

dimensions shown are not binding and may be changed without notice

Special enclosures



inserts:		page
CD	64 poles + ⊕	51
CDD	108 poles + ⊕	64
CQE	46 poles + ⊕	83
CSH	24 poles + ⊕	91
CCE	24 poles + ⊕	100
CNE, CSE, JCNE, JCSE	24 poles + ⊕	101 and 109
CSS	24 poles + ⊕	121
CMSE	10+2 (aux) poles + ⊕	139
CMCE	10+2 (aux) poles + ⊕	138
CX	4/8 poles + ⊕	155
MIXO	6 modules	156÷195

insert centre distance:  
104 x 27 mm

**bulkhead mounting housings**

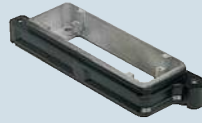

IP69K (compliant with DIN 40050-9)

**surface mounting housings**



IP69K (compliant with DIN 40050-9)

description	part no.	part no.		part no.	
		entry Pg	entry M	entry Pg	entry M
size "104.27"	<b>CGI 24</b>				
size "104.27"		<b>CGP 24.36</b>	36	<b>MGP 24.40</b>	40
size "104.27"		<b>CGP 24.236</b>	36 x 2	<b>MGP 24.240</b>	40 x 2

panel cut-out for bulkhead mounting housings in mm

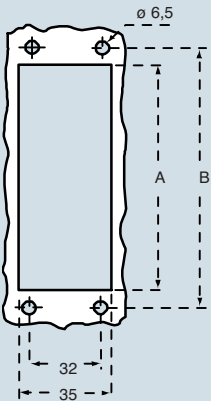

part	A	B
CGI 24	112	130

dimensions in mm

**CGI**



part	A
CGI 24	193

dimensions in mm

**CGP and MGP**

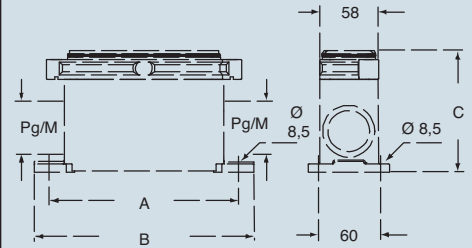

part	A	B	C
CGP 24 - MGP 24	187	216	121

special enclosures



dimensions shown are not binding  
and may be changed without notice

inserts:		page
CD .....	64 poles + ⊕	51
CDD .....	108 poles + ⊕	64
CQE .....	46 poles + ⊕	83
CSH .....	24 poles + ⊕	91
CCE .....	24 poles + ⊕	100
CNE, CSE, JCNE, JCSE	24 poles + ⊕	101 and 109
CSS .....	24 poles + ⊕	121
CMSE .....	10+2 (aux) poles + ⊕	139
CMCE .....	10+2 (aux) poles + ⊕	138
CX .....	4/8 poles + ⊕	155
MIXO .....	6 modules	156÷195

insert centre distance:  
104 x 27 mm

hoods



IP69K (compliant with DIN 40050-9)

covers



IP69K (compliant with DIN 40050-9)

description	hoods		covers	
	part no.	entry Pg	part no.	entry M
with side entry				
size "104.27"	<b>CGO 24.21</b>	21	<b>MGO 24.32</b>	32
size "104.27"	<b>CGO 24.29</b>	29	<b>MGO 24.40</b>	40
size "104.27"	<b>CGO 24.36</b>	36	<b>MGO 24.50</b>	50
with top entry				
size "104.27"	<b>CGV 24.21</b>	21	<b>MGV 24.325</b>	25x3
size "104.27"			<b>MGV 24.32</b>	32
size "104.27"			<b>MGV 24.232</b>	32x2
size "104.27"	<b>CGV 24.29</b>	29	<b>MGV 24.40</b>	40
size "104.27"	<b>CGV 24.229</b>	29x2	<b>MGV 24.240</b>	40x2
size "104.27"	<b>CGV 24.36</b>	36	<b>MGV 24.50</b>	50

size "104.27"

dimensions in mm

CGO/MGO and CGV/MGV

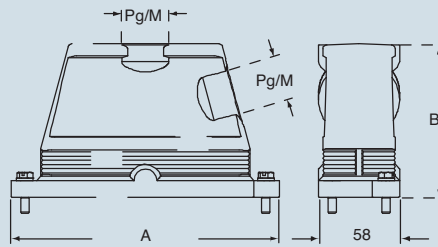

part	A	B
<b>CGO/MGO and CGV/MGV 24</b>	193	111

CGC 24

dimensions in mm

CGC

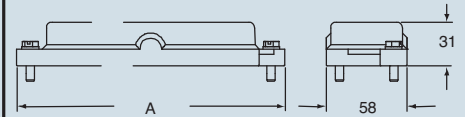

part	A
<b>CGC 24</b>	193

**CAUS** Type 4/4X/12

dimensions shown are not binding and may be changed without notice

Special enclosures



inserts:		page
CD	64 poles + ⊕	51
CDD	108 poles + ⊕	64
CQE	46 poles + ⊕	83
CSH	24 poles + ⊕	91
CCE	24 poles + ⊕	100
CNE, CSE, JCNE, JCSE	24 poles + ⊕	101 and 109
CSS	24 poles + ⊕	121
CMSE	10+2 (aux) poles + ⊕	139
CMCE	10+2 (aux) poles + ⊕	138
CX	4/8 poles + ⊕	155
MIXO	6 modules	156÷195

insert centre distance:  
104 x 27 mm

**bulkhead mounting housings**

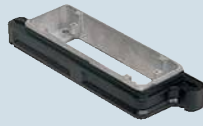

IP69K (compliant with DIN 40050-9)

description

part no.

size "104.27"

**CGI 24 B**

panel cut-out for bulkhead mounting housings in mm

dimensions in mm

**CGI..B**

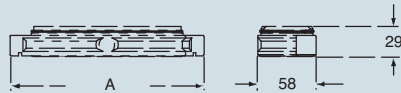
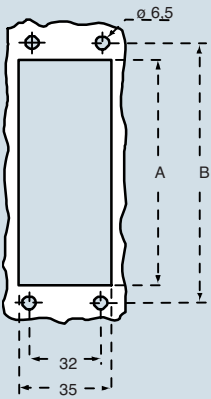

part	A
<b>CGI 24 B</b>	193

part	A	B
<b>CGI 24 B</b>	112	130

**CAUS**® Type 4/4X/12

dimensions shown are not binding  
and may be changed without notice

special enclosures

inserts:		page
<b>CD</b> .....	64 poles + ⊕	51
<b>CDD</b> .....	108 poles + ⊕	64
<b>CQE</b> .....	46 poles + ⊕	83
<b>CSH</b> .....	24 poles + ⊕	91
<b>CCE</b> .....	24 poles + ⊕	100
<b>CNE, CSE, JCNE, JCSE</b> .....	24 poles + ⊕	101 and 109
<b>CSS</b> .....	24 poles + ⊕	121
<b>CMSE</b> .....	10+2 (aux) poles + ⊕	139
<b>CMCE</b> .....	10+2 (aux) poles + ⊕	138
<b>CX</b> .....	4/8 poles + ⊕	155
<b>MIXO</b> .....	6 modules	156÷195

insert centre distance:  
**104 x 27 mm**

**hoods**



IP69K (compliant with DIN 40050-9)

**covers**



IP69K (compliant with DIN 40050-9)

description	hoods		covers	
	part no.	entry Pg	part no.	entry M
with side entry				
size "104.27"	<b>CGO 24.21 B</b>	21	<b>MGO 24.32 B</b>	32
size "104.27"	<b>CGO 24.29 B</b>	29	<b>MGO 24.40 B</b>	40
size "104.27"	<b>CGO 24.36 B</b>	36	<b>MGO 24.50 B</b>	50
with top entry				
size "104.27"	<b>CGV 24.21 B</b>	21	<b>MGV 24,325 B</b>	25x3
size "104.27"			<b>MGV 24.32 B</b>	32
size "104.27"			<b>MGV 24,232 B</b>	32x2
size "104.27"	<b>CGV 24.29 B</b>	29	<b>MGV 24.40 B</b>	40
size "104.27"	<b>CGV 24,229 B</b>	29x2	<b>MGV 24,240 B</b>	40x2
size "104.27"	<b>CGV 24.36 B</b>	36	<b>MGV 24.50 B</b>	50
size "104.27"				<b>CGC 24 B</b>

dimensions in mm

**CGO/MGO..B and CGV/MGV..B**

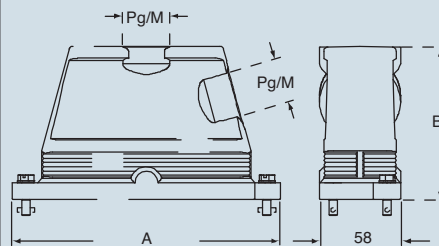

part	A	B
<b>CGO/MGO and CGV/MGV 24 B</b>	193	111

dimensions in mm

**CGC..B**

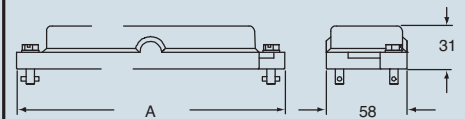

part	A
<b>CGC 24 B</b>	193

**CAUS**® Type 4/4X/12

dimensions shown are not binding and may be changed without notice

Special enclosures



bulkhead mounting housings:

- size "44.27".....page 374-377
- size "57.27".....page 378-381
- size "77.27".....page 382-385
- size "104.27".....page 386-389

frames for bulkhead mounting housings

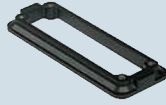

description	part no.
size "44.27"	<b>CG 06 FL</b>
size "57.27"	<b>CG 10 FL</b>
size "77.27"	<b>CG 16 FL</b>
size "104.27"	<b>CG 24 FL</b>

dimensions in mm

CG..FL

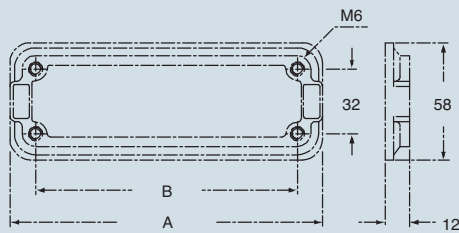

part no.	A	B
<b>CG 06 FL</b>	96	70
<b>CG 10 FL</b>	109	83
<b>CG 16 FL</b>	129	103
<b>CG 24 FL</b>	156	130

special enclosures

**CAUS**® Type 4/4X/12

dimensions shown are not binding and may be changed without notice