



inserts:		page
CD	15 poles + ⊕	47
CDA	10 poles + ⊕	72
CDC	10 poles + ⊕	73
MIXO	1 module	156+195

bulkhead mounting housings with single lever



surface mounting housings with single lever



description	part no.		part no.		entry	
					Pg	M
with single lever	CZI 15 L					
with lever and cover	CZI 15 LS					
with single lever			CZP 15 L	16		
with single lever			CZP 15 L2	16 x 2	MZP 15 L225	25 x 2
with single lever			CZP 15 L21	21	MZP 15 L25	25
with lever and cover			CZP 15 LS221	21 x 2	MZP 15 LS225	25 x 2

panel cut-out for bulkhead mounting housings in mm

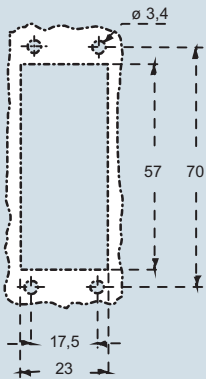

NB: the enclosures ensure IP66 protection (or IP65 for cover versions) rating when mated and locked with the closing levers.

dimensions in mm

CZI L

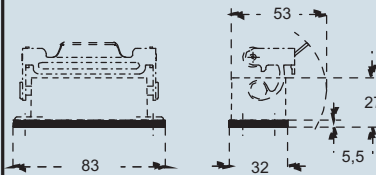

CZI LS

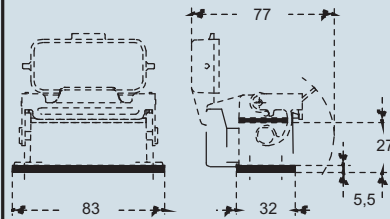

dimensions in mm

CZP L and MZP L

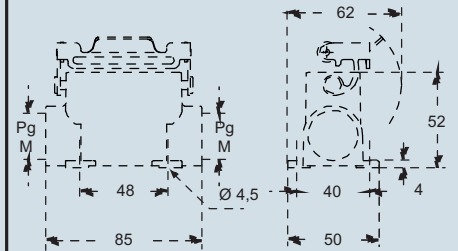

CZP LS and MZP LS

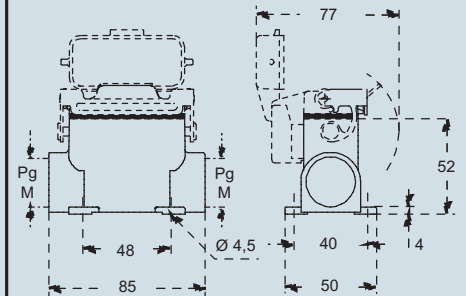

CAVUS® Type 4/4X/12



dimensions shown are not binding and may be changed without notice

inserts:		page
CD	15 poles + ⊕	47
CDA	10 poles + ⊕	72
CDC	10 poles + ⊕	73
MIXO	1 module	156+195

Cover versions L and LG cannot be used together with coding pins. If this application is required, please contact ILME SpA.

hoods with 2 pegs

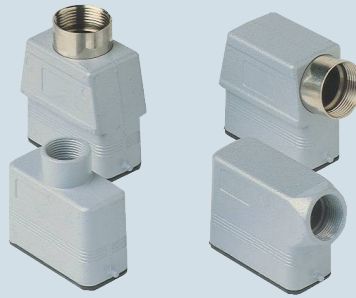

covers

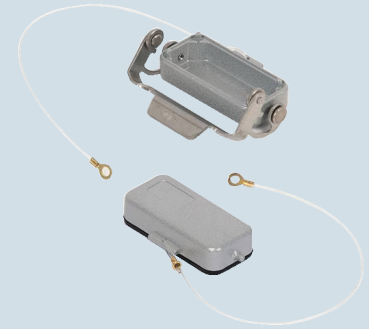

description	part no.	entry Pg	part no.	entry M	part no.
with pegs, side entry	CZO 15 L	16	MZO 15 L20	20	
with pegs, side entry			MZO 15 L25	25	
with pegs, side entry, high construction	CZAO 15 L16	16	MZAO 15 L20	20	
with pegs, side entry, high construction	CZAO 15 L21	21	MZAO 15 L25	25	
with pegs, top entry	CZV 15 L	13.5	MZV 15 L20	20	
with pegs, top entry, high construction	CZAV 15 L16	16	MZAV 15 L20	20	
with pegs, top entry, high construction	CZAV 15 L21	21	MZAV 15 L25	25	
with pegs, side entry, high construction, without adaptor *	CZFO 15 L16	16	MZFO 15 L20	20	
with pegs, side entry, high construction, without adaptor *	CZFO 15 L21	21	MZFO 15 L25	25	
with pegs, top entry, high construction, without adaptor *	CZFV 15 L16	16	MZFV 15 L20	20	
with pegs, top entry, high construction, without adaptor *	CZFV 15 L21	21	MZFV 15 L25	25	
with pegs (for 1 lever enclosures)					CZC 15 L
with single lever (for enclosures with pegs)					CZC 15 LG

* enclosure without adaptor, threaded on the body, to enclosure to be used only with a complete cable gland.

dimensions in mm

CZO L and MZO L

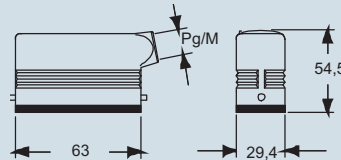

CZAO L - MZAO L and CZAV L - MZAV L

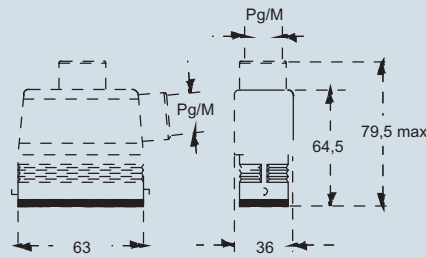

CZV L and MZV L

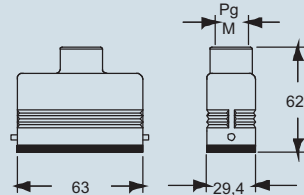

CZFO L - MZFO L and CZFV L - MZFV L

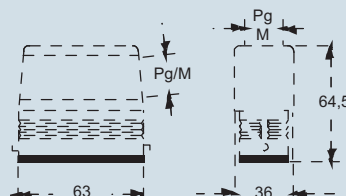

dimensions in mm

CZC L

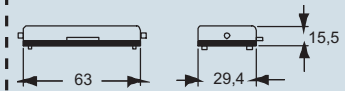

CZC LG

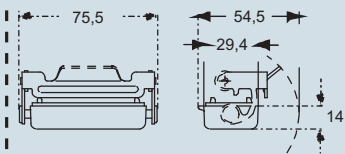

CAVUS Type 4/4X/12



dimensions shown are not binding and may be changed without notice



inserts:		page
CD	15 poles + ⊕	47
CDA	10 poles + ⊕	72
CDC	10 poles + ⊕	73
MIXO	1 module	156+195

hoods with single lever



NEW

covers



Cover versions L and LG cannot be used together with coding pins. If this application is required, please contact ILME SpA.

description	part no.	entry Pg	part no.	entry M	part no.
	with lever, top entry	CZV 15 LG	13.5	MZV 15 LG20	20
with pegs (for 1 lever enclosures)					CZC 15 L

dimensions in mm

CZV LG and MZV LG

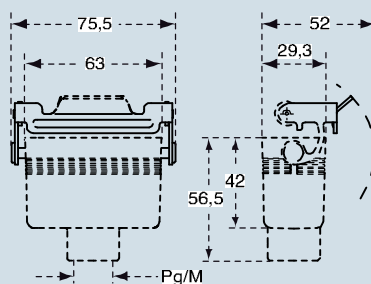

CZC L



CALUS® Type 4/4X/12



dimensions shown are not binding and may be changed without notice

C-TYPE - size 49.16



inserts:		page
CD	25 poles + ⊕	48
CDD	38 poles + ⊕	60
CDA	16 poles + ⊕	74
CDC	16 poles + ⊕	75

bulkhead mounting housings with single lever



surface mounting housings with single lever



description	part no.		entry	
			Pg	M
with simple lever	CZI 25 L			
with lever and cover	CZI 25 LS			
with simple lever, high construction			CZAP 25 L	16
with simple lever, high construction			CZAP 25 L2	16 x 2
with simple lever, high construction			CZAP 25 L21	21
with simple lever and cover, high			CZAP 25LS221	21 x 2
			MZAP 25 L225	25 x 2
			MZAP 25 L25	25
			MZAP 25LS225	25 x 2

panel cut-out for bulkhead mounting housings in mm

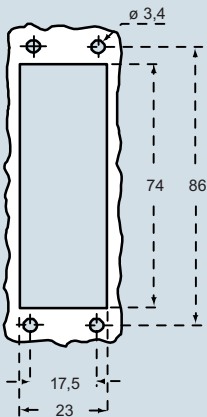

NB: the enclosures ensure IP66 protection (or IP65 for cover versions) rating when mated and locked with the closing levers.

dimensions in mm

CZI L

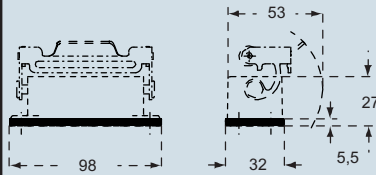

CZI LS

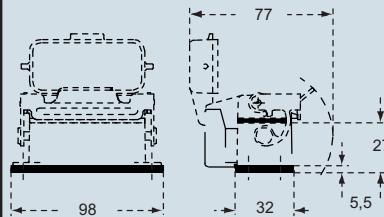

dimensions in mm

CZAP L and MZAP L

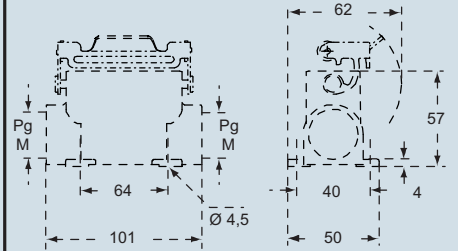

CZAP LS and MZAP LS

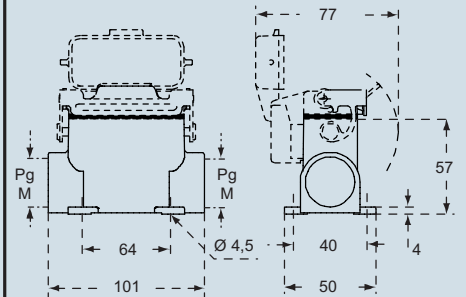

CALUS® Type 4/4X/12



dimensions shown are not binding and may be changed without notice



inserts:		page
CD	25 poles + ⊕	48
CDD	38 poles + ⊕	60
CDA	16 poles + ⊕	74
CDC	16 poles + ⊕	75

hoods with 2 pegs



hoods with 2 pegs, double top entry



Cover versions L and LG cannot be used together with coding pins. If this application is required, please contact ILME SpA.

description	hoods with 2 pegs		hoods with 2 pegs, double top entry	
	part no.	entry Pg	part no.	entry M
with pegs, side entry	CZO 25 L	16	MZO 25 L20	20
with pegs, side entry			MZO 25 L25	25
with pegs, side entry, high construction	CZAO 25 L16	16	MZAO 25 L20	20
with pegs, side entry, high construction	CZAO 25 L21	21	MZAO 25 L25	25
with pegs, top entry	CZV 25 L	16	MZV 25 L20 **	20
with pegs, top entry, high construction	CZAV 25 L16	16	MZAV 25 L20	20
with pegs, top entry, high construction	CZAV 25 L21	21	MZAV 25 L25	25
with pegs, side entry, high construction, without adaptor	CZFO 25 L16	16	MZFO 25 L20	20
with pegs, side entry, high construction, without adaptor	CZFO 25 L21	21	MZFO 25 L25	25
with pegs, top entry, high construction, without adaptor	CZFV 25 L16	16	MZFV 25 L20	20
with pegs, top entry, high construction, without adaptor	CZFV 25 L21	21	MZFV 25 L25	25
with pegs for 1 lever			CZAV 25 L216	16 x 2
			MZAV 25 L220	20 x 2
with pegs for 1 lever, without adaptor *			CZFV 25 L216	16 x 2
			MZFV 25 L220	20 x 2

* enclosure without adaptor, threaded on the body, to be used only with a complete cable gland.

** can only be used with a complete cable gland (to be purchased separately)

dimensions in mm

CZO L e MZO L

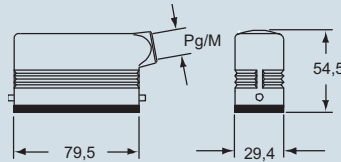

CZAO L - MZAO L and CZAV L - MZAV L

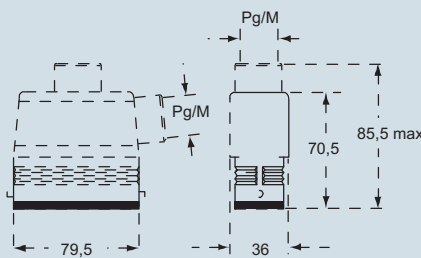

CZV L and MZV L

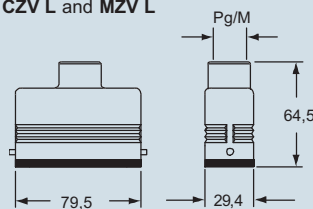

CZFO L - MZFO L and CZFV L - MZFV L



dimensions in mm

CZAV/CZFV L2 and (MZAV)/MZFV L2

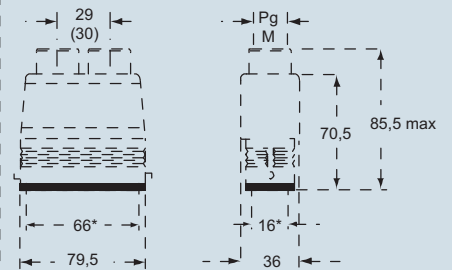

CAIUS® Type 4/4X/12



dimensions shown are not binding and may be changed without notice

C-TYPE - size 66.16

inserts:		page
CD	25 poles + ⊕	48
CDD	38 poles + ⊕	60
CDA	16 poles + ⊕	74
CDC	16 poles + ⊕	75

hoods with single lever



NEW

covers

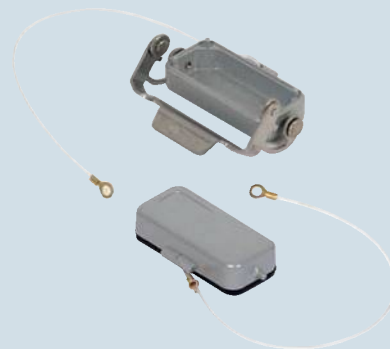

Cover versions L and LG cannot be used together with coding pins. If this application is required, please contact ILME SpA.

description	part no.	entry Pg	part no.	entry M	part no.
with lever, top entry	CZV 25 LG	16	MZV 25 LG20	20	
with pegs (for 1 lever enclosures)					CZC 25 L
with simple lever (for enclosures with pegs)					CZC 25 LG

dimensions in mm

CZV LG and MZV LG

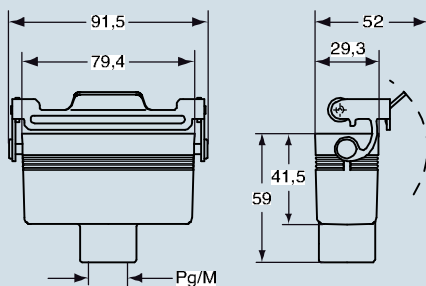

CZAO L - MZAO L and CZAV L - MZAV L

dimensions in mm

CZC L



CZC LG

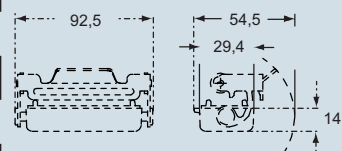

CALUS Type 4/4X/12



dimensions shown are not binding and may be changed without notice

C-TYPE - size 66.16





inserts:		page
CD	50 poles + ⊕	50
CDD	76 poles + ⊕	63
CDA	32 poles + ⊕	76
CDC	32 poles + ⊕	77

insert dimensions:
2 x (66 x 16) mm

bulkhead mounting housings with 2 levers or 4 pegs



surface mounting housings with 2 levers or 4 pegs



description	part no.		entry Pg		part no.		entry M	
	with levers	CHI 50						
with pegs and cover ¹⁾	CHI 50 CS							
with levers			CHP 50.21	21	MHP 50.32	32		
with levers			CHP 50.221	21 x 2	MHP 50.232	32 x 2		
with levers			CHP 50.29	29	MHP 50.40	40		
with levers			CHP 50.229	29 x 2	MHP 50.240	40 x 2		
with pegs and cover ¹⁾			CHP 50 CS	21	MHP 50 CS32	32		
with pegs and cover ¹⁾			CHP 50 CS2	21 x 2	MHP 50 CS232	32 x 2		
with pegs and cover ¹⁾			CHP 50 CS29	29	MHP 50 CS40	40		
with pegs and cover ¹⁾			CHP 50 CS229	29 x 2	MHP 50 CS240	40 x 2		

¹⁾ may be combined with enclosures:
- CHO/CAO 50 X and CAV 50 X
- MHO/MAO/MFO 50 X and MAV/MFV 50 X

NB: the enclosures ensure IP66 protection (or IP65 for cover versions) rating when mated and locked with the closing levers.
The cover (CS, CP) only ensures mechanical protection, but does not ensure IP65 protection rating.

panel cut-out for bulkhead mounting housings in mm

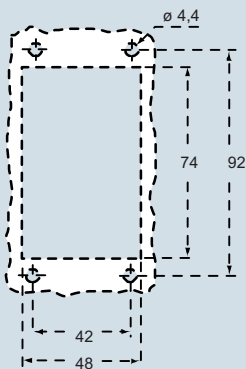

dimensions in mm

CHI

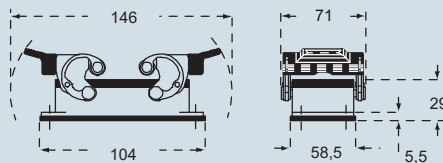

CHI CS

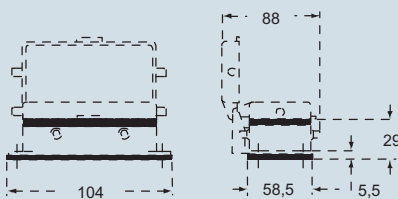

dimensions in mm

CHP and MHP

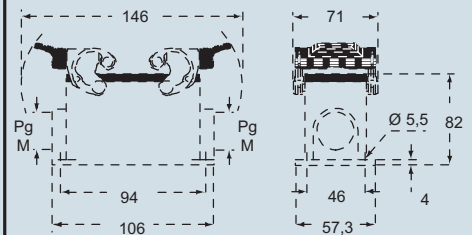

CHP CS and MHP CS

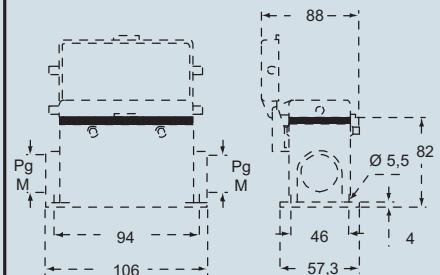

CALUS® Type 4/4X/12



dimensions shown are not binding and may be changed without notice

C-TYPE - size 66.40



inserts:		page
CD	50 poles + ⊕	50
CDD	76 poles + ⊕	63
CDA	32 poles + ⊕	76
CDC	32 poles + ⊕	77

insert dimensions:
2 x (66 x 16) mm

hoods with 4 pegs



hoods with 2 levers or 4 pegs



description	hoods with 4 pegs		hoods with 2 levers or 4 pegs	
	part no.	entry Pg	part no.	entry M
with pegs, side entry	CHO 50	21	MHO 50.25	25
with pegs, side entry			MHO 50.32	32
with pegs, side entry, high construction	CAO 50.21	21	MAO 50.25	25
with pegs, side entry, high construction	CAO 50.29	29	MAO 50.32	32
with pegs, top entry, high construction			CAV 50.21	21
with pegs, top entry, high construction			CAV 50.29	29
with levers and gasket, top entry, high construction			CAV 50 G29	29
with levers and gasket, top entry, high construction			MAV 50.25	25
with levers and gasket, top entry, high construction			MAV 50.32	32
with levers and gasket, top entry, high construction			CAV 50 G29	29
with levers and gasket, top entry, high construction			MAV 50 G32	32
with pegs, side entry, high construction, without adaptor	CFO 50.21	21	MFO 50.25	25
with pegs, side entry, high construction, without adaptor	CFO 50.29	29	MFO 50.32	32
with pegs, top entry, high construction, without adaptor *			CFV 50.21	21
with pegs, top entry, high construction, without adaptor *			CFV 50.29	29
with pegs, top entry, high construction, without adaptor *			MFV 50.25	25
with pegs, top entry, high construction, without adaptor *			MFV 50.32	32
with levers and gasket, top entry, high, without adapter *			CFV 50 G29	29
with levers and gasket, top entry, high, without adapter *			MFV 50 G32	32

* enclosure without adaptor, threaded on the body, to be used only with a complete cable gland.

dimensions in mm

CHO (CAO/CFO) and MHO (MAO/MFO)

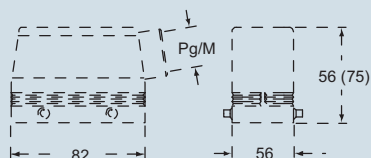

dimensions in mm

CAV (CFV) and MAV (MFV)

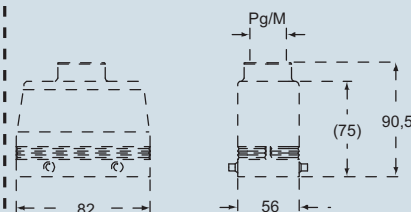

CAV G (CFV G) and MAV G (MFV G)

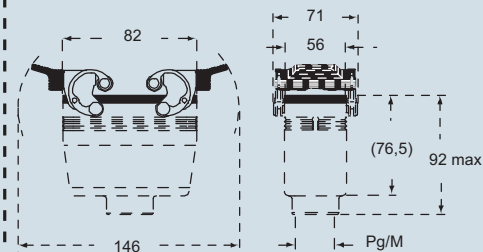

CALUS® Type 4/4X/12



dimensions shown are not binding and may be changed without notice

C-TYPE - size 66.40

inserts:		page
CD	50 poles + ⊕	50
CDD	76 poles + ⊕	63
CDA	32 poles + ⊕	76
CDC	32 poles + ⊕	77

insert dimensions:
2 x (66 x 16) mm

CHC 50 and CHC 50 G covers cannot be used together with coding pins. If this application is required, please contact ILME SpA.

hoods with 2 levers



covers

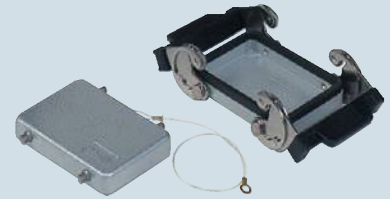

description	hoods with 2 levers		hoods with 2 levers		covers
	part no.	entry Pg	part no.	entry M	
with levers, side entry ¹⁾	CHO 50 X	21	MHO 50 X25	25	
with levers, side entry ¹⁾			MHO 50 X32	32	
with levers, side entry, high construction ¹⁾	CAO 50 X	21	MAO 50 X25	25	
with levers, side entry, high construction ¹⁾	CAO 50 X29	29	MAO 50 X32	32	
with levers, top entry, high construction ¹⁾	CAV 50 X	21	MAV 50 X25	25	
with levers, top entry, high construction ¹⁾	CAV 50 X29	29	MAV 50 X32	32	
with levers, side entry, high construction, without adaptor ^{1)*}	CFO 50 X	21	MFO 50 X25	25	
with levers, side entry, high construction, without adaptor ^{1)*}	CFO 50 X29	29	MFO 50 X32	32	
with levers, top entry, high construction, without adaptor ^{1)*}	CFV 50 X	21	MFV 50 X25	25	
with levers, top entry, high construction, without adaptor ^{1)*}	CFV 50 X29	29	MFV 50 X32	32	
with 4 pegs (for enclosures with 2 levers)					CHC 50
with 2 levers (for hoods with 4 pegs)					CHC 50 G

¹⁾ may be combined with enclosures:
- CHI 50 CS, CHP 50 CS and MHP 50 CS

* enclosure without adaptor, threaded on the body, to enclosure to be used only with a complete cable gland.

dimensions in mm

CHO X (CAO X/CFO X) and MHO X (MAO X/MFO X)

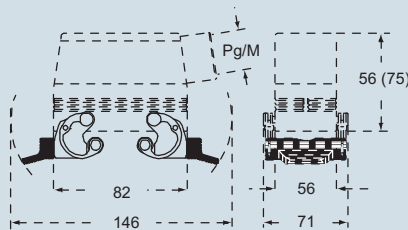

CAV X (CFV X) and MAV X (MFV X)

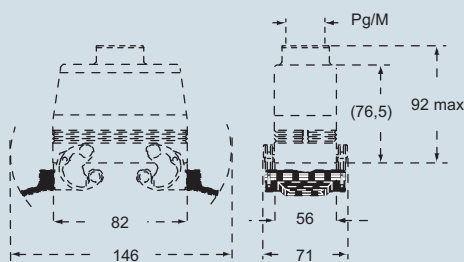

dimensions in mm

CHC

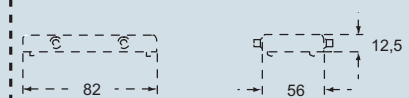

CHC G

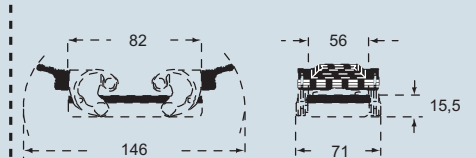

CAVUS Type 4/4X/12



dimensions shown are not binding and may be changed without notice