



inserts:		page
CK	3 poles + ⊕	40
CK	4 poles + ⊕	40
CKS	3 poles + ⊕	41
CKS	4 poles + ⊕	41
CD	7 poles + ⊕	45
CD	8 poles	46
CQ	5 poles + ⊕	69
CQ	12 poles + ⊕	68

insert dimensions:
21 x 21 mm

bulkhead mounting housings



angled bulkhead mounting housings



description	part no.	part no. (entry - Pg 11)	part no. (entry - M 20)
with lever	CK 03 I (white)		
with lever	CK 03 IN (black)		
without cable gland entry, with lever		CK 03 IA (white)	
without cable gland entry, with lever		CK 03 IAN (black)	
with cable gland entry and lever		CK 03 IAPS (white)	MK IAP20 (white)
with cable gland entry and lever		CK 03 IAPNS (black)	MK IAPN20 (black)
gasket and screw kit for IP66/IP67 ¹⁾ for CK, CQ 05, CKS inserts	CKR 65	CKR 65	
gasket and screw kit for IP66/IP67 ¹⁾ for CD 07/08 inserts	CKR 65 D	CKR 65 D	

panel cut-out for enclosures, in mm

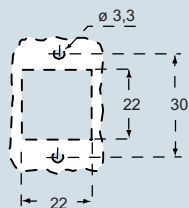

dimensions in mm

CK I(N)

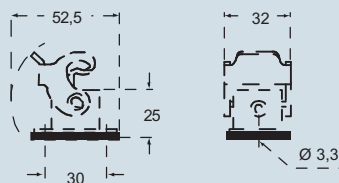

dimensions in mm

CK IA(N)

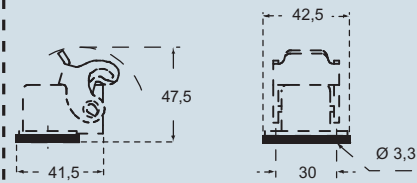

CK IAP(N)S and MK IAP(N)

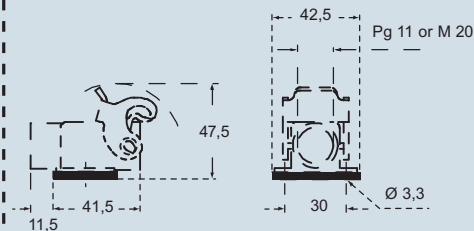

1) To obtain the protection rating IP66/IP67 a kit is provided that includes a gasket to fit under the insert fixing screws supplied with the kit (see illustrative example)
CQ 12 inserts are already supplied with a gasket and screw which ensure IP66/IP67 protection rating



CAVUS®
Type 12
Type 4/4X only
with CKR 65 (D)

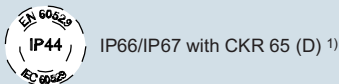

dimensions shown are not binding
and may be changed without notice

C-TYPE - size 21.21

inserts:	page
CK 3 poles + ⊕	40
CK 4 poles + ⊕	40
CKS 3 poles + ⊕	41
CKS 4 poles + ⊕	41
CD 7 poles + ⊕	45
CD 8 poles	46
CQ 5 poles + ⊕	69
CQ 12 poles + ⊕	68

insert dimensions:
21 x 21 mm



covers



description	part no. (entry - Pg 11)	part no. (entry - M 20)	part no.
with pegs, top entry	CK 03 VS (white)	MK V20 (white)	
with pegs, top entry	CK 03 VNS (black)	MK VN20 (black)	
with pegs, side entry	CK 03 VAS (white)	MK VA20 (white)	
with pegs, side entry	CK 03 VANS (black)	MK VAN20 (black)	
with lever, top entry	CK 03 VGS (white)	MK VG20 (white)	
with lever, top entry	CK 03 VGNS (black)	MK VGN20 (black)	
with pegs and gasket, for female inserts			CK 03 C (white)
with pegs and gasket, for female inserts			CK 03 CN (black)
with pegs, for male inserts			CK 03 CA (white)
with pegs, for male inserts			CK 03 CAN (black)
with lever and gasket, for female inserts			CK 03 CX (white)
with lever and gasket, for female inserts			CK 03 CXN (black)
with lever, for male inserts			CK 03 CXA (white)
with lever, for male inserts			CK 03 CXAN (black)
gasket and screw kit for IP66/IP67 ¹⁾ for CK, CQ 05, CKS inserts	CKR 65		
gasket and screw kit for IP66/IP67 ¹⁾ for CD 07/08 inserts	CKR 65 D		

1) To obtain the protection rating IP66/IP67 a kit is provided that includes a gasket to fit under the insert fixing screws supplied with the kit (see illustrative example)
CQ 12 inserts are already supplied with a gasket and screw which ensure IP66/IP67 protection rating

dimensions in mm

CK V(N)S and MK V(N)

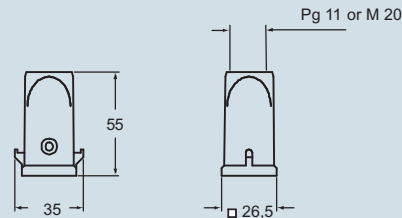

CK VA(N)S and MK VA(N)

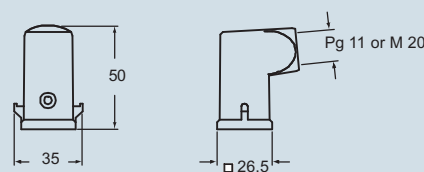

CK VG(N)S and MK VG(N)

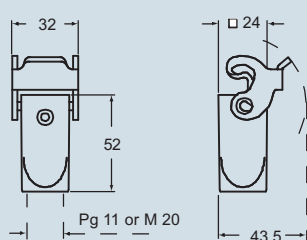

dimensions in mm

CK C(N)

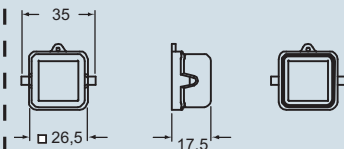

CK CA(N)

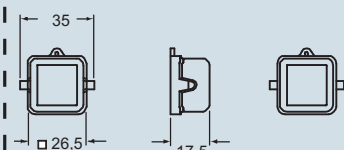

CK CX(N)

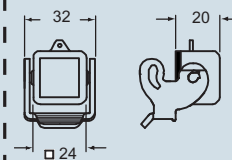

CK CXA(N)

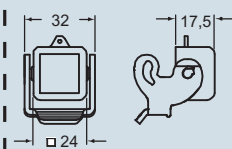

Type 12
Type 4/4X only
with CKR 65 (D)



IP66/IP67 with CKR 65 (D) ¹⁾

dimensions shown are not binding
and may be changed without notice

inserts:	page
CK 3 poles + ⊕	40 *
CK 4 poles + ⊕	40 *
CKS 3 poles + ⊕	41 *
CKS 4 poles + ⊕	41 *
CD 8 poles	46 *
CQ 5 poles + ⊕	69 *
CQ 12 poles + ⊕	68 *
CXL 2/4 SF.....	456 *
CXL 2/4 SM.....	456 *
CXL SF.....	456 *
CXL SM.....	456 *
CJ KF.....	441 *
CLK 04 SC.....	8

insert dimensions: 21 x 21 mm

* refer to catalogue page CN.12

bulkhead mounting housings with cover



**AVAILABLE
3rd QUARTER 2013**

description	part No.
with galvanised steel lever, for female inserts with galvanised steel lever, for male inserts	CKA 03 ILS CKA 03 ILSA
with stainless steel lever, for female inserts with stainless steel lever, for male inserts	CKAX 03 ILS CKAX 03 ILSA
gasket and screw kit for IP66/IP67 ¹⁾ for CK, CQ 05, CKS inserts	CKR 65
gasket and screw kit for IP66/IP67 ¹⁾ for CD 07/08 inserts	CKR 65 D
panel cut-out for enclosures, in mm	dimensions in mm
	<p>CKA ILS</p>
<p>1) To obtain the protection rating IP66/IP67 a kit is provided that includes a gasket to fit under the insert fixing screws supplied with the kit (see illustrative example). CQ 12 inserts are already supplied with a gasket and screw which ensure IP66/IP67 protection rating</p>	<p>CKA ILSA</p>
<p>Note: CXL, CJ K and CLK inserts are already supplied with seal and screw, which ensure IP66/IP67 protection rating.</p>	<p>CKAX ILS</p>
<p>Type 12 Type 4/4X only with CKR 65 (D)</p>	<p>CKAX ILSA</p>

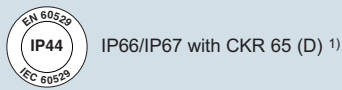

dimensions shown are not binding and may be changed without notice



inserts:		page
CK	3 poles + ⊕	40
CK	4 poles + ⊕	40
CKS	3 poles + ⊕	41
CKS	4 poles + ⊕	41
CD	8 poles	46
CQ	5 poles + ⊕	69
CQ	12 poles + ⊕	68

insert dimensions:
21 x 21 mm

bulkhead mounting housings



angled bulkhead mounting housings



description	part no.	part no. (entry - Pg 11)	part no. (entry - M 20)
with galvanised steel lever with stainless steel lever	CKA 03 I CKAX 03 I		
without cable gland, galvanized steel lever without cable gland, stainless steel lever		CKA 03 IA CKAX 03 IA	
with cable gland, galvanized steel lever with cable gland, stainless steel lever with cable gland, galvanized steel lever, bulkhead hole closed with cable gland, stainless steel lever, bulkhead hole closed		CKA 03 IAPS CKAX 03 IAPS CKA 03 APS CKAX 03 APS	MKA IAP20 MKAX IAP20 MKA AP20 MKAX AP20
gasket and screw kit for IP66/IP67 ¹⁾ for CK, CQ 05, CKS inserts	CKR 65	CKR 65	
gasket and screw kit for IP66/IP67 ¹⁾ for CD 07/08 inserts	CKR 65 D	CKR 65 D	

panel cut-out for enclosures, in mm

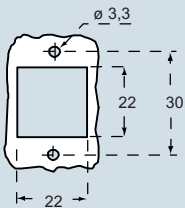

1) To obtain the protection rating IP66/IP67 a kit is provided that includes a gasket to fit under the insert fixing screws supplied with the kit (see illustrative example)
CQ 12 inserts are already supplied with a gasket and screw which ensure IP66/IP67 protection rating

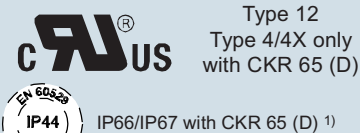
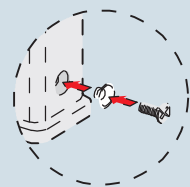

dimensions shown are not binding
and may be changed without notice

dimensions in mm

CKA I

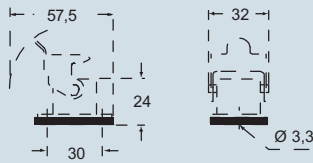

CKAX I

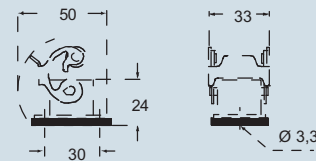

dimensions in mm

CKA IA

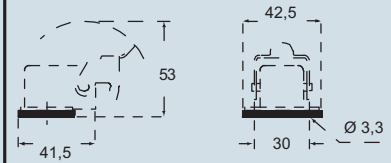

CKAX IA

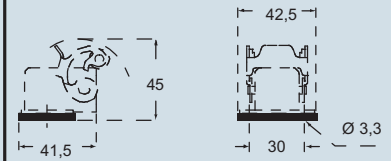

CKA IAPS (CKA APS) and MKA IAP (MKA AP)

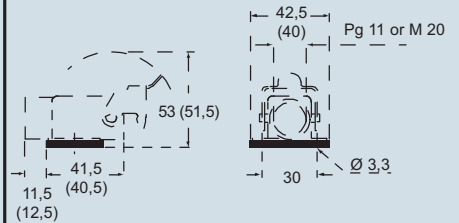

CKAX IAPS (CKAX APS) and MKAX IAP (MKAX AP)

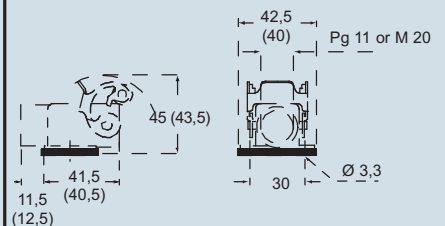

inserts:		page
CK	3 poles + ⊕	40
CK	4 poles + ⊕	40
CKS	3 poles + ⊕	41
CKS	4 poles + ⊕	41
CD	8 poles	46
CQ	5 poles + ⊕	69
CQ	12 poles + ⊕	68

insert dimensions:
21 x 21 mm

angled bulkhead mounting housings

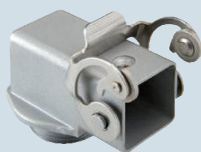

NEW

description	part no.
galvanized steel lever, M20 fixing thread (*)	MKA IAF20 ¹⁾
stainless steel lever, M20 fixing thread (*)	MKAX IAF20 ¹⁾
galvanized steel lever, M25 fixing thread (*)	MKA IAF25 ¹⁾
stainless steel lever, M25 fixing thread (*)	MKAX IAF25 ¹⁾
gasket and screw kit for IP66/IP67 ¹⁾ for CK, CQ 05, CKS inserts	CKR 65
gasket and screw kit for IP66/IP67 ¹⁾ for CD 07/08 inserts	CKR 65 D

panel cut-out

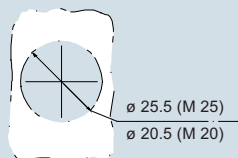

(*) locknut supplied on request, see catalogue cable glands (articles AS M20N and AS M25N metallic, AS M20L and AS M25L insulating)

1) To obtain the protection rating IP66/IP67 a kit is provided that includes a gasket to fit under the insert fixing screws supplied with the kit (see illustrative example)
CQ 12 inserts are already supplied with a gasket and screw which ensure IP66/IP67 protection rating

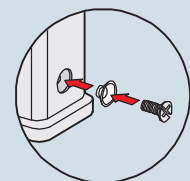

dimensions in mm

MKA IAF

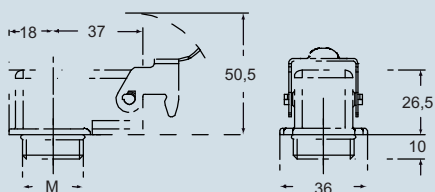

MKAX IAF

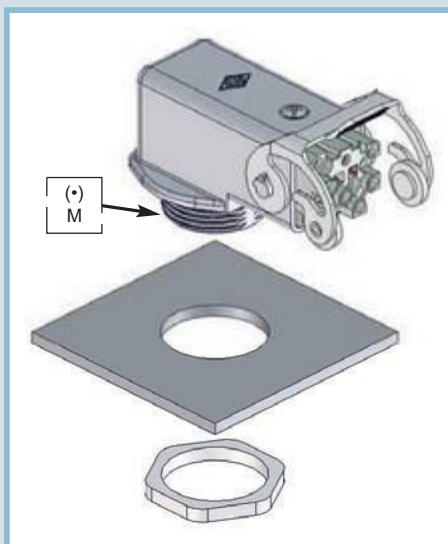
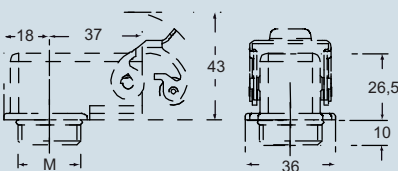

CRUIS Type 12
Type 4/4X only
with CKR 65 (D)

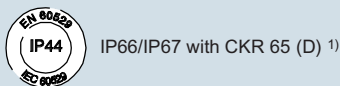

dimensions shown are not binding
and may be changed without notice

C-TYPE - size 21.21



inserts:		page
CK	3 poles + ⊕	40
CK	4 poles + ⊕	40
CKS	3 poles + ⊕	41
CKS	4 poles + ⊕	41
CD	8 poles	46
CQ	5 poles + ⊕	69
CQ	12 poles + ⊕	68

insert dimensions:
21 x 21 mm

hoods



covers



description	part no. (entry - Pg 11)	part no. (entry - M 20)	part no.
with pegs, top entry	CKA 03 VS	MKA V20	
with pegs, side entry	CKA 03 VAS	MKA VA20	
with galvanised steel lever, top entry	CKA 03 VGS	MKA VG20	
with stainless steel lever, top entry	CKAX 03 VGS	MKAX VG20	
with pegs and gasket, for female inserts			CKA 03 C ¹⁾
with pegs, for male inserts			CKA 03 CA ¹⁾
with stainless steel lever and gasket, for female inserts			CKAX 03 CX
with stainless steel lever, for male inserts			CKAX 03 CXA
gasket and screw kit for IP66/IP67 ²⁾ for CK, CQ 05, CKS inserts	CKR 65		
gasket and screw kit for IP66/IP67 ²⁾ for CD 08 inserts	CKR 65 D		

- 1) preferably be used with enclosures CKAX (stainless steel lever).
 - 2) To obtain the protection rating IP66/IP67 a kit is provided that includes a gasket to fit under the insert fixing screws supplied with the kit (see illustrative example)
- CQ 12 inserts are already supplied with a gasket and screw which ensure IP66/IP67 protection rating

dimensions in mm

CKA VS and MKA V

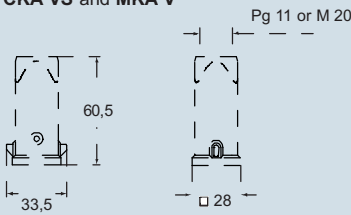

CKA VAS and MKA VA

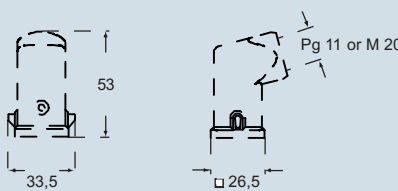

CKA VGS and MKA VG

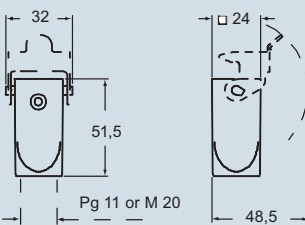

CKAX VGS and MKAX VG

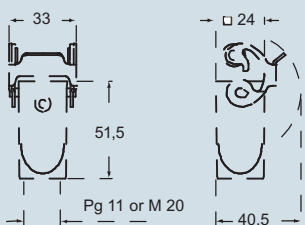

dimensions in mm

CKA C

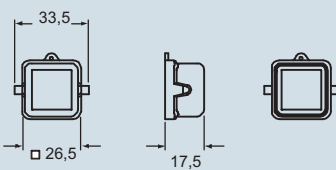

CKA CA

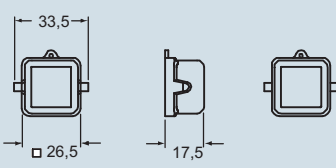

CKAX CX

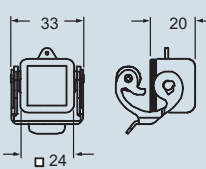

CKAX CXA

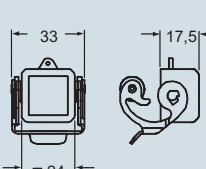

Type 12
Type 4/4X only
with CKR 65 (D)



IP66/IP67 with CKR 65 (D) ²⁾

dimensions shown are not binding
and may be changed without notice

inserts:	page:
CXL 2/4 SF.....	456
CXL 2/4 SM.....	456
CXL SF.....	456
CXL SM.....	456

CJ KF	441
-------------	-----

bulkhead housings



cover



description	part No.	part No.
with lever	CK 03 IN (black)	
with pegs and gasket		CKG 03 CN (black)

panel cut-out for enclosures, in mm

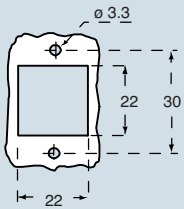

dimensions in mm

CK IN

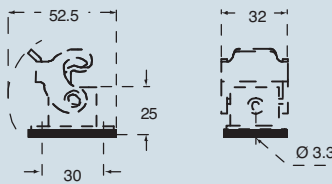

dimensions in mm

CKG CN

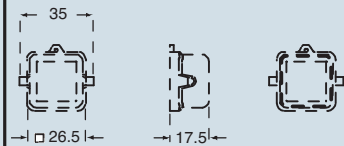

Note:
CXL and CJ K inserts are already supplied with seal and screw, which ensure IP66/IP67 protection rating.

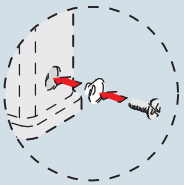

CALUS® Type 4/4X/12

dimensions shown are not binding and may be changed without notice

inserts:	page:
CXL 2/4 PF	457
CXL 2/4 PFH	457
CXL 2/4 PM	457
CXL 2/4 PMH	457
CXL PF	457
CXL PM	457

CJ KM 441

hoods



description	part No. (entry - Pg 11)	part No. (entry - M 20)
with pegs and gasket, top entry	CKG 03 VN (black)	MKG VN20 (black)
with pegs and gasket, side entry	CKG 03 VAN (black)	MKG VAN20 (black)

Note:
CXL and CJ K inserts are already supplied with seal and screw, which ensure IP66/IP67 protection rating.

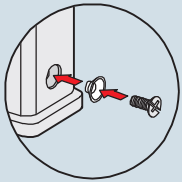

dimensions in mm

CKG VN and MKG VN

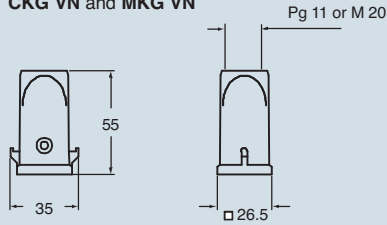

CKG VAN and MKG VAN

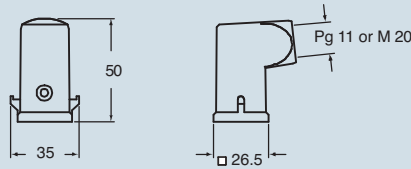

CALUS® Type 4/4X/12

dimensions shown are not binding
and may be changed without notice

inserts:	page
CXL 2/4 SF.....	456
CXL 2/4 SM.....	456
CXL SF.....	456
CXL SM.....	456

CJ KF	441
CX 1/2 BD	444

bulkhead housings



cover



description	part No.	part No.
with stainless steel lever	CKAX 03 I	
with pegs and gasket		CKAG 03 C

panel cut-out for enclosures, in mm

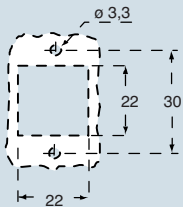

dimensions in mm

CKAX I

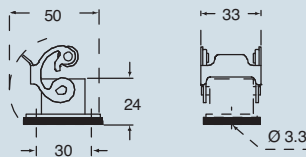

dimensions in mm

CKAG C

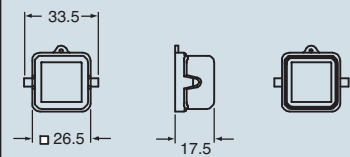

Nota:
CXL, CX 1/2 BD and CJ K inserts are already supplied with seal and screw, which ensure IP66/IP67 protection rating.

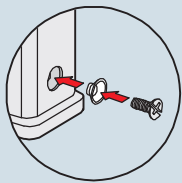

CALUS® Type 4/4X/12

dimensions shown are not binding and may be changed without notice

inserts:	page
CXL 2/4 PF.....	457
CXL 2/4 PFH.....	457
CXL 2/4 PM.....	457
CXL 2/4 PMH.....	457
CXL PF.....	457
CXL PM.....	457

CJ KM.....	441
CX 1/2 BD *	444

* cannot be used with angled enclosures (part No. CKAG 03 VA / MKAG VA20)

hoods



description	part No. (entry - Pg 11)	part No. (entry - M 20)
with pegs and gasket, top entry	CKAG 03 V	MKAG V20
with pegs and gasket, side entry	CKAG 03 VA	MKAG VA20

Note:
CXL, CX 1/2 BD and CJ K inserts are already supplied with seal and screw, which ensure IP66/IP67 protection rating.

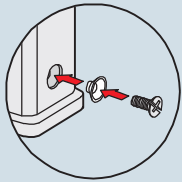

dimensions in mm

CKAG V and MKAG V

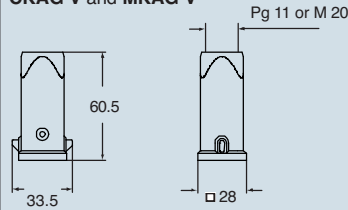

CKAG VA and MKAG VA

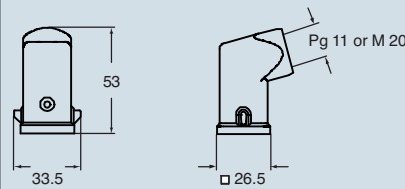

CALUS® Type 4/4X/12

dimensions shown are not binding and may be changed without notice



inserts: page

CQ 08	8 poles + ⊕	70
CQ 04/2	4 poles + 2 poles + ⊕	71

bulkhead mounting housing with single lever



hoods with 2 pegs



description	part no.	entry Pg	part no.	entry Pg
with lever without cable gland entry, angled, with lever	CQ 08 I			
with cable gland entry, angled, with lever	CQ 08 IA			
with pegs, side entry *	CQ 08 IAP	21		
with pegs, top entry *			CQ 08 VA	16
			CQ 08 V	21

* Pg male thread on enclosure exterior

panel cut-out for CQ I enclosure, in mm

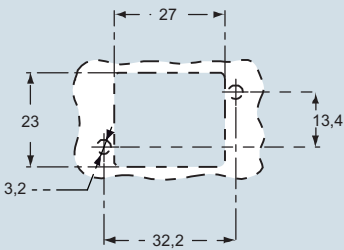

panel cut-out for CQ IA - CQ IA enclosure, in mm

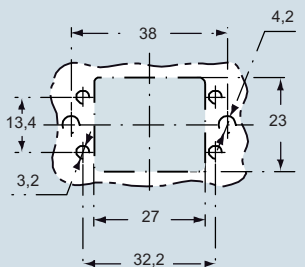

dimensions in mm

CQ I

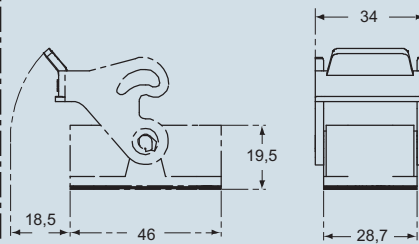

CQ IA

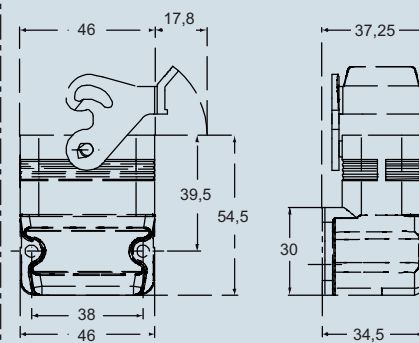

CQ IAP

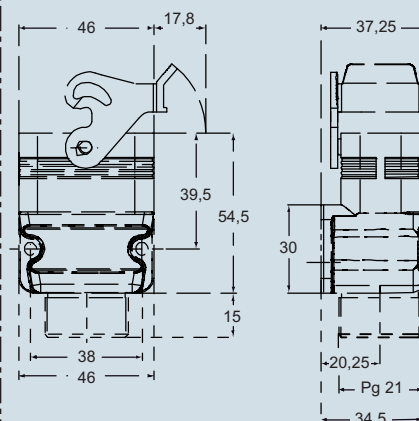

dimensions in mm

CQ VA

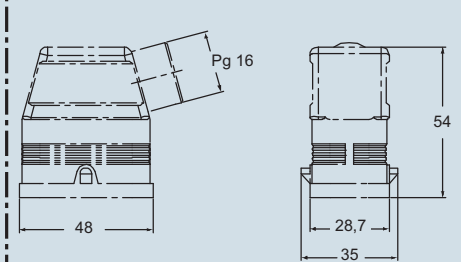

CQ V

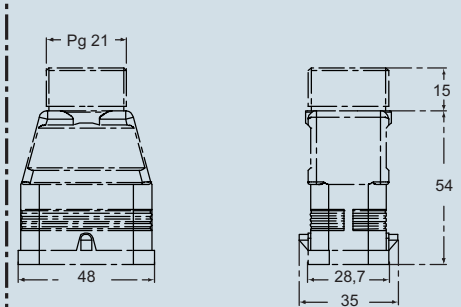

CUUS Type 4/4X/12



dimensions shown are not binding and may be changed without notice

C-TYPE - size 32.13



inserts:	page
CQ 08 8 poles + ⊕	70
CQ 04/2 4 poles + 2 poles + ⊕71	

hoods with single lever



covers with 2 pegs
thermoplastic resin cable glands



description	part no.	entry Pg	part no.
with lever, top entry *	CQ 08 VG	21	
cover with 2 pegs for female inserts cover with 2 pegs for male inserts			CQ 08 C CQ 08 CA
cable gland head and gasket for CQ 08 VA enclosure cable gland head and gasket for CQ 08 V and VG enclosure			CRQ 16 CRQ 21

** Pg male thread on enclosure exterior

cable diameters for cable glands:
- CRQ 16: 10 - 14.5 mm
- CRQ 21: 14 - 18 mm

dimensions in mm

CQ VG

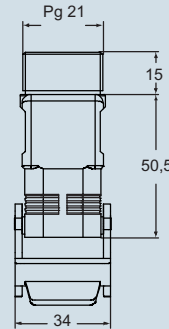
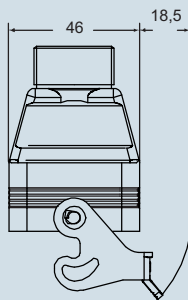

dimensions in mm

CQ C and CQ CA

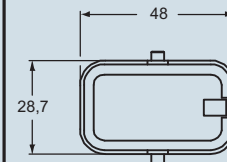

CRQ 16 and CRQ 21

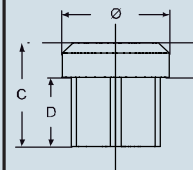
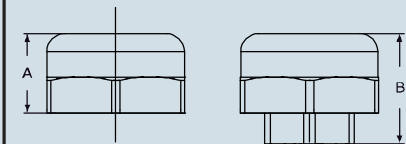
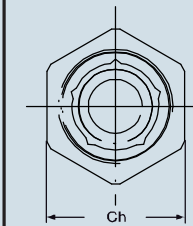

part	A	B	C	D	E	Ø	Ch
CRQ 16	15.5	21.5	20.25	13.5	6.75	21	27
CRQ 21	18.2	27.5	25	15.5	9	26.5	33

CALUS® Type 4/4X/12



dimensions shown are not binding
and may be changed without notice

Allows two complete portable RJ45 connectors to be joined, IP65/IP67 version

**insulated version coupling,
for RJ45 connectors**

**metal version coupling,
for RJ45 connectors**

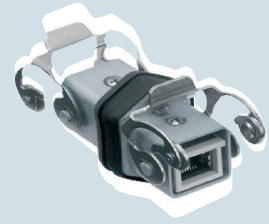

description	part No.	part No.
- female RJ45 coupling, 8 data contacts - female RJ45 coupling, 8 data contacts / 2 power contacts	CYG 8 JF * CYG 8/2 JF *	
- female RJ45 coupling, 8 data contacts - female RJ45 coupling, 8 data contacts / 2 power contacts		CYG 8 JFA * CYG 8/2 JFA *

- RJ45 connector features:**
- RJ45, Class 5 connector
 - nominal current: 2.1A at 70 °C
 - nominal voltage: 50VDC / 35VAC
 - temperature range: from -40 °C to +120 °C
 - nickel plated brass screening
 - insert coding pin: **CR KC**
 - self-extinguishing properties: to UL 94V-0
 - die cast zinc alloy metal enclosures
 - black self-extinguishing thermoplastic insulated enclosures

* 4 pole version on request, part No. **CYG 4 JF, CYG 4/2 JF, CYG 4 JFA and CYG 4/2 JFA** with "crossover" link

dimensions in mm
CYG 4 JF, CYG 4/2 JF, CYG 8 JF, CYG 8/2 JF

dimensions in mm
CYG 4 JFA, CYG 4/2 JFA, CYG 8 JFA, CYG 8/2 JFA

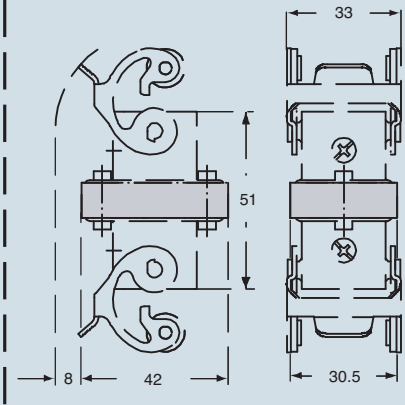
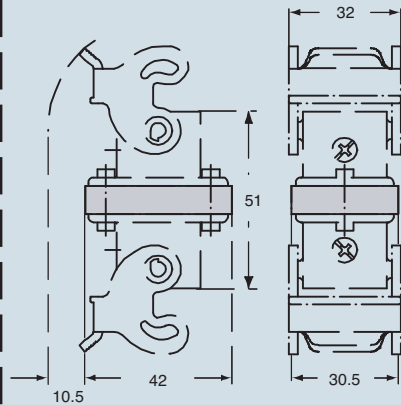

contacts side (front view)

contacts side (front view)

side with reference arrow ▲

side with reference arrow ▲

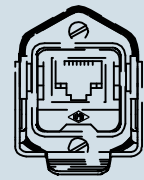
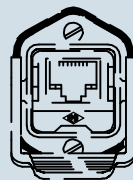

dimensions shown are not binding
 and may be changed without notice