

inserts:		page
<b>CDD</b> .....	24 poles + ⊕	59
<b>CQE</b> .....	10 poles + ⊕	80
<b>CSH</b> .....	6 poles + ⊕	88
<b>CCE</b> .....	6 poles + ⊕	94
<b>CNE, CSE, JCNE, JCSE</b> .....	6 poles + ⊕	95 and 106
<b>CSS</b> .....	6 poles + ⊕	118
<b>CT, CTE, CTSE</b> .....	6 poles + ⊕	126 and 130
<b>MIXO</b> .....	2 modules	156+195

insert centre distance:  
44 x 27 mm

### bulkhead mounting housings with single lever



### bulkhead mounting housings with 2 pegs



description

part  
no.

part  
no.

with lever

**CHI 06 L**

with lever and cover

**CHI 06 LS**

with pegs <sup>1)</sup>

**CHI 06 LC**

with pegs and aluminum cover <sup>1)</sup>

**CHI 06 LCS**

with pegs and plastic cover <sup>1)</sup>

**CHI 06 LCP**

<sup>1)</sup> may be combined with enclosures:

- CHO/CHV 06 LX
- CHO/CHV 06 LX

**NB:** the enclosures ensure IP66 protection (or IP65 for cover versions) rating when mated and locked with the closing levers.

The door (CS, CP) only ensures mechanical protection, but does not ensure IP65 protection rating.

panel cut-out for bulkhead mounting housings in mm

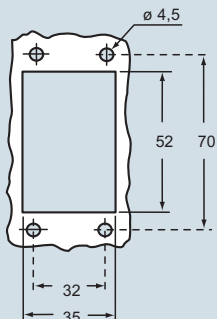

dimensions in mm

**CHI L**

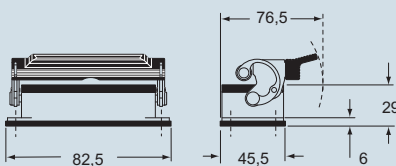

**CHI LS**

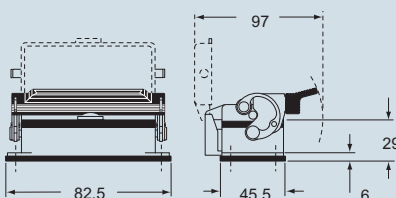

dimensions in mm

**CHI LC**

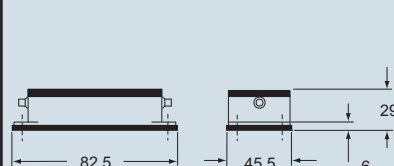

**CHI LCS/LCP**

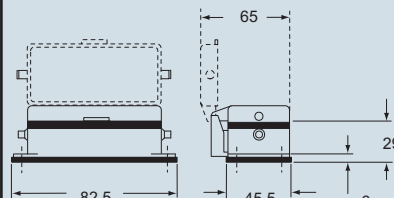

**CALUS**® Type  
4/4X/12

(excluding enclosures with plastic cover)



dimensions shown are not binding  
and may be changed without notice

inserts:		page
<b>CDD</b> .....	24 poles + ⊕	59
<b>CQE</b> .....	10 poles + ⊕	80
<b>CSH</b> .....	6 poles + ⊕	88
<b>CCE</b> .....	6 poles + ⊕	94
<b>CNE, CSE, JCNE, JCSE</b> .....	6 poles + ⊕	95 and 106
<b>CSS</b> .....	6 poles + ⊕	118
<b>MIXO</b> .....	2 modules	156+195

insert centre distance:  
**44 x 27 mm**

### surface mounting housings with single lever



### angled surface mounting housings with single lever



description	part no.	entry Pg	part no.	entry M	part no.	entry M
with lever	<b>CHP 06 L</b>	16	<b>MHP 06 L20</b>	20		
with lever	<b>CHP 06 L2</b>	16 x 2	<b>MHP 06 L220</b>	20 x 2		
with lever, high	<b>CAP 06 L</b>	21	<b>MAP 06 L32</b>	32		
with lever, high	<b>CAP 06 L2</b>	21 x 2	<b>MAP 06 L232</b>	32 x 2		
with lever, high	<b>CAP 06 L29</b>	29	<b>MAP 06 L40</b>	40		
with lever, high	<b>CAP 06 L229</b>	29 x 2	<b>MAP 06 L240</b>	40 x 2		
with lever and cover	<b>CHP 06 LS</b>	16	<b>MHP 06 LS20</b>	20		
with lever and cover	<b>CHP 06 LS2</b>	16 x 2	<b>MHP 06 LS220</b>	20 x 2		
with lever and cover, high	<b>CAP 06 LS</b>	21	<b>MAP 06 LS32</b>	32		
with lever and cover, high	<b>CAP 06 LS2</b>	21 x 2	<b>MAP 06 LS232</b>	32 x 2		
with lever and cover, high	<b>CAP 06 LS29</b>	29	<b>MAP 06 LS40</b>	40		
with lever and cover, high	<b>CAP 06 LS229</b>	29 x 2	<b>MAP 06 LS240</b>	40 x 2		
with lever, cable gland entry, closed bulkhead *					<b>MAV 06LG25-F</b>	<b>M25</b>

**NB:** the enclosures ensure IP66 protection (or IP65 for cover versions) rating when mated and locked with the closing levers.  
The door (CS, CP) only ensures mechanical protection, but does not ensure IP65 protection rating.

\* be used only with a complete cable gland.  
(to be purchased separately).  
\* versions with M32, Pg 21 or Pg 29 entry on request

dimensions in mm

#### CHP L - CAP L and MHP L - MAP L

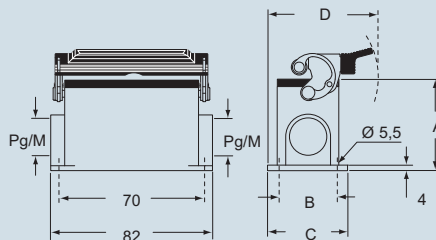

#### CHP LS - CAP LS and MHP LS - MAP LS

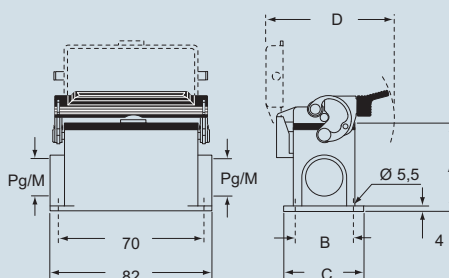

type	A	B	C	D
<b>CHP L / MHP L</b>	53	40	52	73.5
<b>CAP L / MAP L</b>	74	45	57	82
<b>CHP LS / MHP LS</b>	53	40	52	97
<b>CAP LS / MAP LS</b>	74	45	57	97

dimensions in mm

#### MAV 06LG25-F

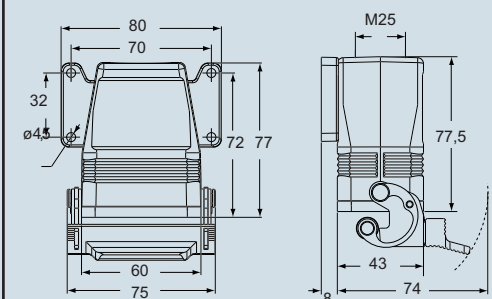

**CU**® Type  
4/4X/12



dimensions shown are not binding  
and may be changed without notice

inserts:		page
CDD .....	24 poles + ⊕	59
CQE .....	10 poles + ⊕	80
CSH .....	6 poles + ⊕	88
CNE, CSE, JCNE, JCSE	6 poles + ⊕ 95 and 106	
CSS .....	6 poles + ⊕	118
MIXO .....	2 modules	156+195

insert centre distance:  
44 x 27 mm

## hoods with 2 pegs



## hoods with 1 lever



description	part no.	entry Pg	part no.	entry M	part no.	entry Pg	part no.	entry M
with pegs, side entry	CHO 06 L13	13.5	MHO 06 L20	20				
with pegs, side entry	CHO 06 L16	16	MHO 06 L25	25				
with pegs, side entry, high construction	CAO 06 L21	21	MAO 06 L25	25				
with pegs, side entry, high construction	CAO 06 L29	29	MAO 06 L32	32				
with pegs, side entry, high construction, without adaptor *	CFO 06 L21	21	MFO 06 L25	25				
with pegs, side entry, high construction, without adaptor *	CFO 06 L29	29	MFO 06 L32	32				
with pegs, top entry	CHV 06 L13	13.5	MHV 06 L20	20				
with pegs, top entry	CHV 06 L16	16	MHV 06 L25	25				
with pegs, top entry, high construction	CAV 06 L21	21	MAV 06 L25	25				
with pegs, top entry, high construction	CAV 06 L29	29	MAV 06 L32	32				
with pegs, top entry, high construction, without adaptor *	CFV 06 L21	21	MFV 06 L25	25				
with pegs, top entry, high construction, without adaptor *	CFV 06 L29	29	MFV 06 L32	32				
with lever, top entry					CHV 06 LG	16	MHV 06 LG25	25
with lever, top entry, high construction					CAV 06 LG21	21	MAV 06 LG25	25
with lever, top entry, high construction					CAV 06 LG29	29	MAV 06 LG32	32
with lever, top entry, high construction, without adaptor *					CFV 06 LG21	21	MFV 06 LG25	25
with lever, top entry, high construction, without adaptor *					CFV 06 LG29	29	MFV 06 LG32	32

\* enclosure without adaptor, threaded on the body, to enclosure to be used only with a complete cable gland.

dimensions in mm

CHO L (CAO L) and (CFO L)  
MHO L (MAO L) and (MFO L)

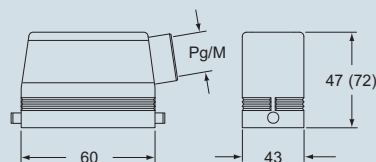

CHV L (CAV L) and [CFV L]  
MHV L (MAV L) and [MFV L]

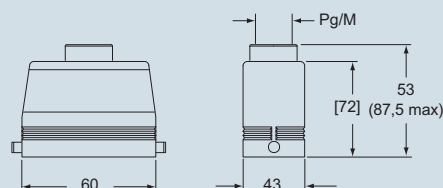

dimensions in mm

CHV LG (CAV LG) and [CFV LG]  
MHV LG (MAV LG) and [MFV LG]

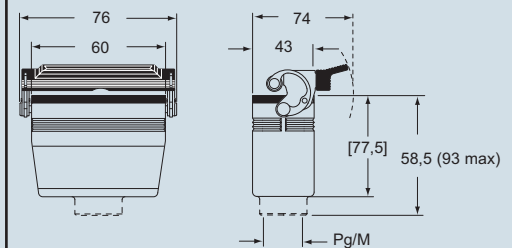

**CALUS** Type  
4/4X/12



according to the type of lever

dimensions shown are not binding  
and may be changed without notice

inserts:		page
<b>CDD</b> .....	24 poles + ⊕	59
<b>CQE</b> .....	10 poles + ⊕	80
<b>CSH</b> .....	6 poles + ⊕	88
<b>CCE</b> .....	6 poles + ⊕	94
<b>CNE, CSE, JCNE, JCSE</b> .....	6 poles + ⊕ 95 and 106	
<b>CSS</b> .....	6 poles + ⊕	118
<b>CT, CTE, CTSE</b> .....	6 poles + ⊕ 126 and 130	
<b>MIXO</b> .....	2 modules	156÷195

insert centre distance:  
44 x 27 mm

## hoods with 1 lever



## covers

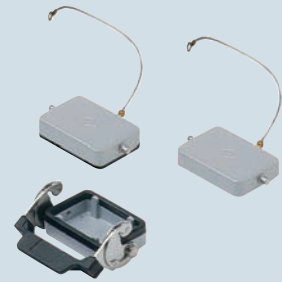

description	part no.	entry Pg	part no.	entry M	part no.
with lever, without gasket, side entry <sup>1)</sup>	<b>CHO 06 LX16</b>	16	<b>MHO 06 LX20</b>	20	
with lever, without gasket, side entry <sup>1)</sup>			<b>MHO 06 LX25</b>	25	
with lever, without gasket, top entry <sup>1)</sup>	<b>CHV 06 LX16</b>	16	<b>MHV 06 LX20</b>	20	
with lever, without gasket, top entry <sup>1)</sup>			<b>MHV 06 LX25</b>	25	
with lever (for hoods with pegs)					<b>CHC 06 LG</b>
with pegs (for enclosures with lever )					<b>CHC 06 L</b>
with pegs and gasket (for hoods with lever) <sup>2)</sup>					<b>CHC 06 LC</b>

<sup>1)</sup> may be combined with enclosures: CHI 06 LCS/LCP/LC

<sup>2)</sup> may be combined with enclosures:

- CHO/CHV 06 LX
- CHO/CHV 06 LX

## dimensions in mm

## CHO LX and MHO LX

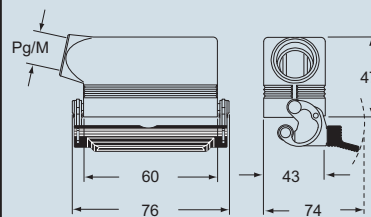

## CHV LX and MHV LX

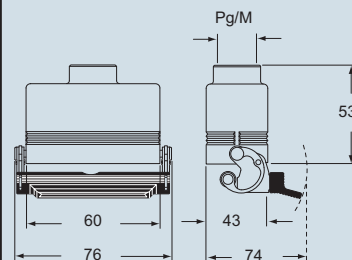

## dimensions in mm

## CHC LG

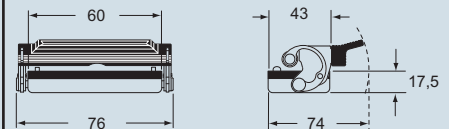

## CHC L

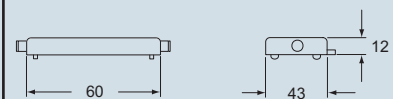

## CHC LC



**CALUS** Type  
4/4X/12



dimensions shown are not binding  
and may be changed without notice

inserts:		page
<b>CDD</b> .....	42 poles + ⊕	61
<b>CQE</b> .....	18 poles + ⊕	81
<b>CSH</b> .....	10 poles + ⊕	89
<b>CCE</b> .....	10 poles + ⊕	96
<b>CNE, CSE, JCNE, JCSE</b> .....	poles + ⊕ 97 and 107	
<b>CSS</b> .....	10 poles + ⊕	119
<b>CT, CTE, CTSE</b> .....	10 poles + ⊕ 127 and 131	
<b>CMSE</b> .....	3+2 (aux) poles + ⊕	135
<b>CMCE</b> .....	3+2 (aux) poles + ⊕	134
<b>CX</b> .....	8/24 poles + ⊕	151
<b>MIXO</b> .....	3 modules	156+195

insert centre distance:  
57 x 27 mm

### bulkhead mounting housings with 2 levers or 4 pegs



### bulkhead mounting housings with single lever



description	part no.	part no.
with one or two levers	<b>CHI 10</b>	<b>CHI 10 L</b>
with pegs <sup>1)</sup>	<b>CHI 10 C</b>	
with pegs and aluminum cover <sup>1)</sup>	<b>CHI 10 CS</b>	
with pegs and plastic cover <sup>1)</sup>	<b>CHI 10 CP</b>	
with lever and cover		<b>CHI 10 LS</b>

<sup>1)</sup> may be combined with enclosures:  
- CHO/CAO 10 X and CHV/CAV 10 X  
- MHO/MAO 10 X and MHV/MAV 10 X

**NB:** the enclosures ensure IP66 protection (or IP65 for cover versions) rating when mated and locked with the closing levers.  
The door (CS, CP) only ensures mechanical protection, but does not ensure IP65 protection rating.

panel cut-out for bulkhead mounting housings in mm

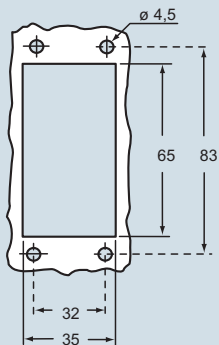

### dimensions in mm

#### CHI

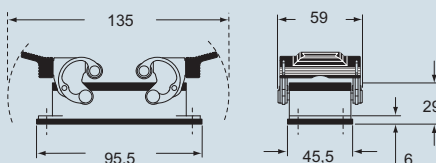

#### CHI C

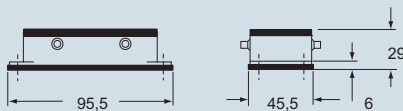

#### CHI CS/CP

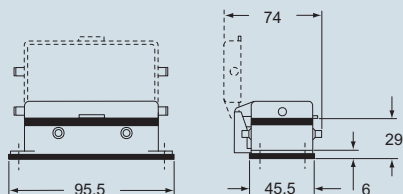

### dimensions in mm

#### CHI L

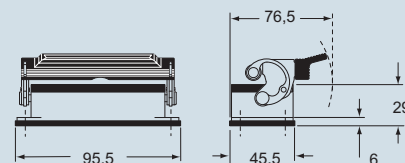

#### CHI LS

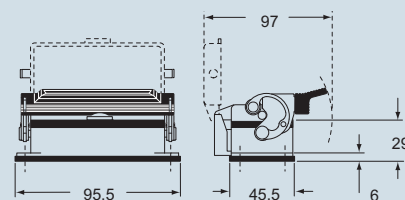

**CALUS**® Type  
4/4X/12

(excluding enclosures with plastic cover)



dimensions shown are not binding  
and may be changed without notice

inserts:		page
<b>CDD</b> .....	42 poles + ⊕	61
<b>CQE</b> .....	18 poles + ⊕	81
<b>CSH</b> .....	10 poles + ⊕	89
<b>CCE</b> .....	10 poles + ⊕	96
<b>CNE, CSE, JCNE, JCSE</b> .....	10 poles + ⊕ 97 and 107	107
<b>CSS</b> .....	10 poles + ⊕	119
<b>CMSE</b> .....	3+2 (aux) poles + ⊕	135
<b>CMCE</b> .....	3+2 (aux) poles + ⊕	134
<b>CX</b> .....	8/24 poles + ⊕	151
<b>MIXO</b> .....	3 modules	156÷195

insert centre distance:  
57 x 27 mm

### surface mounting housings with 2 levers or 4 pegs



### surface mounting housings with single lever



description	part no.	entry Pg	part no.	entry M	part no.	entry Pg	part no.	entry M
with levers	<b>CHP 10</b>	16	<b>MHP 10.20</b>	20	<b>CHP 10 L</b>	16	<b>MHP 10 L20</b>	20
with levers	<b>CHP 10.2</b>	16 x 2	<b>MHP 10.220</b>	20 x 2	<b>CHP 10 L2</b>	16 x 2	<b>MHP 10 L220</b>	20 x 2
with levers, high	<b>CAP 10.21</b>	21	<b>MAP 10.32</b>	32	<b>CAP 10 L</b>	21	<b>MAP 10 L32</b>	32
with levers, high	<b>CAP 10.221</b>	21 x 2	<b>MAP 10.232</b>	32 x 2	<b>CAP 10 L2</b>	21 x 2	<b>MAP 10 L232</b>	32 x 2
with levers, high	<b>CAP 10.29</b>	29	<b>MAP 10.40</b>	40	<b>CAP 10 L29</b>	29	<b>MAP 10 L40</b>	40
with levers, high	<b>CAP 10.229</b>	29 x 2	<b>MAP 10.240</b>	40 x 2	<b>CAP 10 L229</b>	29 x 2	<b>MAP 10 L240</b>	40 x 2
with pegs and aluminum cover <sup>1)</sup>	<b>CHP 10 CS</b>	16	<b>MHP 10 CS20</b>	20				
with pegs and aluminum cover <sup>1)</sup>	<b>CHP 10 CS2</b>	16 x 2	<b>MHP 10 CS220</b>	20 x 2				
with pegs and aluminum cover, high <sup>1)</sup>	<b>CAP 10 CS</b>	21	<b>MAP 10 CS32</b>	32				
with pegs and aluminum cover, high <sup>1)</sup>	<b>CAP 10 CS2</b>	21 x 2	<b>MAP 10 CS232</b>	32 x 2				
with pegs and aluminum cover, high <sup>1)</sup>	<b>CAP 10 CS29</b>	29	<b>MAP 10 CS40</b>	40				
with pegs and aluminum cover, high <sup>1)</sup>	<b>CAP 10 CS229</b>	29 x 2	<b>MAP 10 CS240</b>	40 x 2				
with pegs and plastic cover <sup>1)</sup>	<b>CHP 10 CP</b>	16	<b>MHP 10 CP20</b>	20				
with pegs and plastic cover <sup>1)</sup>	<b>CHP 10 CP2</b>	16 x 2	<b>MHP 10 CP220</b>	20 x 2				
with pegs and plastic cover, high <sup>1)</sup>	<b>CAP 10 CP</b>	21	<b>MAP 10 CP32</b>	32				
with pegs and plastic cover, high <sup>1)</sup>	<b>CAP 10 CP2</b>	21 x 2	<b>MAP 10 CP232</b>	32 x 2				
with pegs and plastic cover, high <sup>1)</sup>	<b>CAP 10 CP29</b>	29	<b>MAP 10 CP40</b>	40				
with pegs and plastic cover, high <sup>1)</sup>	<b>CAP 10 CP229</b>	29 x 2	<b>MAP 10 CP240</b>	40 x 2				
with lever and cover					<b>CHP 10 LS</b>	16	<b>MHP 10 LS20</b>	20
with lever and cover					<b>CHP 10 LS2</b>	16 x 2	<b>MHP 10 LS220</b>	20 x 2
with lever and cover, high					<b>CAP 10 LS</b>	21	<b>MAP 10 LS32</b>	32
with lever and cover, high					<b>CAP 10 LS2</b>	21 x 2	<b>MAP 10 LS232</b>	32 x 2
with lever and cover, high					<b>CAP 10 LS29</b>	29	<b>MAP 10 LS40</b>	40
with lever and cover, high					<b>CAP 10 LS229</b>	29 x 2	<b>MAP 10 LS240</b>	40 x 2

<sup>1)</sup> may be combined with enclosures:  
- CHO/CAO 10 X and CHV/CAV 10 X  
- MHO/MAO 10 X and MHV/MAV 10 X

**NB:** the enclosures ensure IP66 protection (or IP65 for cover versions) rating when mated and locked with the closing levers.  
The door (CS, CP) only ensures mechanical protection, but does not ensure IP65 protection rating.

dimensions in mm

#### CHP - CAP and MHP - MAP

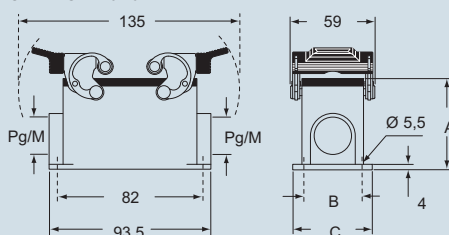

#### CHP CS/CP - CAP CS/CP and MHP CS/CP - MAP CS/CP

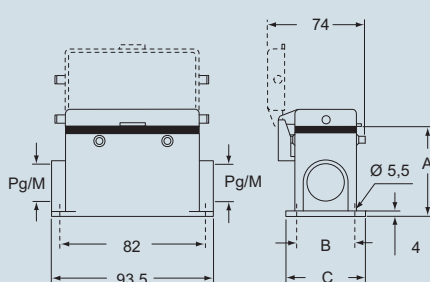

type	A	B	C
<b>CHP / MHP</b>	57	40	52
<b>CAP / MAP</b>	74	45	57
<b>CHP CS / MHP CS</b>	57	40	52
<b>CAP CS / MAP CS</b>	74	45	57
<b>CHP CP / MHP CP</b>	57	40	52
<b>CAP CP / MAP CP</b>	74	45	57

dimensions in mm

#### CHP L - CAP L and MHP L - MAP L

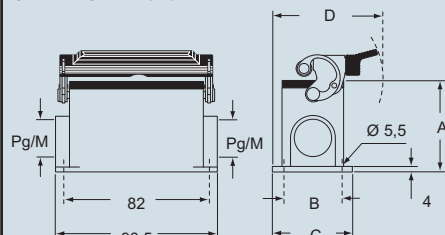

#### CHP LS - CAP LS and MHP LS - MAP LS

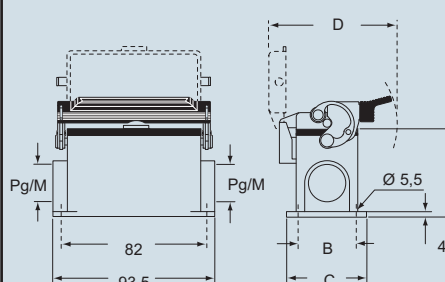

type	A	B	C	D
<b>CHP L / MHP L</b>	57	40	52	79.5
<b>CAP L / MAP L</b>	74	45	57	82
<b>CHP LS / MHP LS</b>	57	40	52	97
<b>CAP LS / MAP LS</b>	74	45	57	97

**CAV<sup>®</sup> US** Type  
4/4X/12

(excluding enclosures with plastic cover)



dimensions shown are not binding  
and may be changed without notice



inserts:		page
<b>CDD</b> .....	42 poles + ⊕	61
<b>CQE</b> .....	18 poles + ⊕	81
<b>CSH</b> .....	10 poles + ⊕	89
<b>CCE</b> .....	10 poles + ⊕	96
<b>CNE, CSE, JCNE, JCSE</b> .....	10 poles + ⊕	97 and 107
<b>CSS</b> .....	10 poles + ⊕	119
<b>CMSE</b> .....	3+2 (aux) poles + ⊕	135
<b>CMCE</b> .....	3+2 (aux) poles + ⊕	134
<b>CX</b> .....	8/24 poles + ⊕	129
<b>MIXO</b> .....	3 modules	156÷195

insert centre distance:  
57 x 27 mm

## hoods with 4 pegs



## hoods with 2 pegs



description	part no.	entry Pg	part no.	entry M	part no.	entry Pg	part no.	entry M
with pegs, side entry	<b>CHO 10</b>	16	<b>MHO 10.20</b>	20	<b>CHO 10 L</b>	16	<b>MHO 10 L20</b>	20
with pegs, side entry			<b>MHO 10.25</b>	25			<b>MHO 10 L25</b>	25
with pegs, side entry, high construction	<b>CAO 10.21</b>	21	<b>MAO 10.32</b>	32	<b>CAO 10 L21</b>	21	<b>MAO 10 L32</b>	32
with pegs, side entry, high construction	<b>CAO 10.29</b>	29	<b>MAO 10.40</b>	40	<b>CAO 10 L29</b>	29	<b>MAO 10 L40</b>	40
with pegs, top entry	<b>CHV 10</b>	16	<b>MHV 10.20 **</b>	20	<b>CHV 10 L</b>	16	<b>MHV 10 L20 **</b>	20
with pegs, top entry			<b>MHV 10.25</b>	25			<b>MHV 10 L25</b>	25
with pegs, top entry, high construction	<b>CAV 10.21</b>	21	<b>MAV 10.32</b>	32	<b>CAV 10 L21</b>	21	<b>MAV 10 L32</b>	32
with pegs, top entry, high construction	<b>CAV 10.29</b>	29	<b>MAV 10.40</b>	40	<b>CAV 10 L29</b>	29	<b>MAV 10 L40</b>	40
with pegs, frontal entry, high construction	<b>CAF 10</b>	16	<b>MAF 10.20</b>	20				
with pegs, frontal entry, high constr., without adaptor *	<b>CFF 10</b>	16	<b>MFF 10.20</b>	20				

\* enclosure without adaptor, threaded on the body, to be used only with a complete cable gland.

\*\* can only be used with a complete cable gland (to be purchased separately)

alternatively, hoods with pegs are coupled with fixed enclosures:  
- C7, IP67 stainless steel lever, page 254  
- CV, IP66 stainless steel lever, page 260  
- JEI, IP66 galvanised steel lever, page 288

## dimensions in mm

## CHO (CAO) and MHO (MAO)

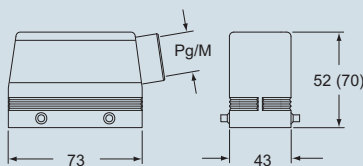

## CHV (CAV) and MHV (MAV)

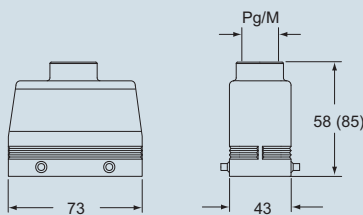

## CAF/CFF and MAF/MFF

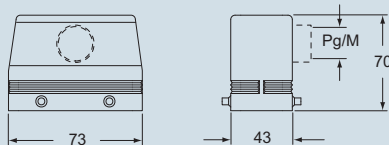

## dimensions in mm

## CHO L (CAO L) and MHO L (MAO L)

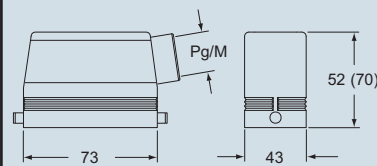

## CHV L (CAV L) and MHV L (MAV L)

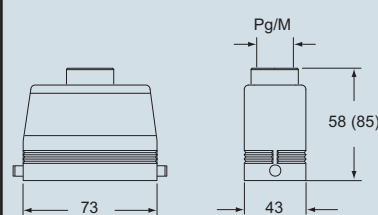

**CALUS**® Type  
4/4X/12



according to the type of lever

dimensions shown are not binding  
and may be changed without notice



inserts:		page
CDD .....	42 poles + ⊕	61
CQE .....	18 poles + ⊕	81
CSH .....	10 poles + ⊕	89
CCE .....	10 poles + ⊕	96
CNE, CSE, JCNE, JCSE .....	10 poles + ⊕ 97 and 107	
CSS .....	10 poles + ⊕	119
CMSE .....	3+2 (aux) poles + ⊕	135
CMCE .....	3+2 (aux) poles + ⊕	134
CX .....	8/24 poles + ⊕	129
MIXO .....	3 modules	156+195

insert centre distance:  
57 x 27 mm

hoods with double top entry



description	part no.	entry Pg	part no.	entry M
with pegs for two levers - used with enclosures size “57.27”	CAV 10.213	13.5 x 2	MAV 10.220	20 x 2
with pegs for 2 lever, without adaptor * - used with enclosures size “57.27”	CFV 10.213	13.5 x 2	MFV 10.220	20 x 2

\* enclosure without adaptor, threaded on the body, to be used only with a complete cable gland.

dimensions in mm

CAV/CFV and MAV/MFV

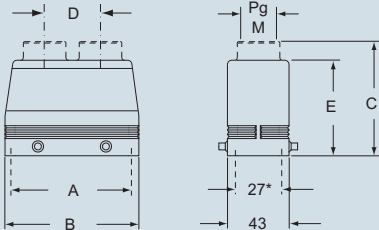

alternatively, hoods with pegs  
are coupled with fixed enclosures:  
- C7, IP67 stainless steel lever, page 254  
- CV, IP66 stainless steel lever, page 260  
- JEI, IP66 galvanised steel lever, page 288

part	A	B	C	D	E
CAV 10.213/MAV 10.220	57	73	82 (84.5)	26 (28.5)	70
CFV 10.213/MFV 10.220	57	73	—	28.5 (26)	70

\*) screw fixing centre distance

**CALUS**® Type  
4/4X/12



dimensions shown are not binding  
and may be changed without notice



inserts:		page
<b>CDD</b> .....	42 poles + ⊕	61
<b>CQE</b> .....	18 poles + ⊕	81
<b>CSH</b> .....	10 poles + ⊕	89
<b>CCE</b> .....	10 poles + ⊕	96
<b>CNE, CSE, JCNE, JCSE</b> .....	10 poles + ⊕ 97 and 107	
<b>CSS</b> .....	10 poles + ⊕	119
<b>CMSE</b> .....	3+2 (aux) poles + ⊕	135
<b>CMCE</b> .....	3+2 (aux) poles + ⊕	134
<b>CX</b> .....	8/24 poles + ⊕	129
<b>MIXO</b> .....	3 modules	156÷195

insert centre distance:  
57 x 27 mm

## hoods with 2 levers



## hoods with 1 lever



description	part no.	entry Pg	part no.	entry M	part no.	entry Pg	part no.	entry M
with levers and gasket, top entry	<b>CHV 10 G</b>	16	<b>MHV 10 G25</b>	25	<b>CHV 10 LG</b>	16	<b>MHV 10 LG25</b>	25
with levers and gasket, top entry, high construction	<b>CAV 10 G</b>	21	<b>MAV 10 G25</b>	25	<b>CAV 10 LG21</b>	21	<b>MAV 10 LG25</b>	25
with levers and gasket, top entry, high construction	<b>CAV 10 G29</b>	29	<b>MAV 10 G32</b>	32	<b>CAV 10 LG29</b>	29	<b>MAV 10 LG32</b>	32
with levers and gasket, top entry, high construction, without adaptor*	<b>CFV 10 G</b>	21	<b>MFV 10 G25</b>	25	<b>CFV 10 LG21</b>	21	<b>MFV 10 LG25</b>	25
with levers and gasket, top entry, high construction, without adaptor*	<b>CFV 10 G29</b>	29	<b>MFV 10 G32</b>	32	<b>CFV 10 LG29</b>	29	<b>MFV 10 LG32</b>	32

\* enclosure without adaptor, threaded on the body, to be used only with a complete cable gland.

dimensions in mm

**CHV G (CAV G) and [CFV G],  
MHV G (MAV G) and [MFV G]**

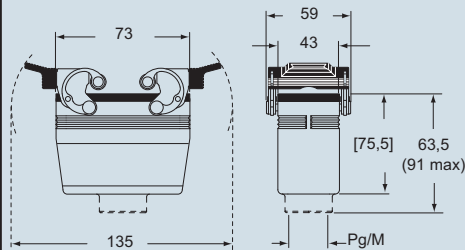

dimensions in mm

**CHV LG (CAV LG) and [CFV LG],  
MHV LG (MAV LG) and [MFV LG]**

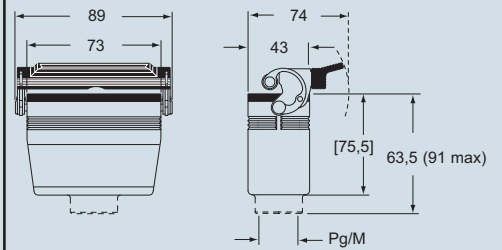

**CU<sup>®</sup>US** Type  
4/4X/12



dimensions shown are not binding  
and may be changed without notice

inserts:		page
<b>CDD</b> .....	42 poles + ⊕	61
<b>CQE</b> .....	18 poles + ⊕	81
<b>CSH</b> .....	10 poles + ⊕	89
<b>CCE</b> .....	10 poles + ⊕	96
<b>CNE, CSE, JCNE, JCSE</b> .....	10 poles + ⊕	97 and 107
<b>CSS</b> .....	10 poles + ⊕	119
<b>CMSE</b> .....	3+2 (aux) poles + ⊕	135
<b>CMCE</b> .....	3+2 (aux) poles + ⊕	134
<b>CX</b> .....	8/24 poles + ⊕	129
<b>MIXO</b> .....	3 modules	156+195

insert centre distance: 57 x 27 mm

## hoods with 2 levers

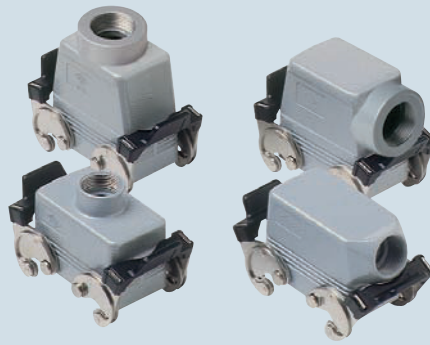

## covers

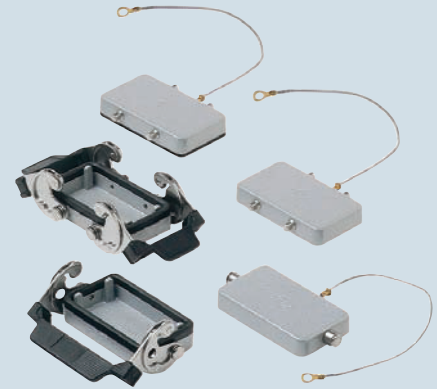

description	part no.	entry Pg	part no.	entry M	part no.
with levers, side entry <sup>1)</sup>	<b>CHO 10 X</b>	16	<b>MHO 10 X20</b>	20	
with levers, side entry <sup>1)</sup>			<b>MHO 10 X25</b>	25	
with levers, side entry, high construction <sup>1)</sup>	<b>CAO 10 X</b>	21	<b>MAO 10 X32</b>	32	
with levers, side entry, high construction <sup>1)</sup>	<b>CAO 10 X29</b>	29	<b>MAO 10 X40</b>	40	
with levers, top entry <sup>1)</sup>	<b>CHV 10 X</b>	16	<b>MHV 10 X20 **</b>	20	
with levers, top entry <sup>1)</sup>			<b>MHV 10 X25</b>	25	
with levers, top entry, high <sup>1)</sup>	<b>CAV 10 X</b>	21	<b>MAV 10 X32</b>	32	
with levers, top entry, high <sup>1)</sup>	<b>CAV 10 X29</b>	29	<b>MAV 10 X40</b>	40	
with 4 pegs (for enclosures with 2 levers with gasket)					<b>CHC 10</b>
with 4 pegs and gasket (for enclosures with 2 levers) <sup>2)</sup>					<b>CHC 10 C</b>
with 2 pegs (for enclosures with 1 lever with gasket)					<b>CHC 10 L</b>
with 2 levers (for hoods with 4 pegs)					<b>CHC 10 G</b>
with 1 lever (for hoods with 2 pegs)					<b>CHC 10 LG</b>

<sup>1)</sup> may be combined with enclosures:

- CHI/CHP/CAP 10 CS/CP/C
- MHP/MAP 10 CS/CP

<sup>2)</sup> may be combined with enclosures:

- CHO/CAO 10 X and CHV/CAV 10 X
- MHO/MAO 10 X and MHV/MAV 10 X

\*\* can only be used with a complete cable gland (to be purchased separately)

## dimensions in mm

## CHO X (CAO X) and MHO X (MAO X)

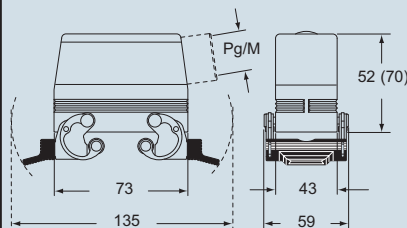

## CHV X (CAV X) and MHV X (MAV X)

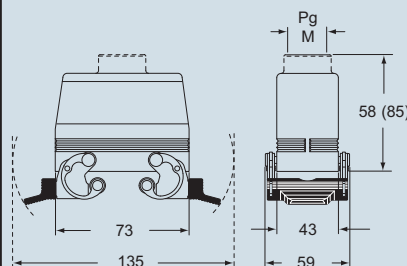

## dimensions in mm

## CHC



## CHC C



## CHC L

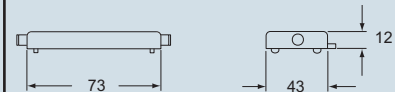

## CHC G

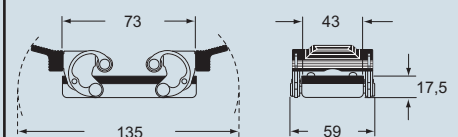

## CHC LG

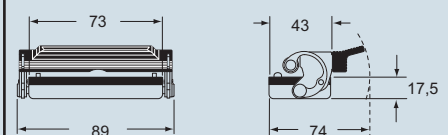

**CALUS**® Type 4/4X/12



dimensions shown are not binding  
and may be changed without notice

inserts:		page
CD .....	40 poles + ⊕	49
CT, CTS (10A) .....	40 poles + ⊕	56
CDD .....	72 poles + ⊕	62
CQE .....	32 poles + ⊕	82
CSH .....	16 poles + ⊕	90
CCE .....	16 poles + ⊕	98
CNE, CSE, JCNE, JCSE	16 poles + ⊕	99 and 108
CSS .....	16 poles + ⊕	120
CT, CTE, CTSE (16A) ..	16 poles + ⊕	128 and 132
CMSE .....	6+2 (aux) poles + ⊕	137
CMCE .....	6+2 (aux) poles + ⊕	136
CP .....	6 poles + ⊕	149
CX .....	6/36 and 12/2 poles + ⊕	152+153
CX .....	4/0 and 4/2 poles + ⊕	154
MIXO .....	4 modules	156+195

insert centre distance: **77.5 x 27 mm**

description	part no.	part no.
with one or two levers	<b>CHI 16</b>	<b>CHI 16 L</b>
with pegs <sup>1)</sup>	<b>CHI 16 C</b>	
with pegs and aluminum cover <sup>1)</sup>	<b>CHI 16 CS</b>	
with pegs and plastic cover <sup>1)</sup>	<b>CHI 16 CP</b>	
with lever and cover		<b>CHI 16 LS</b>

<sup>1)</sup> may be combined with enclosures:  
- CHO/CAO 16 X and CHV/CAV 16 X  
- MHO/MAO 16 X and MHV/MAV 16 X

**NB:** the enclosures ensure IP66 protection (or IP65 for cover versions) rating when mated and locked with the closing levers.

The door (CS, CP) only ensures mechanical protection, but does not ensure IP65 protection rating.

panel cut-out for bulkhead mounting housings in mm

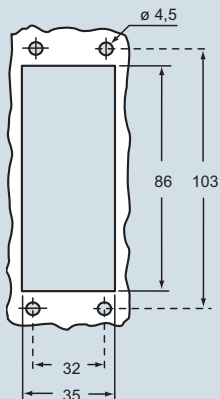

### bulkhead mounting housings with 2 levers or 4 pegs



### bulkhead mounting housings with single lever



### dimensions in mm

#### CHI

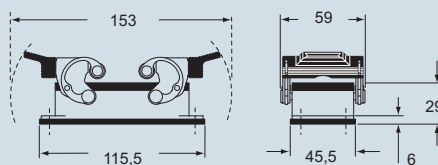

#### CHI C

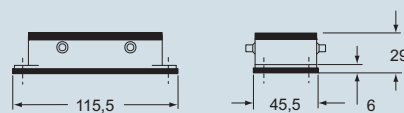

#### CHI CS/CP

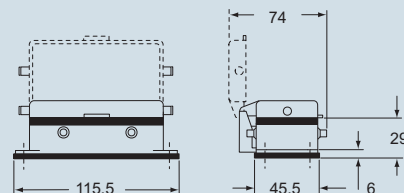

### dimensions in mm

#### CHI L

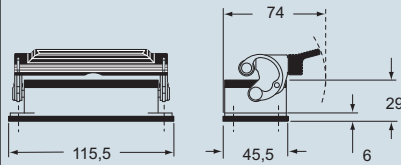

#### CHI LS

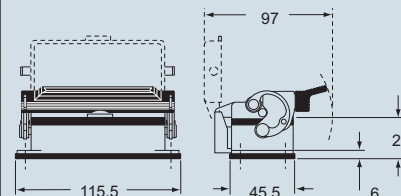

**CU**® Type  
4/4X/12

(excluding enclosures with plastic cover)



dimensions shown are not binding  
and may be changed without notice

inserts:		page
CD .....	40 poles + ⊕	49
CDD .....	72 poles + ⊕	62
CQE .....	32 poles + ⊕	82
CSH .....	16 poles + ⊕	90
CCE .....	16 poles + ⊕	98
CNE, CSE, JCNE, JCSE	16 poles + ⊕ 99 and 108	
CSS .....	16 poles + ⊕	120
CMSE .....	6+2 (aux) poles + ⊕	137
CMCE .....	6+2 (aux) poles + ⊕	136
CP .....	6 poles + ⊕	149
CX .....	6/36 and 12/2 poles + ⊕	152+153
CX .....	4/0 and 4/2 poles + ⊕	154
MIXO .....	4 modules	156+195

insert centre distance: 77.5 x 27 mm

### surface mounting housings with 2 levers or 4 pegs

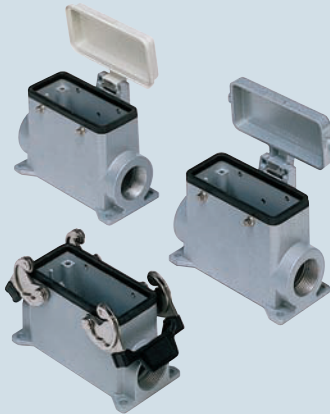

### surface mounting housings with single lever



description	part no.	entry Pg	part no.	entry M	part no.	entry Pg	part no.	entry M
with levers	CHP 16	21	MHP 16.25	25	CHP 16 L	21	MHP 16 L25	25
with levers	CHP 16.2	21 x 2	MHP 16.225	25 x 2	CHP 16 L2	21 x 2	MHP 16 L225	25 x 2
with levers, high construction	CAP 16.21	21	MAP 16.32	32	CAP 16 L	21	MAP 16 L32	32
with levers, high construction	CAP 16.221	21 x 2	MAP 16.232	32 x 2	CAP 16 L2	21 x 2	MAP 16 L232	32 x 2
with levers, high construction	CAP 16.29	29	MAP 16.40	40	CAP 16 L29	29	MAP 16 L40	40
with levers, high construction	CAP 16.229	29 x 2	MAP 16.240	40 x 2	CAP 16 L229	29 x 2	MAP 16 L240	40 x 2
with pegs and aluminum cover <sup>1)</sup>	CHP 16 CS	21	MHP 16 CS25	25				
with lever and aluminum cover <sup>1)</sup>	CHP 16 CS2	21 x 2	MHP 16 CS225	25 x 2				
with pegs and aluminum cover, high construction <sup>1)</sup>	CAP 16 CS	21	MAP 16 CS32	32				
with pegs and aluminum cover, high construction <sup>1)</sup>	CAP 16 CS2	21 x 2	MAP 16 CS232	32 x 2				
with pegs and aluminum cover, high construction <sup>1)</sup>	CAP 16 CS29	29	MAP 16 CS40	40				
with pegs and aluminum cover, high construction <sup>1)</sup>	CAP 16 CS229	29 x 2	MAP 16 CS240	40 x 2				
with pegs and plastic cover <sup>1)</sup>	CHP 16 CP	21	MHP 16 CP25	25				
with pegs and plastic cover <sup>1)</sup>	CHP 16 CP2	21 x 2	MHP 16 CP225	25 x 2				
with pegs and plastic cover, high construction <sup>1)</sup>	CAP 16 CP	21	MAP 16 CP32	32				
with pegs and plastic cover, high construction <sup>1)</sup>	CAP 16 CP2	21 x 2	MAP 16 CP232	32 x 2				
with pegs and plastic cover, high construction <sup>1)</sup>	CAP 16 CP29	29	MAP 16 CP40	40				
with pegs and plastic cover, high construction <sup>1)</sup>	CAP 16 CP229	29 x 2	MAP 16 CP240	40 x 2				
with lever and cover					CHP 16 LS	21	MHP 16 LS25	25
with lever and cover					CHP 16 LS2	21 x 2	MHP 16 LS225	25 x 2
with lever and cover, high construction					CAP 16 LS	21	MAP 16 LS32	32
with lever and cover, high construction					CAP 16 LS2	21 x 2	MAP 16 LS232	32 x 2
with lever and cover, high construction					CAP 16 LS29	29	MAP 16 LS40	40
with lever and cover, high construction					CAP 16 LS229	29 x 2	MAP 16 LS240	40 x 2

<sup>1)</sup> may be combined with enclosures:  
- CHO/CAO 16 X and CHV/CAV 16 X  
- MHO/MAO 16 X and MHV/MAV 16 X

**NB:** the enclosures ensure IP66 protection (or IP65 for cover versions) rating when mated and locked with the closing levers.  
The door (CS, CP) only ensures mechanical protection, but does not ensure IP65 protection rating.

dimensions in mm

### CHP - CAP and MHP - MAP

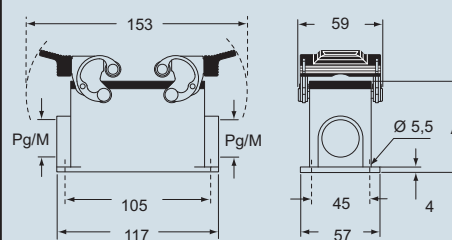

### CHP CS/CP - CAP CS/CP and MHP CS/CP - MAP CS/CP

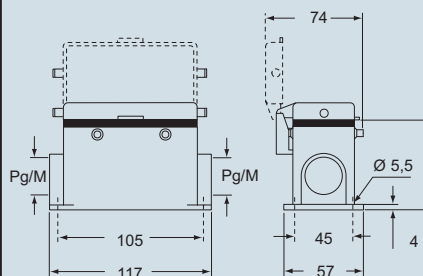

type	A
CHP / MHP	63
CAP / MAP	81
CHP CS / MHP CS	63
CAP CS / MAP CS	81
CHP CP / MHP CP	63
CAP CP / MAP CP	81

dimensions in mm

### CHP L - CAP L and MHP L - MAP L

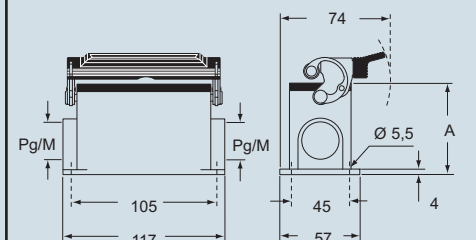

### CHP LS - CAP LS and MHP LS - MAP LS

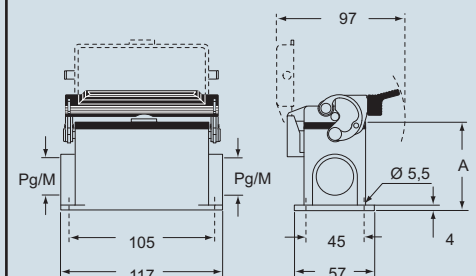

type	A
CHP L / MHP L	63
CAP L / MAP L	81
CHP LS / MHP LS	63
CAP LS / MAP LS	81

**CAV<sup>®</sup>** Type 4/4X/12

(excluding enclosures with plastic cover)



dimensions shown are not binding  
and may be changed without notice

inserts:		page
CD .....	40 poles + ⊕	49
CDD .....	72 poles + ⊕	62
CQE .....	32 poles + ⊕	82
CSH .....	16 poles + ⊕	90
CCE .....	16 poles + ⊕	98
CNE, CSE, JCNE, JCSE	16 poles + ⊕	99 and 108
CSS .....	16 poles + ⊕	120
CMSE .....	6+2 (aux) poles + ⊕	137
CMCE .....	6+2 (aux) poles + ⊕	136
CP .....	6 poles + ⊕	149
CX .....	6/36 and 12/2 poles + ⊕	152+153
CX .....	4/0 and 4/2 poles + ⊕	154
MIXO .....	4 modules	156+195

insert centre distance: 77.5 x 27 mm

## hoods with 4 pegs



## hoods with 2 pegs



description	part no.	entry Pg	part no.	entry M	part no.	entry Pg	part no.	entry M
with pegs, side entry	CHO 16	21	MHO 16.25	25	CHO 16 L	21	MHO 16 L25	25
with pegs, side entry			MHO 16.32	32			MHO 16 L32	32
with pegs, side entry, high construction	CAO 16.21	21	MAO 16.32	32	CAO 16 L21	21	MAO 16 L32	32
with pegs, side entry, high construction	CAO 16.29	29	MAO 16.40	40	CAO 16 L29	29	MAO 16 L40	40
with pegs, top entry	CHV 16	21	MHV 16.25 **	25	CHV 16 L	21	MHV 16 L25	25
with pegs, top entry			MHV 16.32	32			MHV 16 L32	32
with pegs, top entry, high construction	CAV 16.21	21	MAV 16.32	32	CAV 16 L21	21	MAV 16 L32	32
with pegs, top entry, high construction	CAV 16.29	29	MAV 16.40	40	CAV 16 L29	29	MAV 16 L40	40
with pegs, frontal entry, high construction	CAF 16	21	MAF 16.25	25				
with pegs, frontal entry, high constr., without adaptor *	CFF 16	21	MFF 16.25	25				

\* enclosure without adaptor, threaded on the body, to be used only with a complete cable gland.

\*\* can only be used with a complete cable gland (to be purchased separately)

## dimensions in mm

## CHO (CAO) and MHO (MAO)

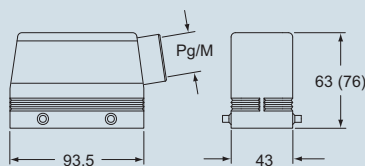

## dimensions in mm

## CHO L (CAO L) and MHO L (MAO L)

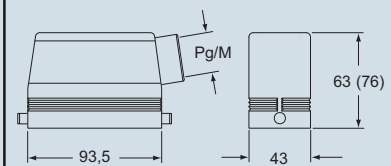

alternatively, hoods with pegs are coupled with fixed enclosures:

- C7, IP67 stainless steel lever, page 254
- CV, IP66 stainless steel lever, page 260
- JEI, IP66 galvanised steel lever, page 288

## CHV (CAV) and MHV (MAV)

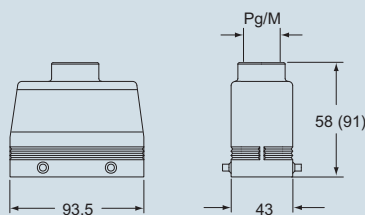

## CHV L (CAV L) and MHV L (MAV L)

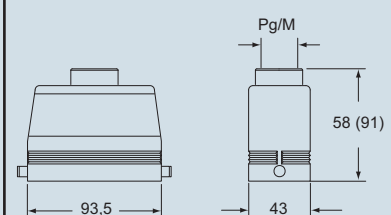

## CAF/CFF and MAF/MFF

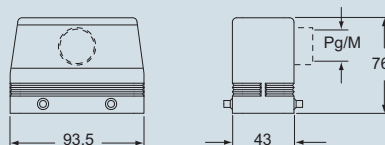

**CALUS** Type 4/4X/12



according to the type of lever

dimensions shown are not binding and may be changed without notice

inserts:		page
CD .....	40 poles + ⊕	49
CDD .....	72 poles + ⊕	62
CQE .....	32 poles + ⊕	82
CSH .....	16 poles + ⊕	90
CCE .....	16 poles + ⊕	98
CNE, CSE, JCNE, JCSE	16 poles + ⊕	99 and 108
CSS .....	16 poles + ⊕	120
CMSE .....	6+2 (aux) poles + ⊕	137
CMCE .....	6+2 (aux) poles + ⊕	136
CP .....	6 poles + ⊕	149
CX .....	6/36 and 12/2 poles + ⊕	152+153
CX .....	4/0 and 4/2 poles + ⊕	154
MIXO .....	4 modules	156+195

insert centre distance: **77.5 x 27 mm**

## hoods with double top entry



## hoods with double front entry



description	part no.	entry Pg	part no.	entry M	part no.	entry Pg	part no.	entry M
with pegs for two levers - used with enclosures size "77.27" - used with enclosures size "77.27"	<b>CAV 16.216</b>	16 x 2	<b>MAV 16.220</b>	20 x 2				
	<b>CAV 16.221</b>	21 x 2	<b>MAV 16.225</b>	25 x 2				
with pegs for 2 lever, without adaptor * - used with enclosures size "77.27" - used with enclosures size "77.27"	<b>CFV 16.216</b>	16 x 2	<b>MFV 16.220</b>	20 x 2				
	<b>CFV 16.221</b>	21 x 2	<b>MFV 16.225</b>	25 x 2				
with pegs for two levers - used with enclosures size "77.27"					<b>CAF 16.221</b>	21 x 2	<b>MAF 16.225</b>	25 x 2
with pegs for 2 lever, without adaptor * - used with enclosures size "77.27"					<b>CFF 16.221</b>	21 x 2	<b>MFF 16.225</b>	25 x 2

\* enclosure without adaptor, threaded on the body, to be used only with a complete cable gland.

dimensions in mm  
**CAV/CFV and MAV/MFV**

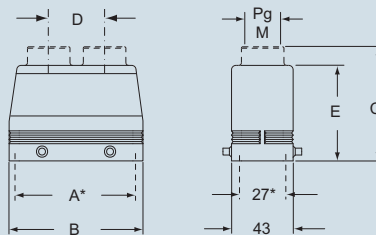

dimensions in mm  
**CAF/CFF and MAF/MFF**

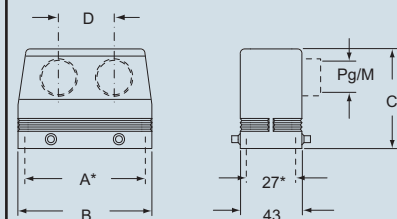

alternatively, hoods with pegs  
are coupled with fixed enclosures:  
- C7, IP67 stainless steel lever, page 254  
- CV, IP66 stainless steel lever, page 260  
- JEI, IP66 galvanised steel lever, page 288

part	A*	B	C	D
<b>CAF/CFF 16.221 / MAF/MFF 16.225</b>	77.5	93.5	76	40

\*) screw fixing centre distance

part	A*	B	C	D	E
<b>CAV 16.216/MAV 16.220</b>	77.5	93.5	89 (90.5)	35 (30)	76
<b>CAV 16.221/MAV 16.225</b>	77.5	93.5	90.5	40	76
<b>CFV 16.216/MFV 16.220</b>	77.5	93.5	—	30 (35)	76
<b>CFV 16.221/MFV 16.225</b>	77.5	93.5	—	40	76

\*) screw fixing centre distance

**CAV<sup>®</sup> US** Type  
4/4X/12



dimensions shown are not binding  
and may be changed without notice



inserts:		page
<b>CD</b> .....	40 poles + ⊕	49
<b>CDD</b> .....	72 poles + ⊕	62
<b>CQE</b> .....	32 poles + ⊕	82
<b>CSH</b> .....	16 poles + ⊕	90
<b>CCE</b> .....	16 poles + ⊕	98
<b>CNE, CSE, JCNE, JCSE</b>	16 poles + ⊕	99 and 108
<b>CSS</b> .....	16 poles + ⊕	120
<b>CMSE</b> .....	6+2 (aux) poles + ⊕	137
<b>CMCE</b> .....	6+2 (aux) poles + ⊕	136
<b>CP</b> .....	6 poles + ⊕	149
<b>CX</b> .....	6/36 and 12/2 poles + ⊕	152 and 153
<b>CX</b> .....	4/0 and 4/2 poles + ⊕	154
<b>MIXO</b> .....	4 modules	156+195

insert centre distance:  
77.5 x 27 mm

### inclined hoods for 2 levers with side entry



**NEW**

### inclined hoods for 2 levers with top entry



**NEW**

description	part no.	entry Pg	part no.	entry M	part no.	entry Pg	part no.	entry M
used with enclosures size "77.27"								
- with pegs for two levers, side entry	<b>CIO 16.36</b>	36	<b>MIO 16.40</b>	40				
- with pegs for two levers, side entry			<b>MIO 16.50</b>	50				
used with enclosures size "77.27"					<b>CIV 16.29</b>	29	<b>MIV 16.40</b>	40
- with pegs for two levers, top entry								

alternatively, hoods with pegs  
are coupled with fixed enclosures:  
- C7, IP67 stainless steel lever, page 254  
- CV, IP66 stainless steel lever, page 260  
- JEI, IP66 galvanised steel lever, page 288

dimensions in mm

**CIO and MIO**

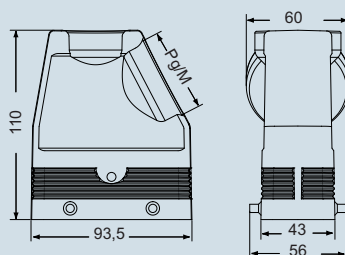

dimensions in mm

**CIV and MIV**

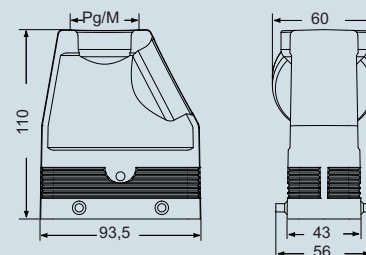

according to the type of lever

dimensions shown are not binding  
and may be changed without notice



inserts:		page
CD .....	40 poles + ⊕	49
CDD .....	72 poles + ⊕	62
CQE .....	32 poles + ⊕	82
CSH .....	16 poles + ⊕	90
CCE .....	16 poles + ⊕	98
CNE, CSE, JCNE, JCSE	16 poles + ⊕	99 and 108
CSS .....	16 poles + ⊕	120
CMSE .....	6+2 (aux) poles + ⊕	137
CMCE .....	6+2 (aux) poles + ⊕	136
CP .....	6 poles + ⊕	149
CX .....	6/36 and 12/2 poles + ⊕	152+153
CX .....	4/0 and 4/2 poles + ⊕	154
MIXO .....	4 modules	156+195

insert centre distance: 77.5 x 27 mm

## hoods with 2 levers



## hoods with 1 lever



description	part no.	entry Pg	part no.	entry M	part no.	entry Pg	part no.	entry M
with levers and gasket, top entry	CHV 16 G	21	MHV 16 G32	32	CHV 16 LG	21	MHV 16 LG32	32
with levers and gasket, top entry, high construction	CAV 16 G	21	MAV 16 G25	25	CAV 16 LG21	21	MAV 16 LG25	25
with levers and gasket, top entry, high construction	CAV 16 G29	29	MAV 16 G32	32	CAV 16 LG29	29	MAV 16 LG32	32
with levers and gasket, top entry, high, without adaptor *	CFV 16 G	21	MFV 16 G25	25	CFV 16 LG21	21	MFV 16 LG25	25
with levers and gasket, top entry, high, without adaptor *	CFV 16 G29	29	MFV 16 G32	32	CFV 16 LG29	29	MFV 16 LG32	32

\* enclosure without adaptor, threaded on the body, to be used only with a complete cable gland.

dimensions in mm

CHV G (CAV G) and [CFV G],  
MHV G (MAV G) and [MFV G]

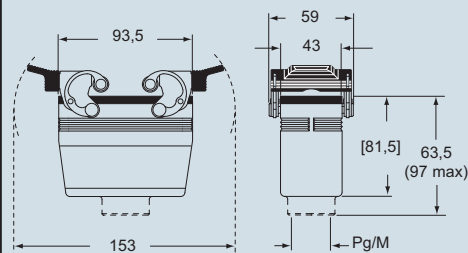

dimensions in mm

CHV LG (CAV LG) and [CFV LG],  
MHV LG (MAV LG) and [MFV LG]

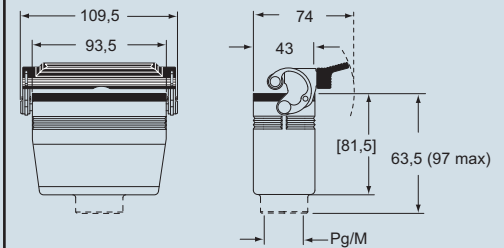

**CALUS** Type  
4/4X/12



dimensions shown are not binding  
and may be changed without notice

inserts:

page:

CD	40	po es + ⊕	49 *
CDD	72	po es + ⊕	62 *
CQE	32	po es + ⊕	82 *
CSH	16	po es + ⊕	90 *
CCE	16	po es + ⊕	98 *
CNE, CSE, JCNE, JCSE	16	po es + ⊕	99 and 108 *
CSS	16	po es + ⊕	120 *
CMSE	6+2 (aux)	po es + ⊕	137 *
CMCE	6+2 (aux)	po es + ⊕	136 *
CP	6	po es + ⊕	149 *
CX	6/36 and 12/2	po es + ⊕	152+153 *
CX	4/0 and 4/2	po es + ⊕	154 *
MIXO	4	modu es	156+195 *
CDS	27	po es + ⊕	8 **

\* refer to catalogue page CN.12

\*\* refer to catalogue page CDS

insert centre distance: 77,5 x 27 mm

hoods with 2 levers

**AVAILABLE**  
**2<sup>nd</sup> QUARTER 2014**

hoods with 1 lever



**AVAILABLE**  
**2<sup>nd</sup> QUARTER 2014**

description	part No	entry M	part No	entry M
with levers and gasket top entry high construction	MAV 16 G40	40	MAV 16 LG40	40
with levers and gasket top entry high without adaptor ***	MFV 16 G40	40	MFV 16 LG40	40

\*\*\* enclosure without adaptor threaded on the body to be used only with a complete cable gland

dimensions in mm

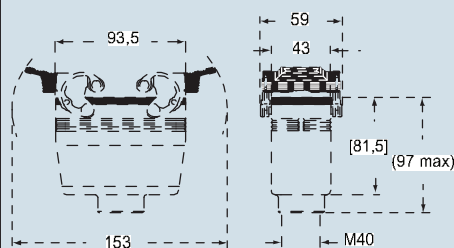
(MAV G) and [MFV G]



dimensions in mm

(MAV LG) and [MFV LG]

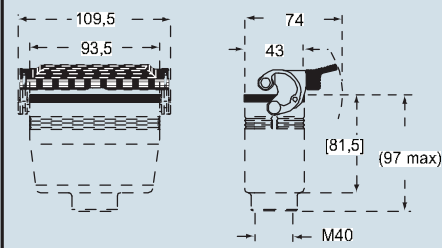
dimensions shown are not binding  
and may be changed without notice

inserts:		page
CD .....	40 poles + ⊕	49
CDD .....	72 poles + ⊕	62
CQE .....	32 poles + ⊕	82
CSH .....	16 poles + ⊕	90
CCE .....	16 poles + ⊕	98
CNE, CSE, JCNE, JCSE	16 poles + ⊕	99 and 108
CSS .....	16 poles + ⊕	120
CMSE .....	6+2 (aux) poles + ⊕	137
CMCE .....	6+2 (aux) poles + ⊕	136
CP .....	6 poles + ⊕	149
CX .....	6/36 and 12/2 poles + ⊕	152 and 153
CX .....	4/0 and 4/2 poles + ⊕	154
MIXO .....	4 modules	156+195

insert centre distance:  
77.5 x 27 mm

### inclined hoods for 2 levers with side entry



**NEW**

### inclined hoods for 2 levers with top entry



**NEW**

description	part no.	entry Pg	part no.	entry M	part no.	entry Pg	part no.	entry M
used with enclosures size "77.27"								
- with pegs for two levers, side entry								
- with pegs for two levers, side entry	<b>CIO 16.36</b>	36	<b>MIO 16.40</b> <b>MIO 16.50</b>	40 50				
used with enclosures size "77.27"								
- with pegs for two levers, top entry					<b>CIV 16.29</b>	29	<b>MIV 16.40</b>	40

alternatively, hoods with pegs  
are coupled with fixed enclosures:  
- C7, IP67 stainless steel lever, page 254  
- CV, IP66 stainless steel lever, page 260  
- JEI, IP66 galvanised steel lever, page 288

dimensions in mm

**CIO and MIO**

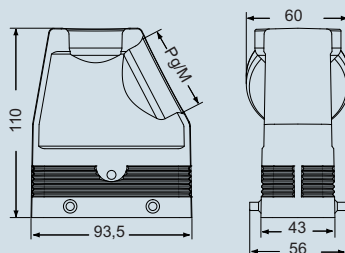

dimensions in mm

**CIV and MIV**

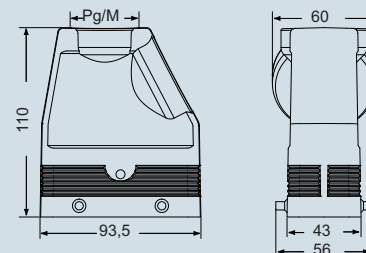

according to the type of lever

dimensions shown are not binding  
and may be changed without notice

inserts:		page
<b>CD</b> .....	40 poles + ⊕	49
<b>CDD</b> .....	72 poles + ⊕	62
<b>CQE</b> .....	32 poles + ⊕	82
<b>CSH</b> .....	16 poles + ⊕	90
<b>CCE</b> .....	16 poles + ⊕	98
<b>CNE, CSE, JCNE, JCSE</b>	16 poles + ⊕	99 and 108
<b>CSS</b> .....	16 poles + ⊕	120
<b>CMSE</b> .....	6+2 (aux) poles + ⊕	137
<b>CMCE</b> .....	6+2 (aux) poles + ⊕	136
<b>CP</b> .....	6 poles + ⊕	149
<b>CX</b> .....	6/36 and 12/2 poles + ⊕	152+153
<b>CX</b> .....	4/0 and 4/2 poles + ⊕	154
<b>MIXO</b> .....	4 modules	156+195

insert centre distance: **77.5 x 27 mm**

## hoods with 2 levers



## hoods with 1 lever



description	part no.	entry Pg	part no.	entry M	part no.	entry Pg	part no.	entry M
with levers and gasket, top entry	<b>CHV 16 G</b>	21	<b>MHV 16 G32</b>	32	<b>CHV 16 LG</b>	21	<b>MHV 16 LG32</b>	32
with levers and gasket, top entry, high construction	<b>CAV 16 G</b>	21	<b>MAV 16 G25</b>	25	<b>CAV 16 LG21</b>	21	<b>MAV 16 LG25</b>	25
with levers and gasket, top entry, high construction	<b>CAV 16 G29</b>	29	<b>MAV 16 G32</b>	32	<b>CAV 16 LG29</b>	29	<b>MAV 16 LG32</b>	32
with levers and gasket, top entry, high, without adaptor *	<b>CFV 16 G</b>	21	<b>MFV 16 G25</b>	25	<b>CFV 16 LG21</b>	21	<b>MFV 16 LG25</b>	25
with levers and gasket, top entry, high, without adaptor *	<b>CFV 16 G29</b>	29	<b>MFV 16 G32</b>	32	<b>CFV 16 LG29</b>	29	<b>MFV 16 LG32</b>	32

\* enclosure without adaptor, threaded on the body, to be used only with a complete cable gland.

dimensions in mm

**CHV G (CAV G) and [CFV G],  
MHV G (MAV G) and [MFV G]**

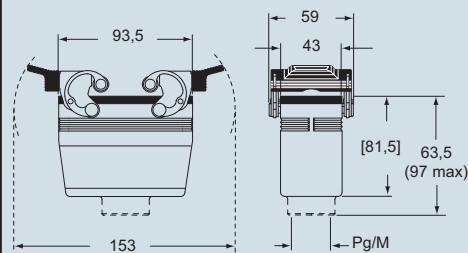

dimensions in mm

**CHV LG (CAV LG) and [CFV LG],  
MHV LG (MAV LG) and [MFV LG]**

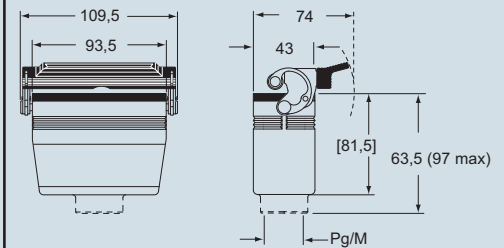

**CALUS** Type  
4/4X/12



dimensions shown are not binding  
and may be changed without notice

inserts:		page
CD .....	40 poles + ⊕	49
CDD .....	72 poles + ⊕	62
CQE .....	32 poles + ⊕	82
CSH .....	16 poles + ⊕	90
CCE .....	16 poles + ⊕	98
CNE, CSE, JCNE, JCSE	16 poles + ⊕	99 and 108
CSS .....	16 poles + ⊕	120
CMSE .....	6+2 (aux) poles + ⊕	137
CMCE .....	6+2 (aux) poles + ⊕	136
CP .....	6 poles + ⊕	149
CX .....	6/36 and 12/2 poles + ⊕	152+153
CX .....	4/0 and 4/2 poles + ⊕	154
MIXO .....	4 modules	156+195

insert centre distance:  
77.5 x 27 mm

## hoods with 2 levers



## covers

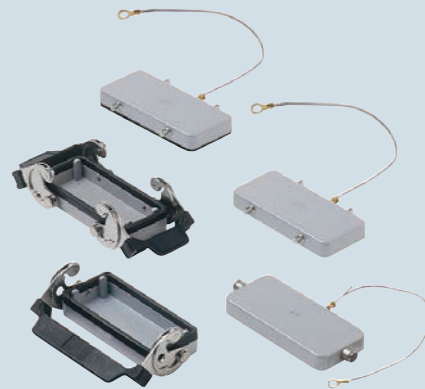

description	part no.	entry Pg	part no.	entry M	part no.
with levers, side entry <sup>1)</sup>	<b>CHO 16 X</b>	21	<b>MHO 16 X25</b>	25	
with levers, side entry <sup>1)</sup>			<b>MHO 16 X32</b>	32	
with levers, side entry, high construction <sup>1)</sup>	<b>CAO 16 X</b>	21	<b>MAO 16 X32</b>	32	
with levers, side entry, high construction <sup>1)</sup>	<b>CAO 16 X29</b>	29	<b>MAO 16 X40</b>	40	
with levers, top entry <sup>1)</sup>	<b>CHV 16 X</b>	21	<b>MHV 16 X25</b>	25	
with levers, top entry <sup>1)</sup>			<b>MHV 16 X32</b>	32	
with levers, top entry, high construction <sup>1)</sup>	<b>CAV 16 X</b>	21	<b>MAV 16 X32</b>	32	
with levers, top entry, high construction <sup>1)</sup>	<b>CAV 16 X29</b>	29	<b>MAV 16 X40</b>	40	
with 4 pegs (for enclosures with 2 levers with gasket)					<b>CHC 16</b>
with 4 pegs and gasket (for enclosures with 2 levers) <sup>2)</sup>					<b>CHC 16 C</b>
with 2 pegs (for enclosures with 1 lever with gasket)					<b>CHC 16 L</b>
with 2 levers (for hoods with 4 pegs)					<b>CHC 16 G</b>
with 1 lever (for hoods with 2 pegs)					<b>CHC 16 LG</b>

<sup>1)</sup> may be combined with enclosures:  
- CHI/CHP/CAP 16 CS/CP/C  
- MHP/MAP 16 CS/CP

<sup>2)</sup> may be combined with enclosures:  
- CHO/CAO 16 X and CHV/CAV 16 X  
- MHO/MAO 16 X and MHV/MAV 16 X

## dimensions in mm

## CHO X (CAO X) and MHO X (MAO X)

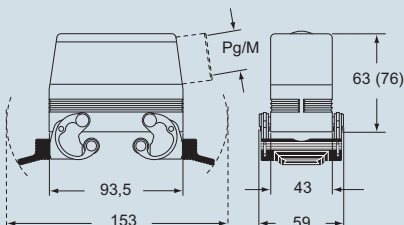

## CHV X (CAV X) and MHV X (MAV X)

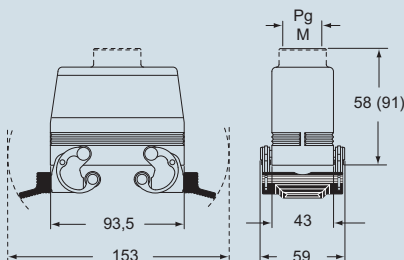

## dimensions in mm

## CHC



## CHC C



## CHC L

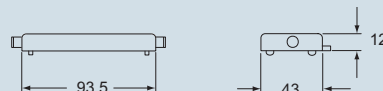

## CHC G

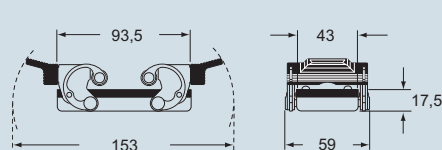

## CHC LG

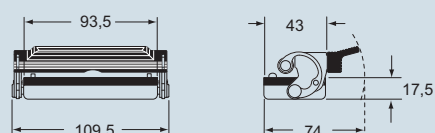

**CALUS** Type  
4/4X/12



dimensions shown are not binding  
and may be changed without notice





inserts:		page
CD .....	64 . poles + ⊕	51
CT, CTS (10A) .....	64 . poles + ⊕	57
CDD .....	108 . poles + ⊕	64
CQE .....	46 . poles + ⊕	83
CSH .....	24 . poles + ⊕	91
CCE .....	24 . poles + ⊕	100
CNE, CSE, JCNE, JCSE .....	24 . poles + ⊕ 101 and 109	
CSS .....	24 . poles + ⊕	121
CT, CTE, CTSE (16A) .....	24 poles + ⊕ 129 and 133	
CMSE .....	10+2 (aux) . poles + ⊕	139
CMCE .....	10+2 (aux) . poles + ⊕	138
CX .....	4/8 . poles + ⊕	155
MIXO .....	6 . modules	156+195

insert centre distance:  
104 x 27 mm

### bulkhead mounting housings with 2 levers or 4 pegs



### bulkhead mounting housings with single lever



description	part no.	part no.
with one or two levers	CHI 24	CHI 24 L
with pegs <sup>1)</sup>	CHI 24 C	
with pegs and aluminum cover <sup>1)</sup>	CHI 24 CS	
with pegs and plastic cover <sup>1)</sup>	CHI 24 CP	
with lever and cover		CHI 24 LS

<sup>1)</sup> may be combined with enclosures:  
- CHO/CAO 24 X and CHV/CAV 24 X  
- MHO/MAO 24 X and MHV/MAV 24 X

**NB:** the enclosures ensure IP66 protection (or IP65 for cover versions) rating when mated and locked with the closing levers.  
The door (CS, CP) only ensures mechanical protection, but does not ensure IP65 protection rating.

panel cut-out for bulkhead mounting housings in mm

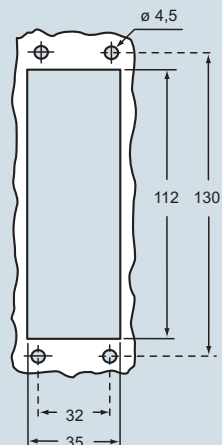

### dimensions in mm

#### CHI

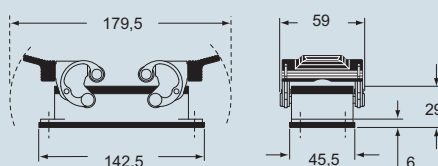

#### CHI C

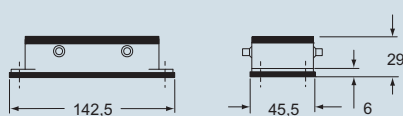

#### CHI CS/CP

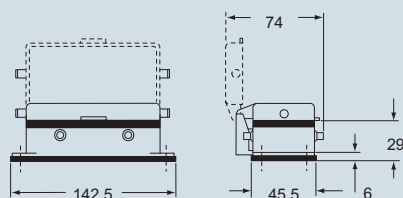

### dimensions in mm

#### CHI L

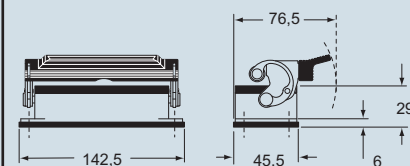

#### CHI LS

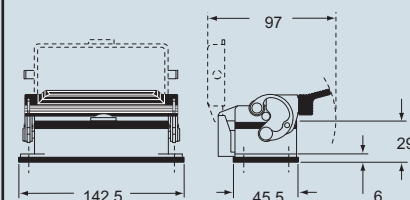

**CAVUS**® Type  
4/4X/12

(excluding enclosures with plastic cover)



dimensions shown are not binding  
and may be changed without notice



inserts:		page
CD .....	64 poles + ⊕	51
CDD .....	108 poles + ⊕	64
CQE .....	46 poles + ⊕	83
CSH .....	24 poles + ⊕	91
CCE .....	24 poles + ⊕	100
CNE, CSE, JCNE, JCSE	24 poles + ⊕	101 and 109
CSS .....	24 poles + ⊕	121
CMSE .....	10+2 (aux) poles + ⊕	139
CMCE .....	10+2 (aux) poles + ⊕	138
CX .....	4/8 poles + ⊕	155
MIXO .....	6 modules	156+195

insert centre distance:  
104 x 27 mm

### surface mounting housings with 2 levers or 4 pegs



### surface mounting housings with single lever

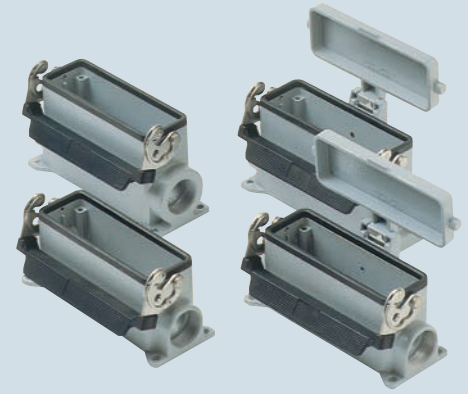

description	part no.	entry Pg	part no.	entry M	part no.	entry Pg	part no.	entry M
with levers	CHP 24	21	MHP 24.25	25	CHP 24 L	21	MHP 24 L25	25
with levers	CHP 24.2	21 x 2	MHP 24.225	25 x 2	CHP 24 L2	21 x 2	MHP 24 L225	25 x 2
with levers, high	CAP 24.21	21	MAP 24.32	32	CAP 24 L	21	MAP 24 L32	32
with levers, high	CAP 24.221	21 x 2	MAP 24.232	32 x 2	CAP 24 L2	21 x 2	MAP 24 L232	32 x 2
with levers, high	CAP 24.29	29	MAP 24.40	40	CAP 24 L29	29	MAP 24 L40	40
with levers, high	CAP 24.229	29 x 2	MAP 24.240	40 x 2	CAP 24 L229	29 x 2	MAP 24 L240	40 x 2
with pegs and aluminum cover <sup>1)</sup>	CHP 24 CS	21	MHP 24 CS25	25				
with pegs and aluminum cover <sup>1)</sup>	CHP 24 CS2	21 x 2	MHP 24 CS225	25 x 2				
with pegs and aluminum cover, high <sup>1)</sup>	CAP 24 CS	21	MAP 24 CS32	32				
with pegs and aluminum cover, high <sup>1)</sup>	CAP 24 CS2	21 x 2	MAP 24 CS232	32 x 2				
with pegs and aluminum cover, high <sup>1)</sup>	CAP 24 CS29	29	MAP 24 CS40	40				
with pegs and aluminum cover, high <sup>1)</sup>	CAP 24 CS229	29 x 2	MAP 24 CS240	40 x 2				
with pegs and plastic cover <sup>1)</sup>	CHP 24 CP	21	MHP 24 CP25	25				
with pegs and plastic cover <sup>1)</sup>	CHP 24 CP2	21 x 2	MHP 24 CP225	25 x 2				
with pegs and plastic cover, high <sup>1)</sup>	CAP 24 CP	21	MAP 24 CP32	32				
with pegs and plastic cover, high <sup>1)</sup>	CAP 24 CP2	21 x 2	MAP 24 CP232	32 x 2				
with pegs and plastic cover, high <sup>1)</sup>	CAP 24 CP29	29	MAP 24 CP40	40				
with pegs and plastic cover, high <sup>1)</sup>	CAP 24 CP229	29 x 2	MAP 24 CP240	40 x 2				
with lever and cover					CHP 24 LS	21	MHP 24 LS25	25
with lever and cover					CHP 24 LS2	21 x 2	MHP 24 LS225	25 x 2
with lever and cover, high					CAP 24 LS	21	MHP 24 LS32	32
with lever and cover, high					CAP 24 LS2	21 x 2	MAP 24 LS232	32 x 2
with lever and cover, high					CAP 24 LS29	29	MAP 24 LS40	40
with lever and cover, high					CAP 24 LS229	29 x 2	MAP 24 LS240	40 x 2

<sup>1)</sup> may be combined with enclosures:  
- CHO/CAO 24 X and CHV/CAV 24 X  
- MHO/MAO 24 X and MHV/MAV 24 X

**NB:** the enclosures ensure IP66 protection (or IP65 for cover versions) rating when mated and locked with the closing levers.  
The cover (CS, CP) only ensures mechanical protection, but does not ensure IP65 protection rating.

dimensions in mm

#### CHP - CAP and MHP - MAP

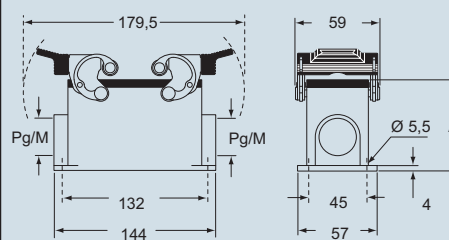

#### CHP CS/CP - CAP CS/CP and MHP CS/CP - MAP CS/CP

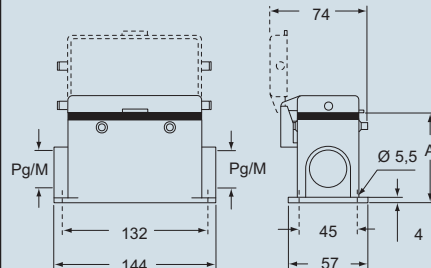

type	A
CHP / MHP	63
CAP / MAP	81
CHP CS / MHP CS	63
CAP CS / MAP CS	81
CHP CP / MHP CP	63
CAP CP / MAP CP	81

dimensions in mm

#### CHP L - CAP L and MHP L - MAP L

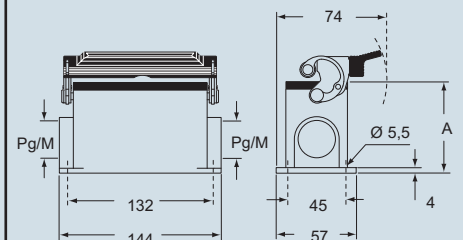

#### CHP LS - CAP LS and MHP LS - MAP LS

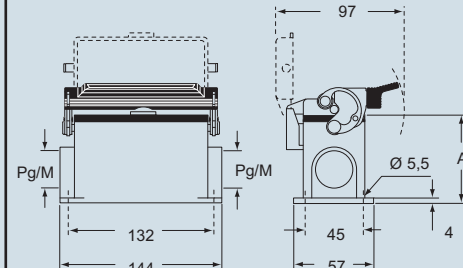

type	A
CHP L / MHP L	63
CAP L / MAP L	81
CHP LS / MHP LS	63
CAP LS / MAP LS	81

**CAVUS** Type 4/4X/12

(excluding enclosures with plastic cover)



dimensions shown are not binding  
and may be changed without notice

inserts:		page
CD .....	64 poles + ⊕	51
CDD .....	108 poles + ⊕	64
CQE .....	46 poles + ⊕	83
CSH .....	24 poles + ⊕	91
CCE .....	24 poles + ⊕	100
CNE, CSE, JCNE, JCSE	24 poles + ⊕ 101 and 109	
CSS .....	24 poles + ⊕	121
CMSE .....	10+2 (aux) poles + ⊕	139
CMCE .....	10+2 (aux) poles + ⊕	138
CX .....	4/8 poles + ⊕	155
MIXO .....	6 modules	156+195

insert centre distance:  
104 x 27 mm

## hoods with 4 pegs



## hoods with 2 pegs



description	part no.	entry Pg	part no.	entry M	part no.	entry Pg	part no.	entry M
with pegs, side entry	CHO 24	21	MHO 24.25	25	CHO 24 L	21	MHO 24 L25	25
with pegs, side entry			MHO 24.32	32			MHO 24 L32	32
with pegs, side entry, high	CAO 24.21	21	MAO 24.32	32	CAO 24 L21	21	MAO 24 L32	32
with pegs, side entry, high	CAO 24.29	29	MAO 24.40	40	CAO 24 L29	29	MAO 24 L40	40
with pegs, top entry	CHV 24	21	MHV 24.25 **	25	CHV 24 L	21	MHV 24 L25	25
with pegs, top entry			MHV 24.32	32			MHV 24 L32	32
with pegs, top entry	CHV 24.29	29	MHV 24.40	40	CHV 24 L29	29	MHV 24 L40	40
with pegs, top entry, high	CAV 24.21	21	MAV 24.32	32	CAV 24 L21	21	MAV 24 L32	32
with pegs, top entry, high	CAV 24.29	29	MAV 24.40	40	CAV 24 L29	29	MAV 24 L40	40
with pegs, frontal entry, high construction	CAF 24.21	21	MAF 24.25	25				
with pegs, frontal entry, high construction	CAF 24.29	29	MAF 24.32	32				
with pegs, frontal entry, high constr., without adaptor *	CFF 24.21	21	MFF 24.25	25				
with pegs, frontal entry, high constr., without adaptor *	CFF 24.29	29	MFF 24.32	32				

\* enclosure without adaptor, threaded on the body, to be used only with a complete cable gland.

\*\* can only be used with a complete cable gland (to be purchased separately)

dimensions in mm

## CHO (CAO) and MHO (MAO)

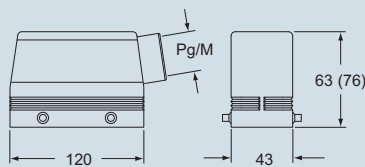

dimensions in mm

## CHO L (CAO L) and MHO L (MAO L)

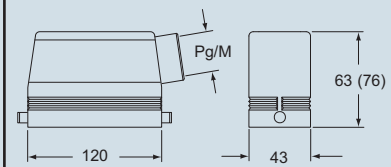

alternatively, hoods with pegs are coupled with fixed enclosures:  
- C7, IP67 stainless steel lever, page 254  
- CV, IP66 stainless steel lever, page 260  
- JEI, IP66 galvanised steel lever, page 288

## CHV (CAV) and MHV (MAV)

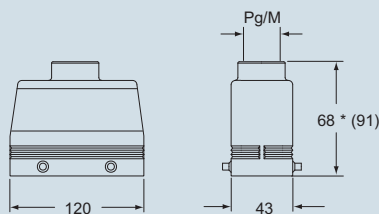

\* 69.5 for Pg 29 - M 40 versions

## CHV L (CAV L) and MHV L (MAV L)

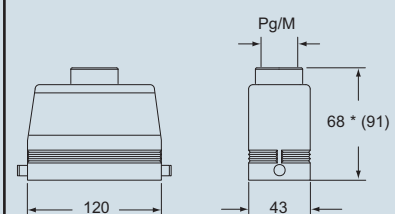

\* 69.5 for Pg 29 - M 40 versions

## CAF/CFF and MAF/MFF

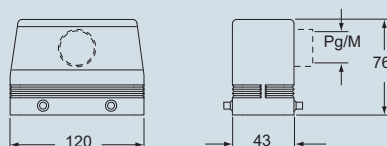

**CALUS** Type 4/4X/12



according to the type of lever

dimensions shown are not binding  
and may be changed without notice

inserts:		page
CD .....	64 poles + ⊕	51
CDD .....	108 poles + ⊕	64
CQE .....	46 poles + ⊕	83
CSH .....	24 poles + ⊕	91
CCE .....	24 poles + ⊕	100
CNE, CSE, JCNE, JCSE	24 poles + ⊕	101 and 109
CSS .....	24 poles + ⊕	121
CMSE .....	10+2 (aux) poles + ⊕	139
CMCE .....	10+2 (aux) poles + ⊕	138
CX .....	4/8 poles + ⊕	155
MIXO .....	6 modules	156+195

insert centre distance:  
104 x 27 mm

## hoods with double top entry and 4 pegs



## hoods with double front entry and 4 pegs



description	part no.	entry Pg	part no.	entry M	part no.	entry Pg	part no.	entry M
with pegs for two levers - used with enclosures size "104.27"	CAV 24.221	21 x 2	MAV 24.232	32 x 2				
- used with enclosures size "104.27"	CAV 24.229	29 x 2						
with pegs for 2 lever, without adaptor *	CFV 24.221	21 x 2	MFV 24.232	32 x 2				
- used with enclosures size "104.27"								
with pegs for two levers - used with enclosures size "104.27"					CAF 24.221	21 x 2	MAF 24.225	25 x 2
with pegs for 2 lever, without adaptor *					CFF 24.221	21 x 2	MFF 24.225	25 x 2
- used with enclosures size "104.27"								

\* enclosure without adaptor, threaded on the body, to be used only with a complete cable gland.

dimensions in mm  
CAV/CFV and MAV/MFV

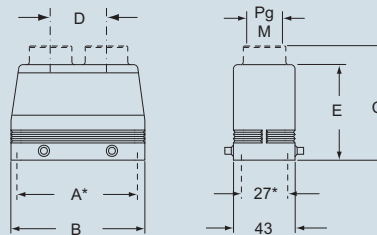

part	A*	B	C	D	E
CAV 24.221/MAV 24.232	104	120	90.5 (91)	50	76
CAV 24.229	104	120	90.5	50	76
CFV 24.221/MFV 24.232	104	120	—	50	76

\*) screw fixing centre distance

dimensions in mm  
CAF/CFF and MAF/MFF

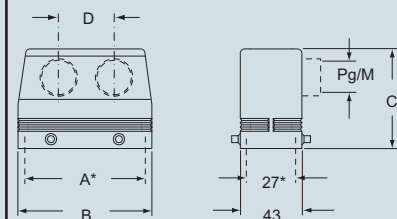

part	A*	B	C	D
CAF/CFF 24.221 / MAF/MFF 24.225	104	120	76	50

\*) screw fixing centre distance

alternatively, hoods with pegs are coupled with fixed enclosures:  
- C7, IP67 stainless steel lever, page 254  
- CV, IP66 stainless steel lever, page 260  
- JEI, IP66 galvanised steel lever, page 288

**CALUS** Type  
4/4X/12



dimensions shown are not binding  
and may be changed without notice

inserts:		page
CD .....	64 poles + ⊕	51
CDD .....	108 poles + ⊕	64
CQE .....	46 poles + ⊕	83
CSH .....	24 poles + ⊕	91
CCE .....	24 poles + ⊕	100
CNE, CSE, JCNE, JCSE	24 poles + ⊕	101 and 109
CSS .....	24 poles + ⊕	121
CMSE .....	10+2 (aux) poles + ⊕	139
CMCE .....	10+2 (aux) poles + ⊕	138
CX .....	4/8 poles + ⊕	155
MIXO .....	6 modules	156÷195

insert centre distance:  
104 x 27 mm

inclined hoods for 2 levers  
with side entry



NEW

inclined hoods for 2 levers  
with top entry



NEW

description	part no.	entry Pg	part no.	entry M	part no.	entry Pg	part no.	entry M
used with enclosures size "104.27" - with pegs for two levers, side entry - with pegs for two levers, side entry	CIO 24.36	36	MIO 24.40 MIO 24.50	40 50				
used with enclosures size "104.27" - with pegs for two levers, top entry - with pegs for two levers, top entry					CIV 24.36	36	MIV 24.40 MIV 24.50	40 50

alternatively, hoods with pegs  
are coupled with fixed enclosures:  
- C7, IP67 stainless steel lever, page 254  
- CV, IP66 stainless steel lever, page 260  
- JEI, IP66 galvanised steel lever, page 288

dimensions in mm

CIO and MIO

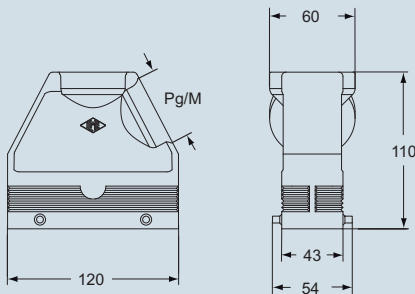

dimensions in mm

CIV and MIV

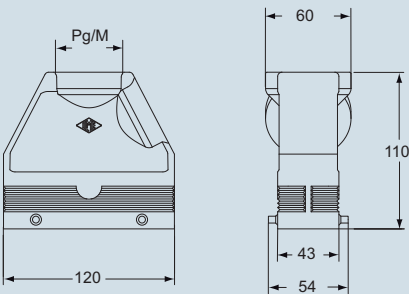

according to the type of lever

dimensions shown are not binding  
and may be changed without notice



inserts:		page
CD .....	64 poles + ⊕	51
CDD .....	108 poles + ⊕	64
CQE .....	46 poles + ⊕	83
CSH .....	24 poles + ⊕	91
CCE .....	24 poles + ⊕	100
CNE, CSE, JCNE, JCSE	24 poles + ⊕	101 and 109
CSS .....	24 poles + ⊕	121
CMSE .....	10+2 (aux) poles + ⊕	139
CMCE .....	10+2 (aux) poles + ⊕	138
CX .....	4/8 poles + ⊕	155
MIXO .....	6 modules	156+195

insert centre distance:  
104 x 27 mm

enlarged hoods,  
side or top entry with 4 pegs

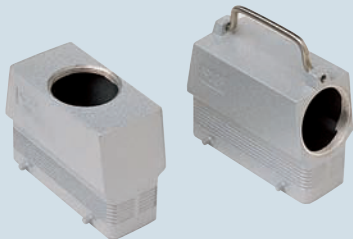

description	part no.	entry Pg	part no.	entry M
used with enclosures size "104.27"				
- with pegs for two levers, side entry	<b>CQO 24</b>	36	<b>MQO 24.40</b>	40
- with pegs for two levers, top entry	<b>CQV 24</b>	36	<b>MQV 24.40</b>	40

alternatively, hoods with pegs  
are coupled with fixed enclosures:  
- C7, IP67 stainless steel lever, page 254  
- CV, IP66 stainless steel lever, page 260  
- JEI, IP66 galvanised steel lever, page 288

dimensions in mm

CQO and MQO

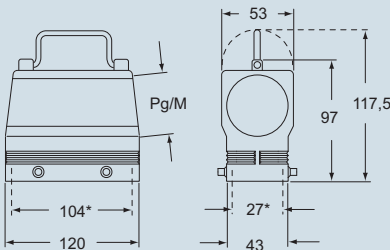

CQV and MQV

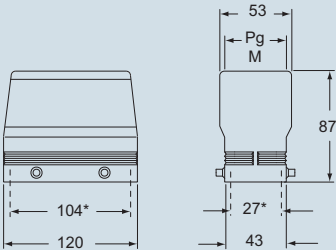

\*) screw fixing centre distance

**CALUS** Type  
4/4X/12



according to the type of lever

dimensions shown are not binding  
and may be changed without notice

inserts:		page
CD .....	64 poles + ⊕	51
CDD .....	108 poles + ⊕	64
CQE .....	46 poles + ⊕	83
CSH .....	24 poles + ⊕	91
CCE .....	24 poles + ⊕	100
CNE, CSE, JCNE, JCSE .....	24 poles + ⊕ 101 and 109	
CSS .....	24 poles + ⊕	121
CMSE .....	10+2 (aux) poles + ⊕	139
CMCE .....	10+2 (aux) poles + ⊕	138
CX .....	4/8 poles + ⊕	155
MIXO .....	6 modules	156+195

insert centre distance:  
104 x 27 mm

## hoods with 2 levers



## hoods with 1 lever



description	part no.	entry Pg	part no.	entry M	part no.	entry Pg	part no.	entry M
with levers and gasket, top entry	CHV 24 G	21	MHV 24 G32	32	CHV 24 LG	21	MHV 24 LG32	32
with levers and gasket, top entry, high construction	CAV 24 G	21	MAV 24 G25	25	CAV 24 LG21	21	MAV 24 LG25	25
with levers and gasket, top entry, high construction	CAV 24 G29	29	MAV 24 G32	32	CAV 24 LG29	29	MAV 24 LG32	32
with levers and gasket, top entry, high, without adapter *	CFV 24 G	21	MFV 24 G25	25	CFV 24 LG21	21	MFV 24 LG25	25
with levers and gasket, top entry, high, without adapter *	CFV 24 G29	29	MFV 24 G32	32	CFV 24 LG29	29	MFV 24 LG32	32

\* enclosure without adaptor, threaded on the body, to be used only with a complete cable gland.

dimensions in mm

CHV G (CAV G) and [CFV G],  
MHV G (MAV G) and [MFV G]

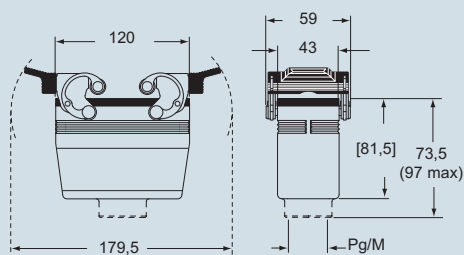

dimensions in mm

CHV LG (CAV LG) and [CFV LG],  
MHV LG (MAV LG) and [MFV LG]

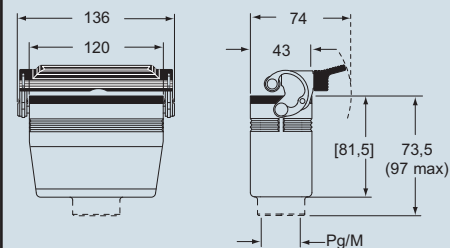

**CALUS** Type  
4/4X/12



dimensions shown are not binding  
and may be changed without notice

inserts:

page:

CD	64	po es + ⊕	51 *
CDD	108	po es + ⊕	64 *
CQE	46	po es + ⊕	83 *
CSH	24	po es + ⊕	91 *
CCE	24	po es + ⊕	100 *
CNE, CSE, JCNE, JCSE	24	po es + ⊕	101 and 109 *
CSS	24	po es + ⊕	121 *
CMSE	10+2 (aux)	po es + ⊕	139 *
CMCE	10+2 (aux)	po es + ⊕	138 *
CX	4/8	po es + ⊕	155 *
MIXO	6	modu es	156+195 *
CDS	42	po es + ⊕	9 **

\* refer to catalogue page CN.12

\*\* refer to catalogue page CDS

insert centre distance: 104 x 27 mm

hoods with 2 levers

**AVAILABLE  
2<sup>nd</sup> QUARTER 2014**

hoods with 1 lever



**AVAILABLE  
2<sup>nd</sup> QUARTER 2014**

description	part No	entry M	part No	entry M
with levers and gasket top entry high construction	MAV 24 G40	40	MAV 24 LG40	40
with levers and gasket top entry high without adaptor ***	MFV 24 G40	40	MFV 24 LG40	40

\*\*\* enclosure without adaptor threaded on the body to be used only with a complete cable gland

dimensions in mm

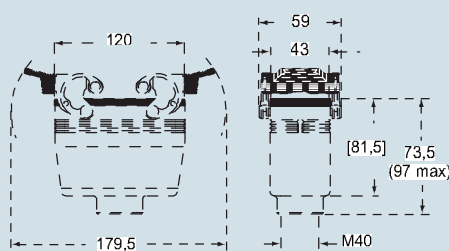
(MAV G) and [MFV G]



dimensions in mm

(MAV LG) and [MFV LG]

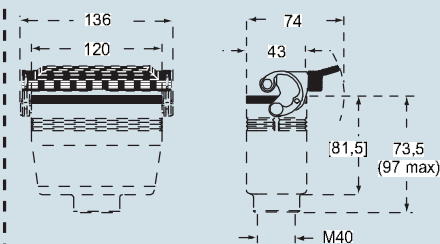

dimensions shown are not binding  
and may be changed without notice



inserts:		page
CD .....	64 poles + ⊕	51
CDD .....	108 poles + ⊕	64
CQE .....	46 poles + ⊕	83
CSH .....	24 poles + ⊕	91
CCE .....	24 poles + ⊕	100
CNE, CSE, JCNE, JCSE	24 poles + ⊕	101 and 109
CSS .....	24 poles + ⊕	121
CMSE .....	10+2 (aux) poles + ⊕	139
CMCE .....	10+2 (aux) poles + ⊕	138
CX .....	4/8 poles + ⊕	155
MIXO .....	6 modules	156+195

insert centre distance: **104 x 27 mm**

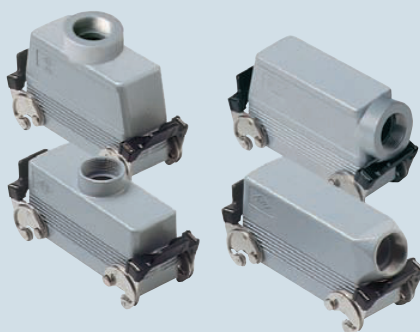
## hoods with 2 levers



## covers

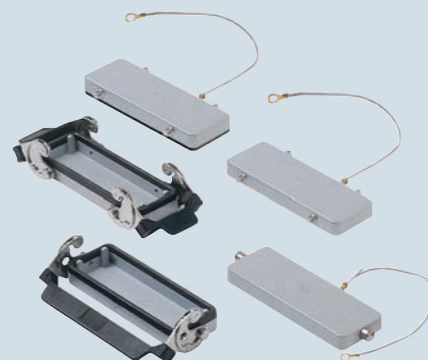

description	part no.	entry Pg	part no.	entry M	part no.
with levers, side entry <sup>1)</sup>	<b>CHO 24 X</b>	21	<b>MHO 24 X25</b>	25	
with levers, side entry <sup>1)</sup>			<b>MHO 24 X32</b>	32	
with levers, side entry, high <sup>1)</sup>	<b>CAO 24 X</b>	21	<b>MAO 24 X32</b>	32	
with levers, side entry, high <sup>1)</sup>	<b>CAO 24 X29</b>	29	<b>MAO 24 X40</b>	40	
with levers, top entry <sup>1)</sup>	<b>CHV 24 X</b>	21	<b>MHV 24 X25</b>	25	
with levers, top entry <sup>1)</sup>			<b>MHV 24 X32</b>	32	
with levers, top entry, high <sup>1)</sup>	<b>CAV 24 X</b>	21	<b>MAV 24 X32</b>	32	
with levers, top entry, high <sup>1)</sup>	<b>CAV 24 X29</b>	29	<b>MAV 24 X40</b>	40	
with 4 pegs (for enclosures with 2 levers with gasket)					<b>CHC 24</b>
with 4 pegs and gasket (for enclosures with 2 levers) <sup>2)</sup>					<b>CHC 24 C</b>
with 2 pegs (for enclosures with 1 lever with gasket)					<b>CHC 24 L</b>
with 2 levers (for hoods with 4 pegs)					<b>CHC 24 G</b>
with 1 lever (for hoods with 2 pegs)					<b>CHC 24 LG</b>

<sup>1)</sup> may be combined with enclosures:

- CHI/CHP/CAP 24 CS/CP/C
- MHP/MAP 24 CS/CP

<sup>2)</sup> may be combined with enclosures:

- CHO/CAO 24 X and CHV/CAV 24 X
- MHO/MAO 24 X and MHV/MAV 24 X

## dimensions in mm

## CHO X (CAO X) and MHO X (MAO X)

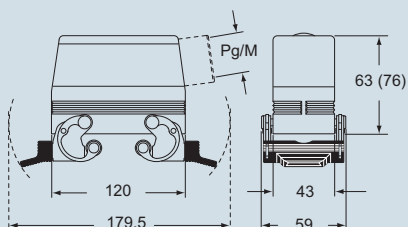

## CHV X (CAV X) and MHV X (MAV X)

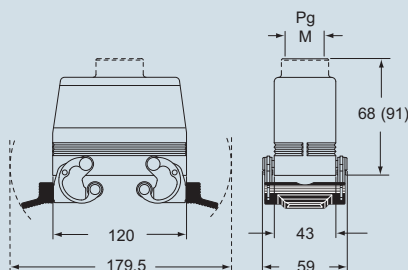

## dimensions in mm

## CHC



## CHC C



## CHC L



## CHC G

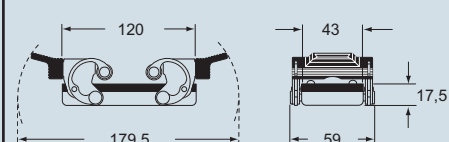

## CHC LG

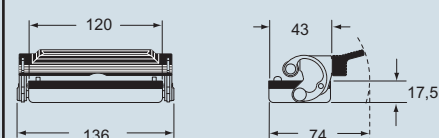

**CAI<sup>®</sup> US** Type  
4/4X/12



dimensions shown are not binding  
and may be changed without notice

inserts:		page
CD .....	80 poles + ⊕	52
CDD .....	144 poles + ⊕	65
CQE .....	64 poles + ⊕	84
CSH .....	32 poles + ⊕	92
CCE .....	32 poles + ⊕	102
CNE, CSE, JCNE, JCSE	32 poles + ⊕	103 and 110
CSS .....	32 poles + ⊕	122
CMSE .....	12+4 (aux) poles + ⊕	141
CMCE .....	12+4 (aux) poles + ⊕	140
CME .....	12+4 (aux) poles + ⊕	141
CP .....	12 poles + ⊕	150
MIXO .....	4 + 4 modules	156÷195

insert centre distance:  
2 x (77.5 x 27) mm

### bulkhead mounting housings with 2 levers or 4 pegs



### bulkhead mounting housings with single lever



#### description

with one or two levers

CHI 32

CHI 32 L

with pegs and cover <sup>1)</sup>

CHI 32 CS

with lever and cover

CHI 32 LS

<sup>1)</sup> may be combined with enclosures:

- CHO/CHV/CFO/CFV 32 X
- MHO/MHV/MFO/MFV 32 X

**NB:** the enclosures ensure IP66 protection (or IP65 for cover versions) rating when mated and locked with the closing levers.

The cover (CS) only ensures mechanical protection, but does not ensure IP65 protection rating.

panel cut-out for bulkhead mounting housings in mm

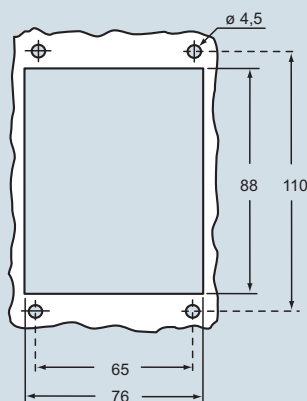

dimensions in mm

#### CHI

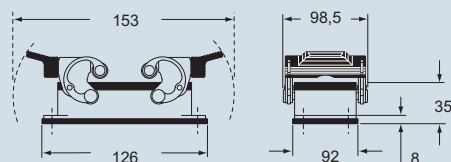

#### CHI CS

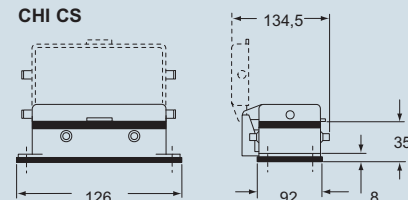

dimensions in mm

#### CHI L

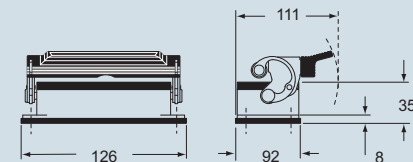

#### CHI LS

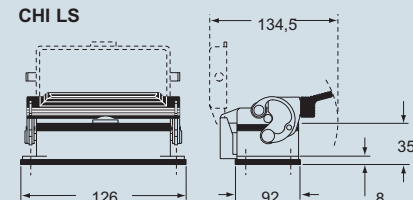

**CALUS** Type  
4/4X/12



dimensions shown are not binding  
and may be changed without notice

inserts:		page
CD .....	80 poles + ⊕	52
CDD .....	144 poles + ⊕	65
CQE .....	64 poles + ⊕	84
CSH .....	32 poles + ⊕	92
CCE .....	32 poles + ⊕	102
CNE, CSE, JCNE, JCSE	32 poles + ⊕	103 and 110
CSS .....	32 poles + ⊕	122
CMSE .....	12+4 (aux) poles + ⊕	141
CMCE .....	12+4 (aux) poles + ⊕	140
CME .....	12+4 (aux) poles + ⊕	141
CP .....	12 poles + ⊕	150
MIXO .....	4 + 4 modules	156÷195

insert centre distance:  
2 x (77.5 x 27) mm

### surface mounting housing with 2 levers

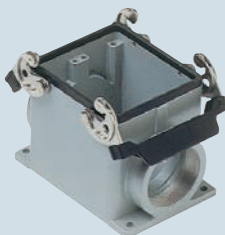

### surface mounting housings with single lever



description	part no.	entry Pg	part no.	entry M	part no.	entry Pg	part no.	entry M
with one or two levers	CHP 32.29	29	MHP 32.40	40	CHP 32 L29	29	MHP 32 L40	40
with one or two levers	CHP 32.229	29 x 2	MHP 32.240	40 x 2	CHP 32 L229	29 x 2	MHP 32 L240	40 x 2
with one or two levers	CHP 32	36	MHP 32.50	50	CHP 32 L	36	MHP 32 L50	50
with one or two levers	CHP 32.2	36 x 2	MHP 32.250	50 x 2	CHP 32 L2	36 x 2	MHP 32 LS250	50 x 2
with one or two levers	CHP 32.42	42			CHP 32 L42	42		
with one or two levers	CHP 32.242	42 x 2			CHP 32 L242	42 x 2		
with lever and cover					CHP 32 LS29	29	MHP 32 LS40	40
with lever and cover					CHP 32 LS229	29 x 2	MHP 32 LS240	40 x 2
with lever and cover					CHP 32 LS	36	MHP 32 LS50	50
with lever and cover					CHP 32 LS2	36 x 2	MHP 32 LS250	50 x 2
with lever and cover					CHP 32 LS42	42		
with lever and cover					CHP 32 LS242	42 x 2		

**NB:** the enclosures ensure IP66 protection (or IP65 for cover versions) rating when mated and locked with the closing levers.

The cover (CS) only ensures mechanical protection, but does not ensure IP65 protection rating.

### dimensions in mm

#### CHP and MHP

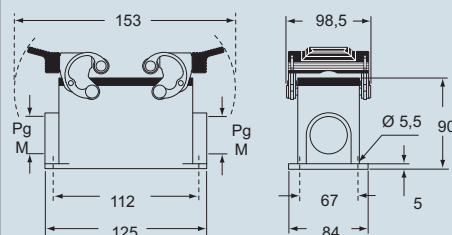

### dimensions in mm

#### CHP L and MHP L

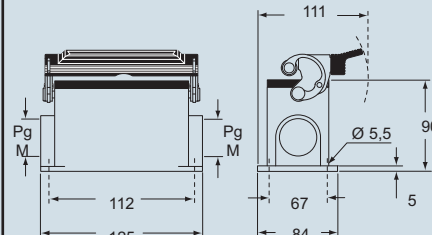

#### CHP LS and MHP LS

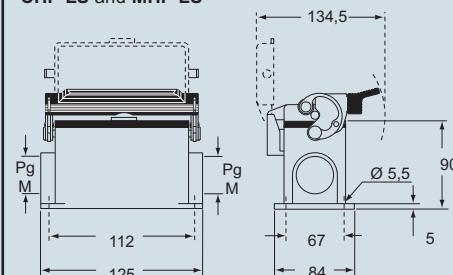

**CALUS**® Type  
4/4X/12



dimensions shown are not binding  
and may be changed without notice

inserts:		page
CD .....	80 poles + ⊕	52
CDD .....	144 poles + ⊕	65
CQE .....	64 poles + ⊕	84
CSH .....	32 poles + ⊕	92
CCE .....	32 poles + ⊕	102
CNE, CSE, JCNE, JCSE ..	32 poles + ⊕ 103 and 110	
CSS .....	32 poles + ⊕	122
CMSE .....	12+4 (aux) poles + ⊕	141
CMCE .....	12+4 (aux) poles + ⊕	140
CME .....	12+4 (aux) poles + ⊕	141
CP .....	12 poles + ⊕	150
MIXO .....	4 + 4 modules	156+195

insert centre distance:  
2 x (77.5 x 27) mm

## hoods with 4 pegs and 2 levers



## hoods with 2 pegs and 1 lever



description	part no.	entry Pg	part no.	entry M	part no.	entry Pg	part no.	entry M
with pegs, side entry	CHO 32.29	29	MHO 32.32	32	CHO 32 L	36	MHO 32 L40	40
with pegs, side entry	CHO 32	36	MHO 32.40	40				
with pegs, side entry	CHO 32.42	42	MHO 32.50	50				
with pegs, side entry, without adaptor *	CFO 32.29	29	MFO 32.32	32	CFO 32 L	36	MFO 32 L40	40
with pegs, side entry, without adaptor *	CFO 32	36	MFO 32.40	40				
with pegs, side entry, without adaptor *	CFO 32.42	42	MFO 32.50	50				
with pegs, top entry	CHV 32.29	29	MHV 32.32	32	CHV 32 L	36	MHV 32 L40	40
with pegs, top entry	CHV 32	36	MHV 32.40	40				
with pegs, top entry	CHV 32.42	42	MHV 32.50	50				
with pegs, top entry, without adaptor *	CFV 32.29	29	MFV 32.32	32	CFV 32 L	36	MFV 32 L40	40
with pegs, top entry, without adaptor *	CFV 32	36	MFV 32.40	40				
with pegs, top entry, without adaptor *	CFV 32.42	42	MFV 32.50	50				
with levers and gasket, top entry	CHV 32 G29	29	MHV 32 G32	32	CHV 32 LG	36	MHV 32 LG40	40
with one or two levers and gasket, top entry	CHV 32 G	36	MHV 32 G40	40				
with levers and gasket, top entry	CHV 32 G42	42	MHV 32 G50	50				
with levers and gasket, top entry, without adaptor *	CFV 32 G29	29	MFV 32 G32	32	CFV 32 LG	36	MFV 32 LG40	40
with lever/s and gasket, top entry, without adaptor *	CFV 32 G	36	MFV 32 G40	40				
with levers and gasket, top entry, without adaptor *	CFV 32 G42	42	MFV 32 G50	50				

\* enclosure without adaptor, threaded on the body, to be used only with a complete cable gland.

dimensions in mm

## CHO/CFO and MHO/MFO

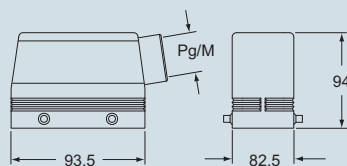

## CHV/CFV and MHV/MFV

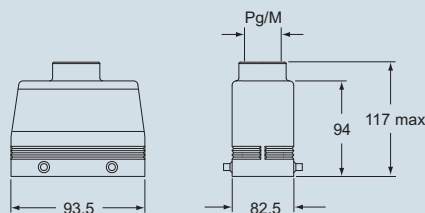

## CHV/CFV G and MHV/MFV G

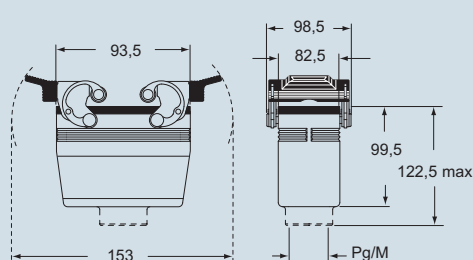

dimensions in mm

## CHO/CFO L and MHO/MFO L

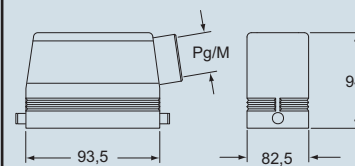

## CHV/CFV L and MHV/MFV L

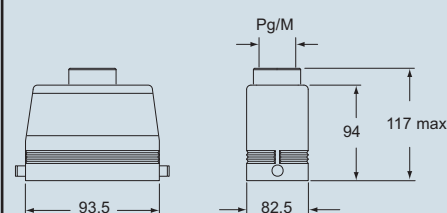

## CHV/CFV LG and MHV/MFV LG

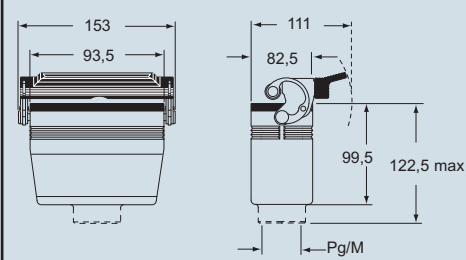

**CAVUS** Type  
4/4X/12



dimensions shown are not binding  
and may be changed without notice

inserts:		page
CD .....	80 poles + ⊕	52
CDD .....	144 poles + ⊕	65
CQE .....	64 poles + ⊕	84
CSH .....	32 poles + ⊕	92
CCE .....	32 poles + ⊕	102
CNE, CSE, JCNE, JCSE	32 poles + ⊕ 103 and 110	
CSS .....	32 poles + ⊕	122
CMSE .....	12+4 (aux) poles + ⊕	141
CMCE .....	12+4 (aux) poles + ⊕	140
CME .....	12+4 (aux) poles + ⊕	141
CP .....	12 poles + ⊕	150
MIXO .....	4 + 4 modules	156÷195

insert centre distance: 2 x (77.5 x 27) mm

Cover versions C, G and LG cannot be used together with coding pins. If this application is required, please contact ILME SpA.

## hoods with 2 levers



## covers

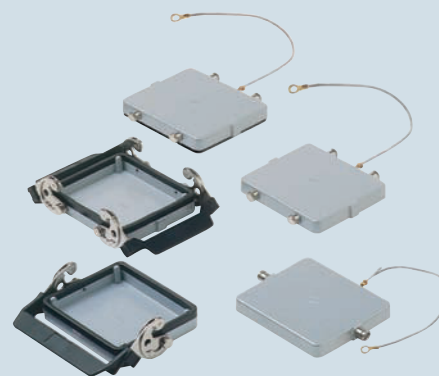

description	part no.	entry Pg	part no.	entry M	part no.
with levers, side entry <sup>1)</sup>	<b>CHO 32 X</b>	36	<b>MHO 32 X40</b>	40	
with levers, side entry, without adaptor * <sup>1)</sup>	<b>CFO 32 X</b>	36	<b>MFO 32 X40</b>	40	
with levers, top entry <sup>1)</sup>	<b>CHV 32 X</b>	36	<b>MHV 32 X40</b>	40	
with levers, top entry, without adaptor * <sup>1)</sup>	<b>CFV 32 X</b>	36	<b>MFV 32 X40</b>	40	
with 4 pegs (for enclosures with 2 levers with gasket) with 4 pegs and gasket (for enclosures with 2 levers) <sup>2)</sup> with 2 pegs (for enclosures with 1 lever with gasket)					<b>CHC 32</b> <b>CHC 32 C</b> <b>CHC 32 L</b>
with 2 levers (for hoods with 4 pegs) with 1 lever (for hoods with 2 pegs)					<b>CHC 32 G</b> <b>CHC 32 LG</b>

\* enclosure without adaptor, threaded on the body, to be used only with a complete cable gland.

<sup>1)</sup> may be combined with CHI 32 CS enclosures

<sup>2)</sup> may be combined with enclosures:  
- CHO/CFO 32 X and CHV/CFV 32 X  
- MHO/MFO 32 X and MHV/MFV 32 X

## dimensions in mm

## CHO/CFO X and MHO/MFO X

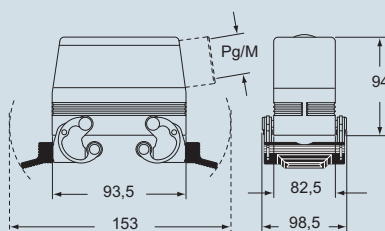

## CHV/CFV X and MHV/MFV X

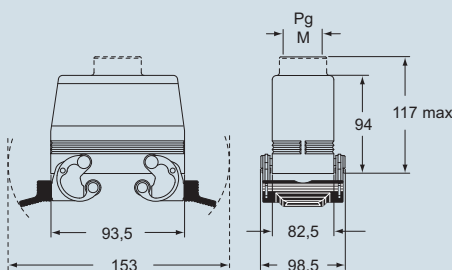

## dimensions in mm

## CHC

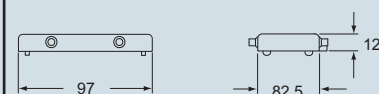

## CHC C



## CHC L

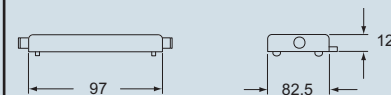

## CHC G

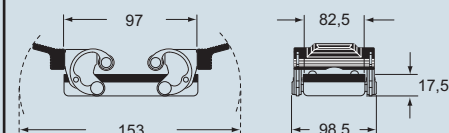

## CHC LG

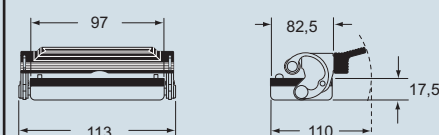

**CALUS**® Type  
4/4X/12



dimensions shown are not binding  
and may be changed without notice

inserts:		page
CD .....	128 poles + ⊕	53
CDD .....	216 poles + ⊕	66
CQE .....	92 poles + ⊕	85
CSH .....	48 poles + ⊕	93
CCE .....	48 poles + ⊕	104
CNE, CSE, JCNE, JCSE	48 poles + ⊕ 105 and 111	
CSS .....	48 poles + ⊕	123
CMSE .....	20+4 (aux) poles + ⊕	143
CMCE .....	20+4 (aux) poles + ⊕	142
CME .....	20+4 (aux) poles + ⊕	143
CME .....	32+4 (aux) poles + ⊕	147
CMCE .....	32+4 (aux) poles + ⊕	146
MIXO .....	6 + 6 modules	156+195

insert centre distance:  
2 x (104 x 27) mm

### bulkhead and surface mounting enclosures with single lever



### hoods with 2 pegs



description	part no.	entry Pg	part no.	entry M	part no.	entry Pg	part no.	entry M
bulkhead mounting enclosures with lever	CHI 48 L	—						
bulkhead mounting enclosures with lever and cover	CHI 48 LS	—						
surface mounting enclosures with lever and cover	CHP 48 LS29	29 x 2	MHP 48 LS40	40 x 2				
surface mounting enclosures with lever and cover	CHP 48 LS	36 x 2	MHP 48 LS50	50 x 2				
with pegs, side entry					CHO 48 L29	29	MHO 48 L32	32
with pegs, side entry					CHO 48 L	36	MHO 48 L40	40
with pegs, side entry					CHO 48 L42	42	MHO 48 L50	50
with pegs, side entry, without adaptor *					CFO 48 L29	29	MFO 48 L32	32
with pegs, side entry, without adaptor *					CFO 48 L	36	MFO 48 L40	40
with pegs, side entry, without adaptor *					CFO 48 L42	42	MFO 48 L50	50
with pegs, top entry					CHV 48 L29	29	MHV 48 L32	32
with pegs, top entry					CHV 48 L	36	MHV 48 L40	40
with pegs, top entry					CHV 48 L42	42	MHV 48 L50	50
with pegs, top entry, without adaptor *					CFV 48 L29	29	MFV 48 L32	32
with pegs, top entry, without adaptor *					CFV 48 L	36	MFV 48 L40	40
with pegs, top entry, without adaptor *					CFV 48 L42	42	MFV 48 L50	50

\* enclosure without adaptor, threaded on the body, to be used only with a complete cable gland.

panel cut-out for bulkhead mounting housings in mm

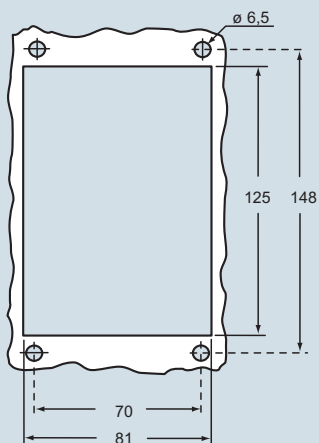

**NB:** the enclosures ensure IP66 protection (or IP65 for cover versions) rating when mated and locked with the closing levers.

dimensions in mm

#### CHI L - LS

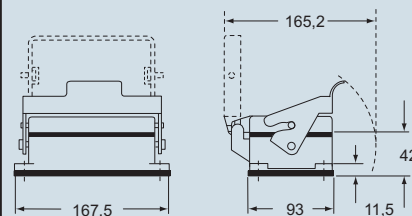

#### CHP LS and MHP LS

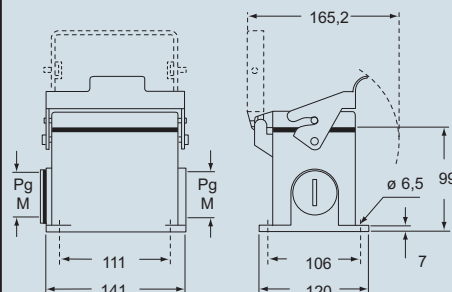

dimensions in mm

#### CHO/CFO L and MHO/MFO L

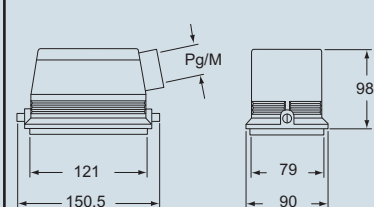

#### CHV/CFV L and MHV/MFV L

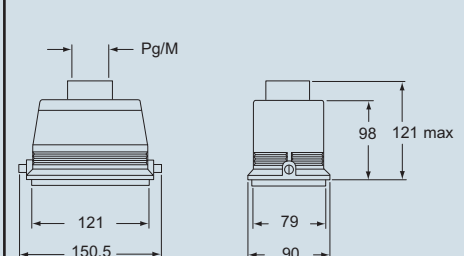

**cRU<sup>®</sup> US** Type 4/4X/12



dimensions shown are not binding  
and may be changed without notice