

Cable fittings and accessories

Metal accessories reducing ring RR

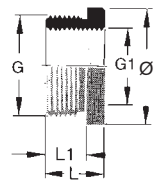

Properties

- Reducing ring from **metric to metric** or **PG to PG**
- with large outer thread and small inner thread

Design

- Material Brass nickel-plated

Part-No.	Type	G	G1	Outer- \varnothing mm	L mm	L 1 mm	weight approx. kg/100 piece	PU piece
RR metric metric/metric								
600220	RR M 16/M 12	M 16x1.5	M 12x1.5	18.0	7.5	6.0	0.64	100
600221	RR M 20/M 12	M 20x1.5	M 12x1.5	24.0	8.5	6.5	1.57	100
600222	RR M 20/M 16	M 20x1.5	M 16x1.5	24.0	9.0	6.5	0.95	100
600223	RR M 25/M 16	M 25x1.5	M 16x1.5	28.0	10.0	7.0	2.70	100
600224	RR M 25/M 20	M 25x1.5	M 20x1.5	28.0	10.0	7.0	1.81	100
600225	RR M 32/M 20	M 32x1.5	M 20x1.5	34.0	11.5	8.0	4.62	50
600226	RR M 32/M 25	M 32x1.5	M 25x1.5	34.0	11.5	8.0	3.00	50
600227	RR M 40/M 25	M 40x1.5	M 25x1.5	45.0	11.5	8.0	7.60	25
600228	RR M 40/M 32	M 40x1.5	M 32x1.5	45.0	11.5	8.0	4.50	25
600229	RR M 50/M 32	M 50x1.5	M 32x1.5	55.0	14.0	10.0	13.00	10
600230	RR M 50/M 40	M 50x1.5	M 40x1.5	55.0	14.0	10.0	7.50	10
600231	RR M 63/M 40	M 63x1.5	M 40x1.5	64.0	14.0	10.0	21.50	10
600232	RR M 63/M 50	M 63x1.5	M 50x1.5	64.0	14.0	10.0	12.50	10
RR PG PG/PG								
600400	RR PG 9/PG 7	PG 9	PG 7	17.0	8.5	6.0	0.45	100
600411	RR PG 11/PG 7	PG 11	PG 7	20.0	8.5	6.0	1.20	100
600401	RR PG 11/PG 9	PG 11	PG 9	20.0	8.5	6.0	0.65	100
600408	RR PG 13.5/PG 9	PG 13.5	PG 9	22.0	9.0	6.5	1.01	100
600402	RR PG 13.5/PG 11	PG 13.5	PG 11	22.0	9.0	6.5	0.47	100
600409	RR PG 16/PG 9	PG 16	PG 9	24.0	9.5	6.5	0.85	100
600410	RR PG 16/PG 11	PG 16	PG 11	24.0	9.5	6.5	1.01	100
600403	RR PG 16/PG 13.5	PG 16	PG 13.5	24.0	9.5	6.5	0.59	100
600413	RR PG 21/PG 11	PG 21	PG 11	30.0	10.0	7.0	2.90	50
600414	RR PG 21/PG 13.5	PG 21	PG 13.5	30.0	10.0	7.0	1.23	50
600404	RR PG 21/PG 16	PG 21	PG 16	30.0	10.0	7.0	1.95	50
600407	RR PG 29/PG 16	PG 29	PG 16	39.0	11.5	8.0	6.42	50
600405	RR PG 29/PG 21	PG 29	PG 21	39.0	11.5	8.0	4.34	50
600412	RR PG 36/PG 21	PG 36	PG 21	50.0	12.5	9.0	11.40	25
600406	RR PG 36/PG 29	PG 36	PG 29	50.0	12.5	9.0	3.42	25
600416	RR PG 42/PG 36	PG 42	PG 36	57.0	14.0	10.0	7.00	10
600417	RR PG 48/PG 36	PG 48	PG 36	64.0	14.0	10.0	12.80	10
600415	RR PG 48/PG 42	PG 48	PG 42	64.0	14.0	10.0	6.40	10

Cable fittings and accessories

Metal accessory expansion EW



Properties

- Expansion from **metric to metric** or **PG to PG**
- with small outer thread and large inner thread

Design

- Material Brass nickel-plated

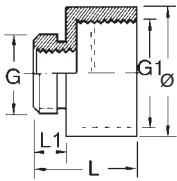

Part-No.	Type	G	G1	Outer- \varnothing mm	L mm	L 1 mm	weight approx. kg/100 piece	PU piece
EW metric metric/metric								
600280	EW M 12/M 16	M 12x1.5	M 16x1.5	18.0	15.5	9.0	0.93	100
600281	EW M 16/M 20	M 16x1.5	M 20x1.5	22.0	17.5	10.0	1.39	100
600282	EW M 20/M 25	M 20x1.5	M 25x1.5	27.0	20.0	6.0	2.14	100
600283	EW M 25/M 32	M 25x1.5	M 32x1.5	34.0	21.0	7.0	3.10	100
600284	EW M 32/M 40	M 32x1.5	M 40x1.5	42.0	23.0	8.0	13.00	50
600285	EW M 40/M 50	M 40x1.5	M 50x1.5	52.0	27.5	8.0	16.30	50
600286	EW M 50/M 63	M 50x1.5	M 63x1.5	65.0	31.0	9.0	12.15	25
EW PG PG/PG								
600500	EW PG 7/PG 9	PG 7	PG 9	17.0	15.0	3.0	0.68	100
600501	EW PG 9/PG 11	PG 9	PG 11	20.0	16.5	6.0	0.84	100
600502	EW PG 11/PG 13.5	PG 9	PG 13.5	22.0	17.5	6.0	1.02	100
600503	EW PG 11/PG 13.5	PG 11	PG 13.5	22.0	17.5	6.0	1.18	100
600504	EW PG 11/PG 16	PG 11	PG 16	24.0	18.5	6.0	1.30	100
600506	EW PG 13.5/PG 16	PG 13.5	PG 16	24.0	19.0	6.5	1.34	100
600507	EW PG 13.5/PG 21	PG 13.5	PG 12	30.0	21.0	6.5	2.15	50
600508	EW PG 16/PG 21	PG 16	PG 21	30.0	21.0	6.5	2.44	50
600510	EW PG 21/PG 29	PG 21	PG 29	39.0	23.0	7.0	3.60	50
600511	EW PG 29/PG 36	PG 29	PG 36	50.0	27.5	8.0	7.44	50
600512	EW PG 36/PG 42	PG 36	PG 42	57.0	31.0	9.0	9.20	10
600513	EW PG 42/PG 48	PG 42	PG 48	64.0	33.0	10.0	14.40	10

Cable fittings and accessories

Metal accessory blank plug BLMS

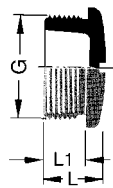

Properties

- Blank plug according to DIN 46320

Design

- Material Brass nickel-plated

Part-No.	Type	G	L mm	L 1 mm	weight approx. kg/100 piece	PU piece
BLMS metric						
600090	BLMS M 12	M 12×1.5	7.5	5.0	0.38	100
600091	BLMS M 16	M 16×1.5	8.0	6.0	0.55	100
600092	BLMS M 20	M 20×1.5	9.5	6.0	0.91	100
600093	BLMS M 25	M 25×1.5	11.0	7.0	1.56	100
600094	BLMS M 32	M 32×1.5	12.0	8.0	2.50	50
600095	BLMS M 40	M 40×1.5	13.0	8.0	3.96	50
600096	BLMS M 50	M 50×1.5	15.0	9.0	7.90	25
600097	BLMS M 63	M 63×1.5	16.0	10.0	10.19	10
BLMS metr. with O ring						
600201	BLMS M 12	M 12×1.5	7.5	5.0	0.32	100
600202	BLMS M 16	M 16×1.5	8.0	5.0	0.82	100
600203	BLMS M 20	M 20×1.5	9.5	6.0	0.87	100
600204	BLMS M 25	M 25×1.5	11.0	7.0	1.57	100
600205	BLMS M 32	M 32×1.5	12.0	8.0	2.42	50
600206	BLMS M 40	M 40×1.5	13.0	8.0	3.90	50
600207	BLMS M 50	M 50×1.5	15.0	9.0	7.25	25
600208	BLMS M 63	M 63×1.5	16.0	10.0	12.03	10
BLMS PG						
600590	BLMS PG 7	PG 7	8.0	5.0	0.34	100
600591	BLMS PG 9	PG 9	9.0	6.0	0.53	100
600592	BLMS PG 11	PG 11	9.0	6.0	0.73	100
600593	BLMS PG 13.5	PG 13.5	9.5	6.5	0.86	100
600594	BLMS PG 16	PG 16	9.5	6.5	1.13	100
600595	BLMS PG 21	PG 21	11.0	7.0	2.06	50
600596	BLMS PG 29	PG 29	12.0	8.0	3.78	25
600597	BLMS PG 36	PG 36	15.0	9.0	8.10	25